



SOLD

AWESOME LOWSET BRICK ON A CORNER BLOCK

Presenting to the market, a fabulous four bedroom low set brick home, accented by rough sawn timber cladding. This home exudes character.

The broad and welcoming verandah draws you into the home's large air-conditioned living area where wooden panelling adds texture and exposed rafters create interest while opening up the room.

Striking angles carry you through to the very functional modern kitchen, offering plenty of cupboard and bench space, electric cooktop wall mounted oven, dishwasher and more of fabulous exposed rafters.

The separate dining area opens out to a fantastic covered entertaining area, complete with a bar, helping to merge the interior and exterior spaces.

The master bedroom has private access to the entertaining area and is furnished with air-conditioning, ceiling fan and double robes. Bedrooms two and three are of a good size with ceiling fans and down lights, with bedroom two also offering a built-in robe. The converted fourth bedroom is very generous in size, making it perfect for a media room, play room or office space.

Built on 613m² block this charming home has plenty of space for the kids and the fur babies to play. There is a double lock up garage and new carpet throughout the home.

What a truly delightful home this is, and it won't last long in this market. So, make sure you call Lacey today to arrange a private inspection.

4 BED | 1 BATH | 0 CAR

PRICE:
\$395,000

OPEN FOR INSPECTION:
N/A



Lacey Roberts
0417785412
laceeroberts@atrealty.com.au
www.atrealty.com.au

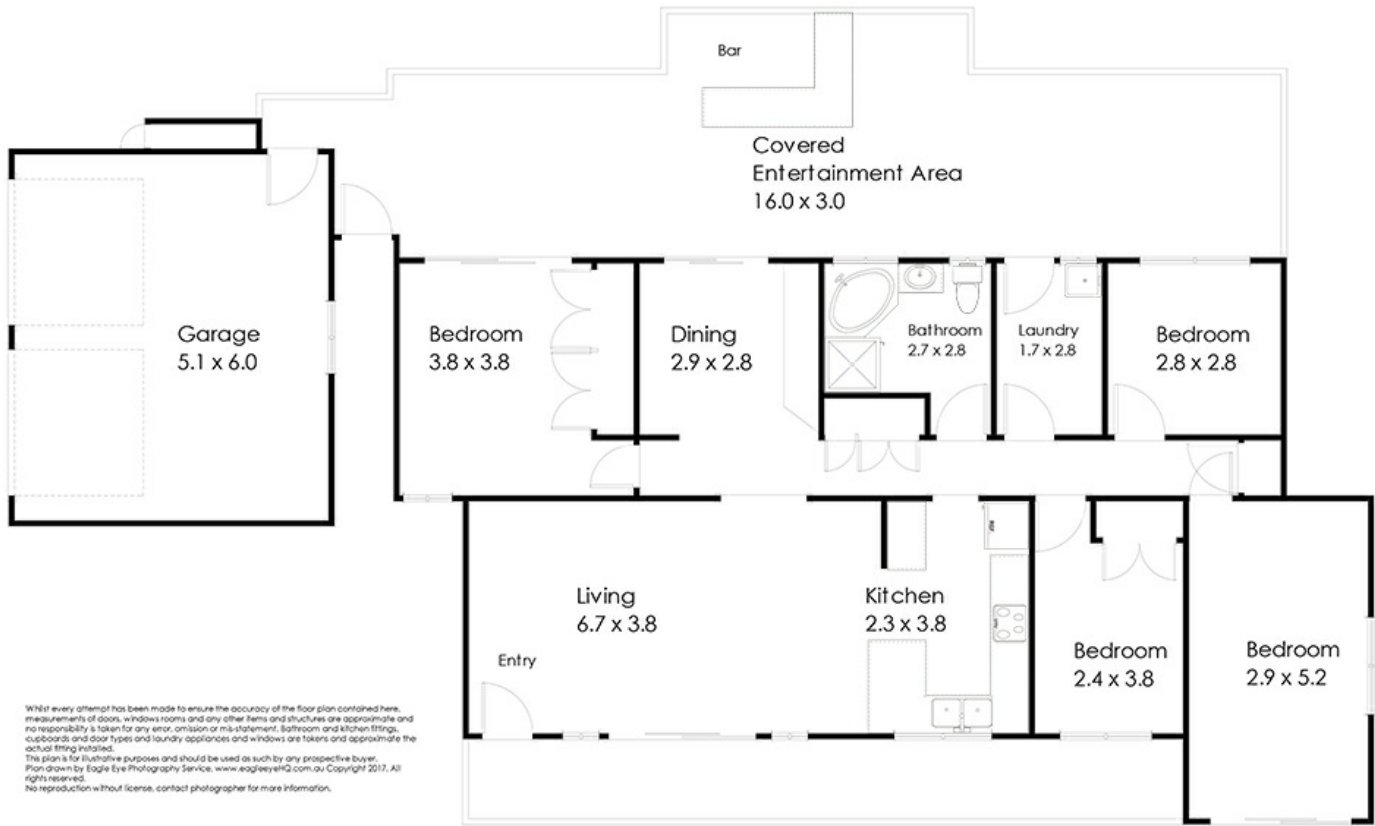

16 Chambery Road Petrie 4502



Disclaimer: Please note this floor plan is for marketing purposes and is to be used as a guide only. All dimensions are estimates only and may not be exact measurements.

Lacey Roberts
 0417785412
 laceeroberts@atrealty.com.au
www.atrealty.com.au

