



# SOLD

## PRICED TO SELL!

Presenting to the market a fabulous three bedroom home, located just 14 km from Brisbane City. If you are looking to get into the real estate market or hunting for an investment property in the much sought after suburb of Keperra, then you need to inspect this fantastic home.

This charming low set brick and tile offers a modern eat-in kitchen that opens out to a delightful covered entertaining area, which is just perfect for alfresco catch ups with friends and family. You will be spoilt for choice with two living spaces. Do you set up a formal lounge area, maybe a home office or a rumpus room? The family room offers private access to the front of the home on one side while opening out to a private courtyard area from the other.

The master bedroom is of a generous size with a free standing robe and air-conditioning, bedroom two is sizeable and offers a built-in robe extending the entire length of one wall, all three rooms have ceiling fans. The bathroom consists of a freestanding bath and shower, a good sized laundry and a separate toilet.

The back yard is fully fenced with a fabulous grassy area for the kids and fur babies to run and play. Located to the rear of the property is covered, built-in storage space. However, it would be possible to reclaim this area if more yard is required.

Additional features include a 7.1 kW air-conditioning unit servicing the main living areas of the home, solar hot-water system, 3 kW of solar panels with a 5 kW inverter, tank, garden shed and security screens and doors.

This home offers the best of both worlds, it is ideally located for a quick city commute during the week, and lovely country drives on the weekends.

This one won't last long, call Lacey today to discuss inspecting.

3 BED | 1 BATH | 2 CAR

PRICE:  
\$510,000

OPEN FOR INSPECTION:  
N/A



**Lacey Roberts**  
0417785412  
laceeroberts@atrealty.com.au  
[www.atrealty.com.au](http://www.atrealty.com.au)

Whilst every attempt has been made to ensure the accuracy of the floor plan contained here, measurements of doors, windows rooms and any other items and structures are approximate and no responsibility is taken for any error, omission or misstatement. Bathrooms and kitchen fittings, cupboards and door types and laundry appliances and windows are taken and approximate the actual fitting installed.  
This plan is for illustrative purposes and should be used as such by any prospective buyer.  
Plan drawn by Eagle Eye Photography Service, www.eagleeyeHQ.com.au Copyright 2017. All rights reserved.  
No reproduction without license, contact photographer for more information.

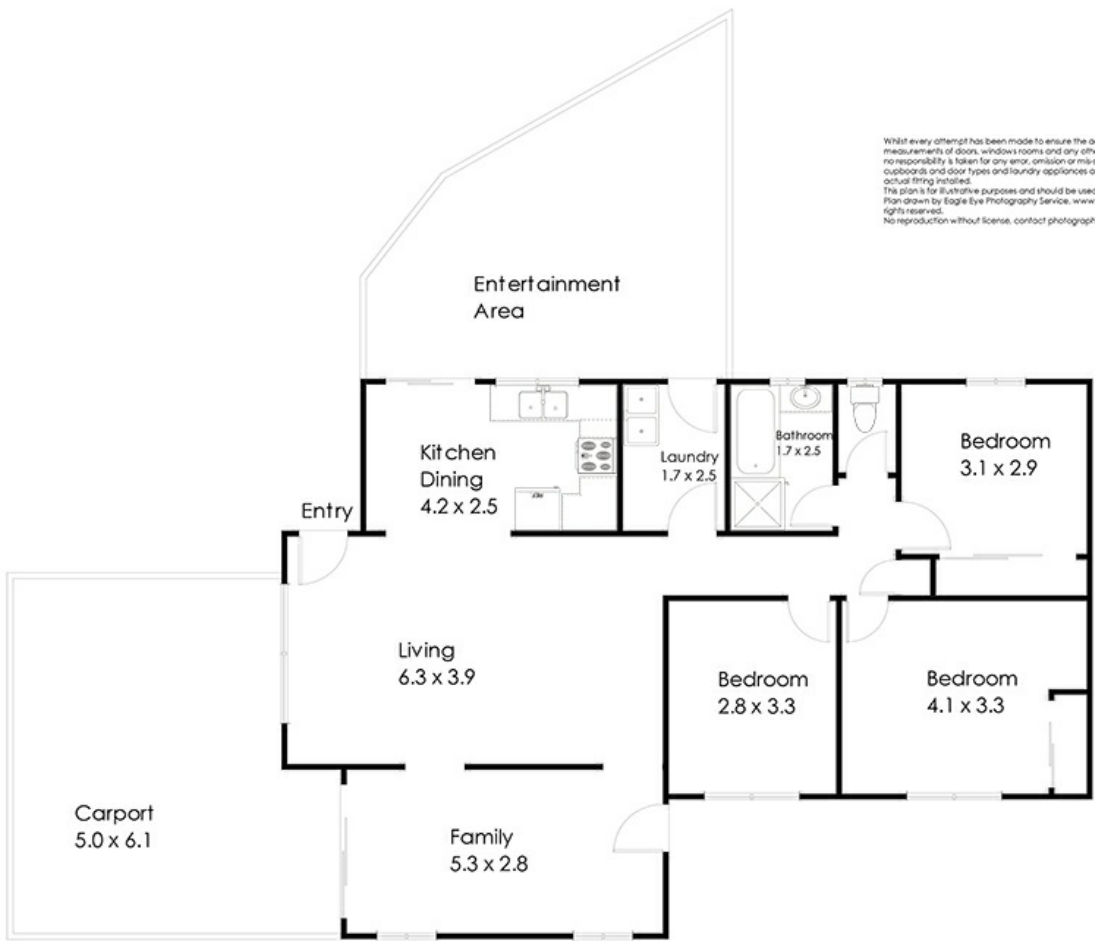

16 Moraby Street Keperra 4054

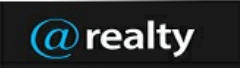

Disclaimer: Please note this floor plan is for marketing purposes and is to be used as a guide only. All dimensions are estimates only and may not be exact measurements.

Lacey Roberts  
0417785412  
laceeroberts@atrealty.com.au  
[www.atrealty.com.au](http://www.atrealty.com.au)

