

SOLD

EXECUTIVE LIVING IN ULTRA CONVENIENT LOCATION

Luxuriously appointed with high end fixtures and finishes, this sophisticated executive style residence makes living easy with crisp clean lines and a seamless indoor-outdoor connection. Set within meters of the esteemed Cheltenham Secondary College, this stylish home is graced by high ceilings and stunning floorboards flowing throughout the open plan kitchen, dining and living zone, boasting stone benches, soft close drawers plus Bosch stainless steel appliances and dishwasher. Double sliding doors merging the indoors with a sundrenched, north facing entertaining deck and landscaped garden. While a downstairs powder room offers convenience for every day living. On the upper level, high ceiling continue and are accompanied by the comfort of carpet, with the three robed bedrooms, including the indulgent master with walk-in-robe, ensuite featuring a double shower and double vanity plus balcony, supplemented by a family bathroom with toilet and Euro laundry. All this and in a location that offers outstanding convenience, moments from Cheltenham Secondary College, Le Page Primary, Cheltenham East Primary, Kingston Heath Primary, Southland Shopping Centre, DFO, buses, trains, Kingston Heath Golf Club and reserves.

3 BED | 2 BATH | 0 CAR

PRICE:
\$770,000

OPEN FOR INSPECTION:
N/A



Sam Zhang
0412898488
samzhang@atrealty.com.au
www.atrealty.com.au

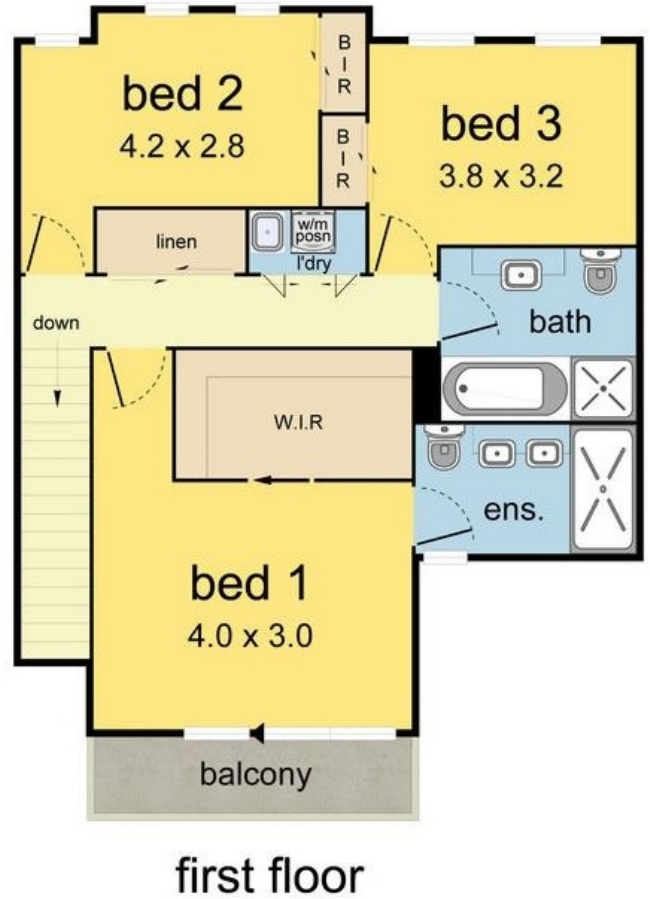
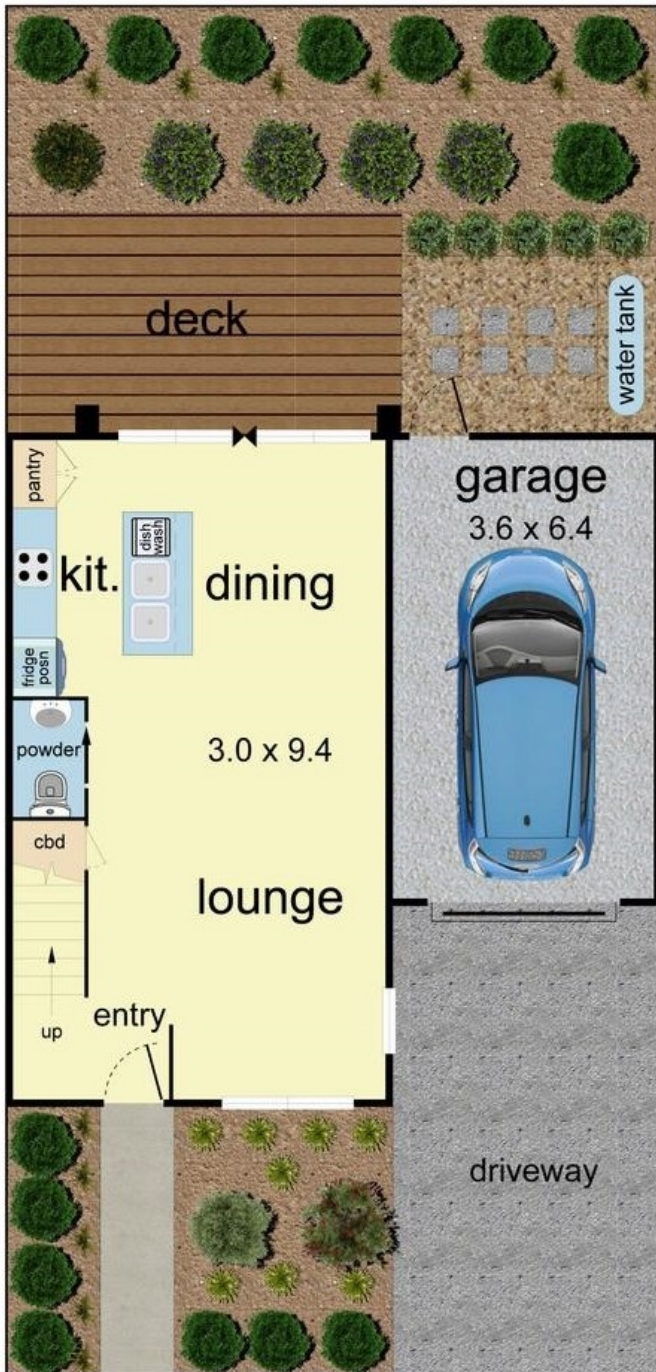

Disclaimer: Please note this floor plan is for marketing purposes and is to be used as a guide only. All dimensions are estimates only and may not be exact measurements.