



SOLD

**GREAT LOCATION ! GREAT REAR GARDEN !
GREAT VALUE !**

- * Opportunity to purchase secluded & private unit in small group.
- * Close to K-Mart , Oakden , Northgate and unlt approx 20 minutes drive to city.
- * Easy walking distance to parks and transport is right on your doorstep.
- * Two good sized bedrooms with built-in robe to main bedroom.
- * Modern light and bright kitchen.
- * Updated bathroom.
- * Spacious living area with split system air conditioning. & linen cupboard.
- * HUGE PRIVATE REAR GARDEN with tons of space for pergola, spa, sheds & vegie patch.
- * Carport at rear of group.
- * Fantastic Investment or 1st home !
- * Call Terry Webster on 0419 993 357 (Your Local Adelaide North East Agent)

2 BED | 1 BATH | 1 CAR

PRICE:
\$205,000

OPEN FOR INSPECTION:
N/A



Terry Webster
0419993357
terrywebster@atrealty.com.au
www.atrealty.com.au
RLA: 269823

4, 38 Walkleys Road VALLEY VIEW

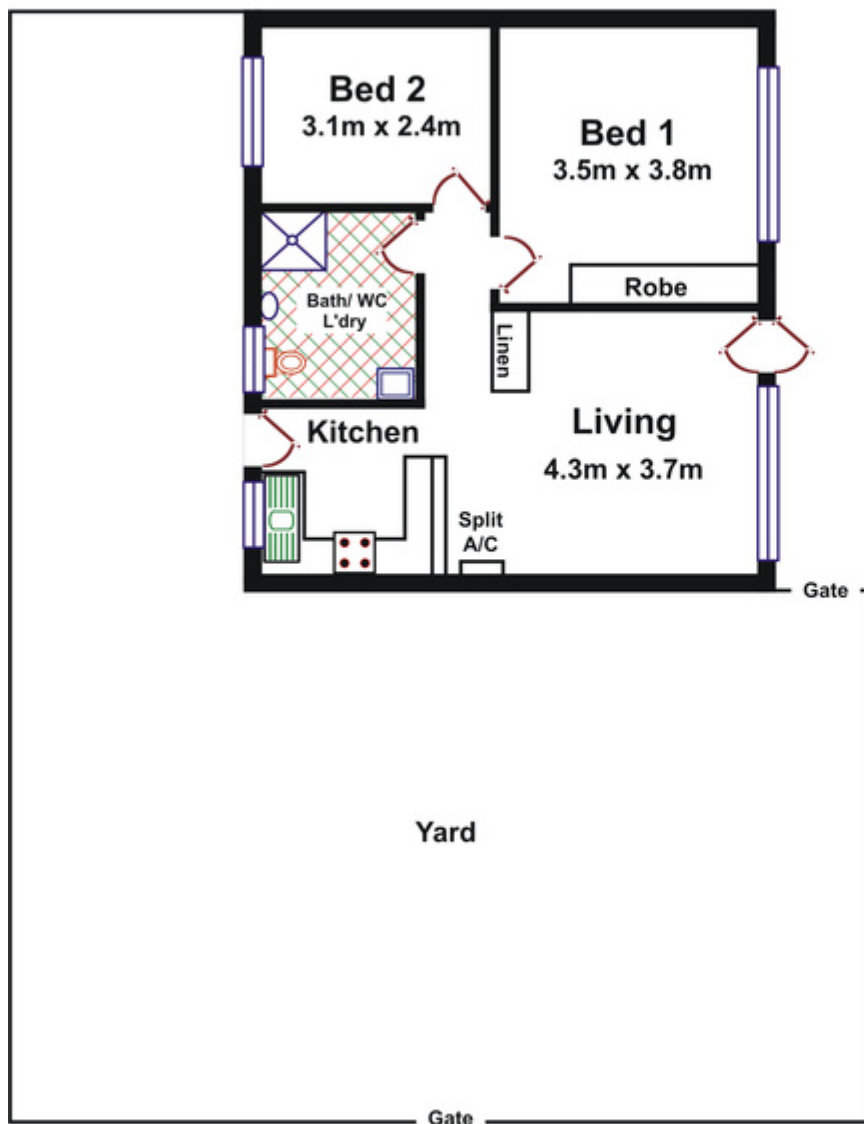

Please Note: Every care has been taken to verify the correctness of the areas and details used in this leaflet. No warranty or representation is given or made as to the correctness of the information supplied and neither the owners, illustrator nor the Agent accept responsibility for errors or omissions. The sketch is for illustration purposes only and intending purchasers should satisfy themselves independently regarding sizes, layout and location of the property. Please check with local council that all structures are approved by council.

Disclaimer: Please note this floor plan is for marketing purposes and is to be used as a guide only. All dimensions are estimates only and may not be exact measurements.