



SOLD

ONLY A STONES THROW FROM THE RIVER!

What a fantastic location! This townhouse style accommodation is in a very highly sought after Noosa destination resort.

Fully furnished and fully refurbished, ready to move in or as an investment property for holiday letting.

Great location overlooking the resort style pool. Watch the children playing in the pool from your front terrace while enjoying a glass of your favourite beverage.

Timber floors throughout the open plan living and dining has a lovely flow and feel to the space. Ceiling fans throughout as well as air-conditioning to keep you cool on those hot summer days.

The recently renovated dream kitchen with soft close drawers and doors, stunning stone bench top, and new appliances is a pleasure to create your favourite meals in.

The carpeted stairs lead up to the bedrooms and beautifully renovated laundry/bathroom. The main bedroom is expansive, light filled with a large picture window revealing a wide view across the pool. Twin single beds in the second bedroom create room for the whole family.

This is a great investment property, a fantastic holiday home the children will enjoy and only a few minute stroll to the beautiful Noosa River, Sandy Beaches, Cafes, Boutiques and Leisure.

- Resort pool, carport, use of tennis court
- Fully Renovated & furnished a short stroll to Noosa River
- Ground floor open plan living, dining, terrace

2 BED | 1 BATH | 1 CAR

PRICE:
\$355,000

OPEN FOR INSPECTION:
N/A



Karen Hardcastle
0416143952
karenh@atrealty.com.au
www.atrealty.com.au

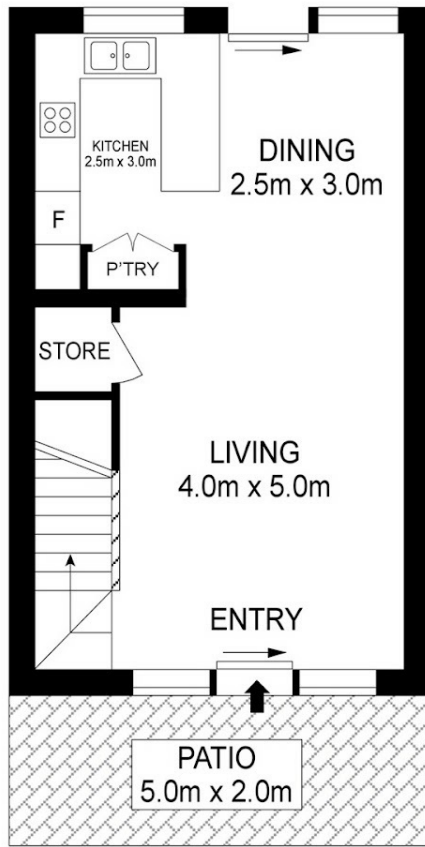

GROUND FLOOR



Scale in metres. Indicative only. Dimensions are approximate. All information contained herein is gathered from sources we believe to be reliable. However, we cannot guarantee its accuracy and interested persons should rely on their own enquiries.

19/272 Weyba Road, Noosaville

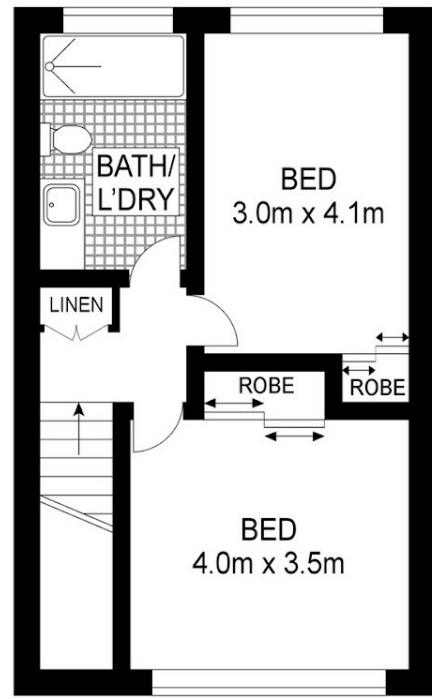

FIRST FLOOR



INT: 84 m²
EXT: 11 m²



Disclaimer: Please note this floor plan is for marketing purposes and is to be used as a guide only. All dimensions are estimates only and may not be exact measurements.

Karen Hardcastle
0416143952
karenh@atrealty.com.au
www.atrealty.com.au

