



## FOR SALE

### ATTENTION ! 1ST HOME BUYERS ! INVESTORS ! DEVELOPERS !

- \* Great handy location walking distance to Tea Tree Plaza, O'Bahn, Modbury Hospital and all facilities.
- \* A very neat and tidy home comprising,
- \* Large formal lounge with combustion heater.
- \* Spacious kitchen/dine with sliding door leading out to pergola area.
- \* Four good sized bedrooms.
- \* Ducted air conditioning throughout the home.
- \* Outside we have a large verandah, pergola, big garage/workshop.
- \* Double length carport plus two drives.
- \* Large approx 800 sqm allotment with possibility to develop STCC.

4 BED | 1 BATH | 2 CAR

**PRICE:**

\$355,000 - \$375,000

**OPEN FOR INSPECTION:**

N/A



**Terry Webster**

**0419993357**

[terrywebster@atrealty.com.au](mailto:terrywebster@atrealty.com.au)

[www.atrealty.com.au](http://www.atrealty.com.au)

RLA: 269823

## 6 Bank Crescent St AGNES

Area	M <sup>2</sup>
Living	112.33
Carport	42.12
Verandah	37.56
Total Approx	192.01

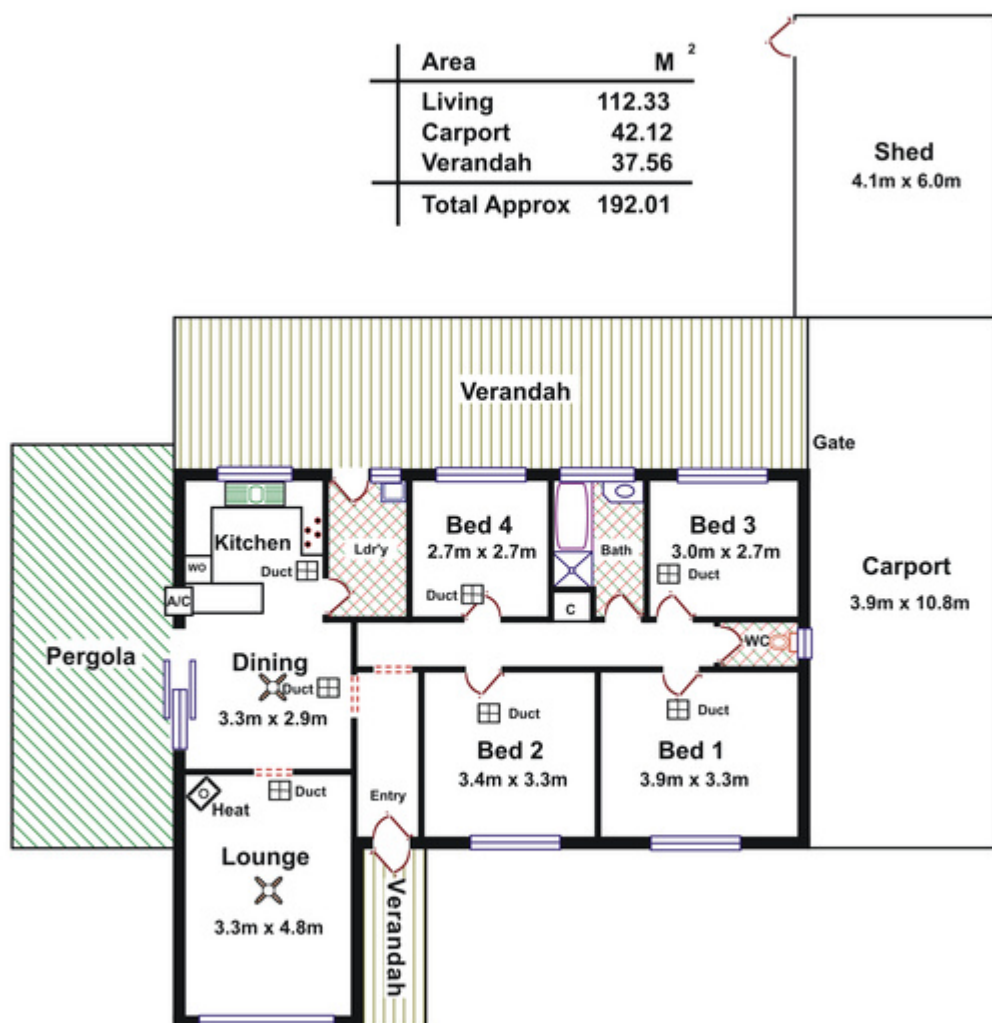

Please Note: Every care has been taken to verify the correctness of the areas and details used in this leaflet. No warranty or representation is given or made as to the correctness of the information supplied and neither the owners, illustrator nor the Agent accept responsibility for errors or omissions. The sketch is for illustration purposes only and intending purchasers should satisfy themselves independently regarding sizes, layout and location of the property. Please check with local council that all structures are approved by council.

Disclaimer: Please note this floor plan is for marketing purposes and is to be used as a guide only. All dimensions are estimates only and may not be exact measurements.