



# FOR SALE

## TOO GOOD TO BE TRUE !! LOOK AT THE RETURN

### PRIVATELY APPOINTED DUPLEX

This pristine 2 bedroom, 2 bathroom duplex is on street level and is very spacious. The light filled master bedroom with ensuite and private tiled sunroom has a claw foot bath with views. The open plan kitchen has European appliances, lots of cupboards and bench space which is perfect for entertaining. With a large deck, you can sit and enjoy the views to Coolangatta and Surfers Paradise. Down a few stairs from the decking you can step into your spacious man cave/ storage area or games room.

#### KEY FEATURES:

- 2 large bedrooms
- Master with built in robes, ensuite and enclosed verandah
- Open plan kitchen/dining and Lounge
- Separate laundry
- Separate toilet
- Undercover decking
- Separate lower level storage room
- Lock up garage with remote
- Large rear yard

#### ADDITIONAL FEATURES:

- Dishwasher
- Large space for fridge
- Floating floor boards in both bedrooms
- 1.5 kw Solar panels
- Solar hot water
- Built in Robes in bedrooms
- Split air conditioner
- Garden Shed

2 BED | 2 BATH | 0 CAR

#### PRICE:

Contact Agent

#### OPEN FOR INSPECTION:

N/A



**Sharon Smythe**

**0412195500**

sharonsmythe@atrealty.com.au

[smytheproperties.com.au](http://smytheproperties.com.au)

# 1-31 Oyster Point Road, Banora Point

Total Approximate Floor Area  
228 sqm

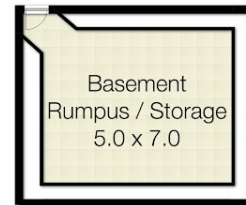

Whilst every attempt has been made to ensure the accuracy of the floor plan. Measurements of doors, windows rooms and any other items are approximate and no responsibility is taken for any error, omission or misstatement. This plan is for illustrative purposes only and should be used as such by any prospective purchaser.

Disclaimer: Please note this floor plan is for marketing purposes and is to be used as a guide only. All dimensions are estimates only and may not be exact measurements.