



FOR SALE

UNDER OFFER

If secure, convenient, low maintenance and quality are words in your current search criteria, then be sure to put this property on your inspection list.

Located in the private secure enclave of the Coomera Waters Estate, this low maintenance 4 x bedroom family home, offers a peaceful and convenient lifestyle in the highly sought after northern end of the Gold Coast.

This thoughtfully designed home features dual separate living areas both flowing to outdoor entertaining courtyards. Central to the home is the modern kitchen with stone bench tops and stainless steel appliances flowing through to a third living space ideal as a casual dining area.

The bedrooms are quietly located at the rear of the property, and all include large robes, ceiling fans and ducted air-conditioning for year round comfort.

The large master suite offers a private escape with courtyard access, a dual access walk through wardrobe, and a well appointed ensuite with double vanities and spa bath.

The executive office (or 4th bedroom) is cleverly positioned at the front of the home and enjoys a separate entry, offering an ideal work from home opportunity.

Decorated in classic neutral colour tones with low maintenance tropical gardens, this private home on 714m2 includes access to the Estate's exclusive recreation centre with use of the floodlit tennis courts, pools, gym and BBQ entertaining area.

Located in the fastest growing region of the Gold Coast, and with low body corporate and high rental yields this property presents as a sound investment opportunity for either the owner occupier or astute investor.

Quality features include:

4 x bedrooms all with built in robes
2 x bathrooms plus additional powder room
714m2* block in the secure Coomera Waters Estate
Low maintenance tropical gardens

4 BED | 2 BATH | 0 CAR

PRICE:
OFFERS OVER \$567,500 - OWNER
SAYS SELL

OPEN FOR INSPECTION:
N/A



Scott Euler
0431174010
scott.nicola@atrealty.com.au

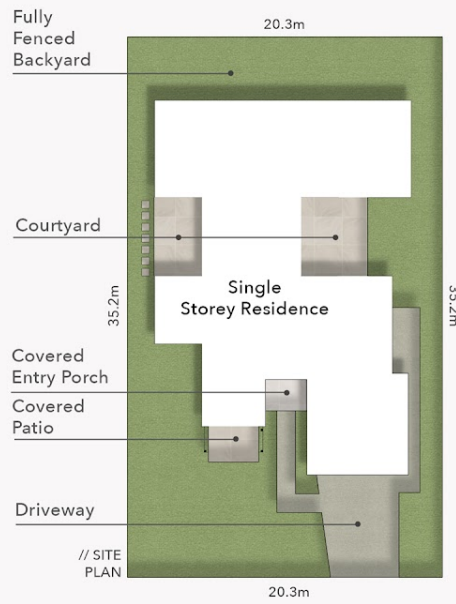

RAINBOW CIRCUIT

18 Rainbow Circuit
COOMERA WATERS
Block Size 714m²

- 4 Bed
- 2 Bath + Powder Room
- 2 Car

FLOOR AREA SIZES
Internal 279m²
Porch & Patios 39m²
Total 318m² or 34 Squares

Pure Design Concepts accepts no ownership or authorship of the above design. Drawings are an interpretation only for the benefit of marketing purposes. All measurements are approximate & individuals should rely on their own information. Find out more at: puredesignconcepts.com.au

puredesign
CONCEPTS

Disclaimer: Please note this floor plan is for marketing purposes and is to be used as a guide only. All dimensions are estimates only and may not be exact measurements.