

SOLD

A TRUE FOUR BEDROOM HOME WITH A HUGE MASTER BEDROOM.

If you crave the quiet life at the end of one of Tewantin's better cul-de-sacs then this is the home for you.

Inside, apart from the four big bedrooms, you have formal living plus an open plan kitchen, dining and family room area.

Outside, although the yard is not huge, there is still room for a pool, if needed, with enough space out the front to park the caravan or boat.

AGENTS NOTE This is a home most of us could just move in and enjoy because a lot of the often forgotten things are already in place.

DEADLINE SALE closes 4.00pm Friday 16th February, 2018.
THE VENDOR RESERVES THE RIGHT TO ACCEPT AN OFFER AND SELL PRIOR TO THE DEADLINE SALE DATE.

WHAT IS A DEADLINE SALE?

A deadline sale is similar to the tender process. A property is offered for sale with no fixed price. Prospective purchasers are required to submit their offer by a deadline date. Unlike the tender process, the vendor reserves the right to accept an offer and sell prior to the deadline sale date.

4 BED | 2 BATH | 0 CAR

PRICE:
\$560,000

OPEN FOR INSPECTION:
N/A



Tony WATSON
0403180828
tony.watson@atrealty.com.au
www.atrealty.com.au

6 scale 1:100

AREAS:

Floor = 202.14 m²

Court = 8.11 m²

TOTAL = 210.25 m²

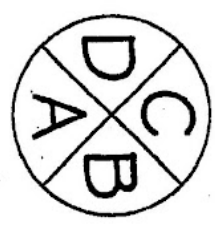

- NOTES:
1. ALL CONSTRUCTION TO BE IN ACCORDANCE WITH THE AUSTRALIAN DOMESTIC CONSTRUCTION MANUAL.
 2. EXPOSED WOOD FINISHES - W41.
 3. ALL TIMBER FINISHES TO BE IN ACCORDANCE WITH TRADE-GRAD TIMBER FINISHES MANUAL - W41.
 4. FINE FINISHES TO BE W41, STRESS GRADE F14 & W41.
 5. JOINT GROUP J24.
 6. JOINT GROUP J2.
 7. TRUCKER FOR TRUCKS TO BE W41, JOINT GROUP J24.
 8. W.C. DOORS OTHER FINISHES TO BE FITTED WITH LIFT-OFF HANDLES & BE FITTED TO ALLOW THE DOOR TO BE REMOVED WHEN IN CLOSED POSITION.
 9. TRUCKS TO BE FINED IN ACCORDANCE WITH W41.
 10. ALL OTHER FINISHES TO BE IN ACCORDANCE WITH THE W41 TRADE-GRAD MANUAL.
 11. UNPAINTED BRASS SIZES BASED ON TRADE-GRAD BRASS TABLES, WHERE OTHER BRASSES ARE USED, SIZES TO BE COMPARED WITH W41.
 12. ALL DIMENSIONS THAT EXCEED OVER SCALE.
 13. BLINDS & TRAVELERS ARE TO COMPLY ALL APPOINTMENTS, DETAILS & SPECIFICATIONS FROM TO SET-OFF & ORDERING OF MATERIALS.
 14. ANY ERRORS ARE TO BE ADVISED TO THE DESIGNER AS NO RESPONSIBILITY WILL BE TAKEN AFTER CONSTRUCTION HAS COMMENCED.
 15. ALL TRAVELERS ARE TO COMPLY WITH THE CURRENT AUSTRALIAN STANDARDS RELATING TO THEIR WORK.
- NOTE:
- ALL WET AREAS TO BE IN ACCORDANCE WITH THE AUSTRALIAN DOMESTIC CONSTRUCTION MANUAL. NOTE TO CLIENT:
- PROOF & SIGNING MACHINE SUFFICIENT BY OWNER.

● - Smoke alarms to comply with AS-3786

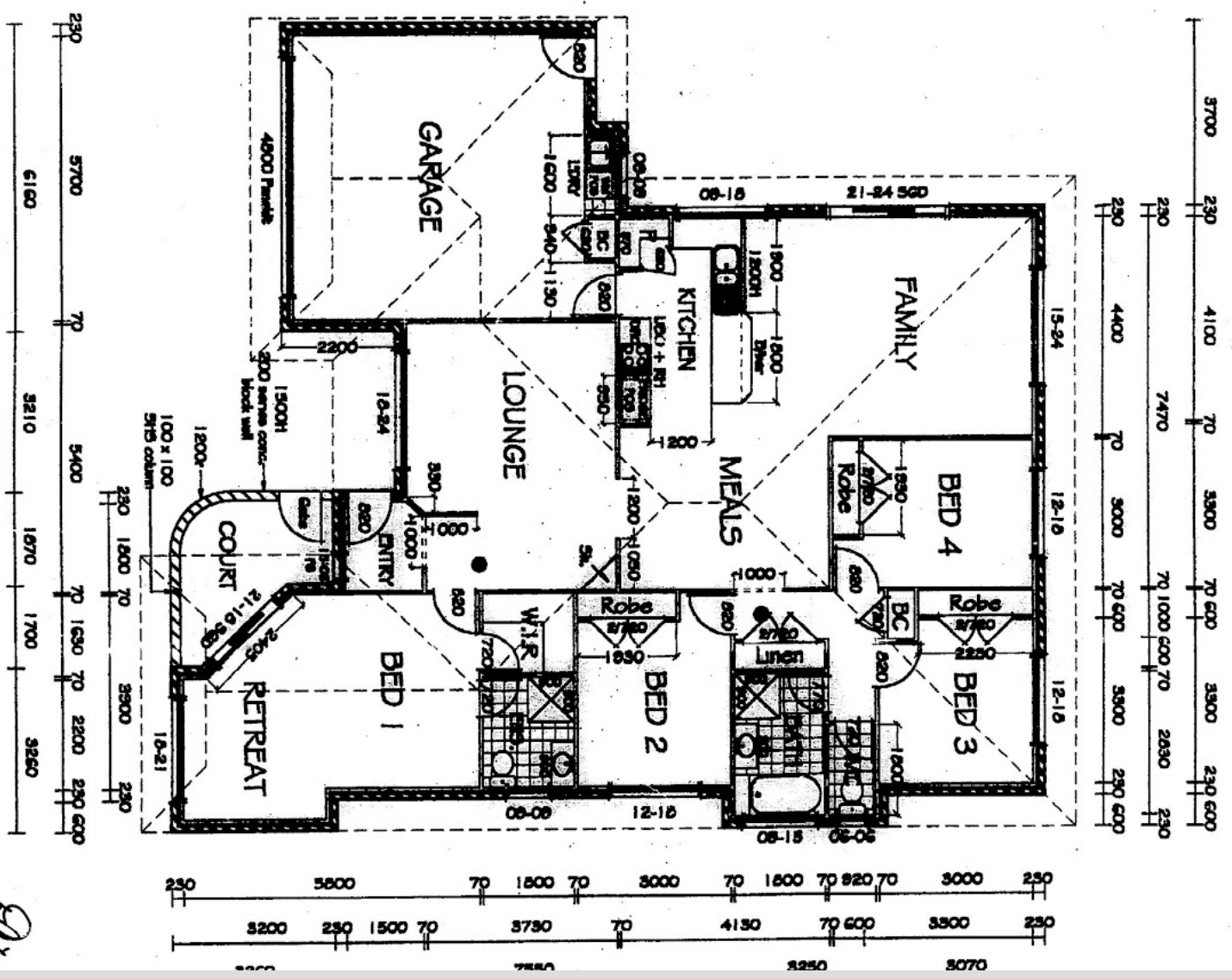
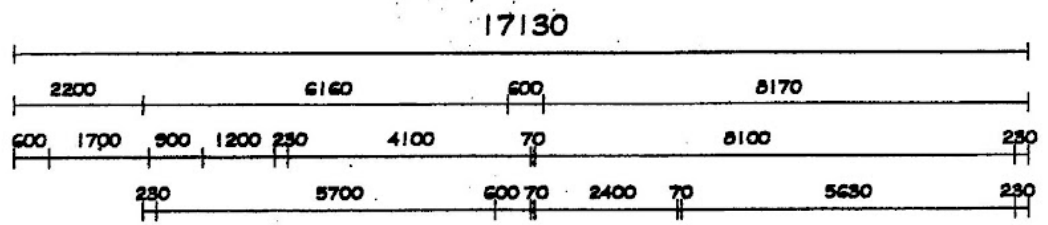

Disclaimer: Please note this floor plan is for marketing purposes and is to be used as a guide only. All dimensions are estimates only and may not be exact measurements.

Location: Lot 80 Sun Street Woosah QLD
Project: Proposed Cypress
Details: Floor Plan
Date: Set
Dwg. No.:
Scale: 1:100
Designed: Paper Size
Drawn: G.
Approved:
Builder: BSA #:
ATS: 0403180828
tony.watson@atrealty.com.au
www.atrealty.com.au