



SOLD

IMPRESSIVE FAMILY HOME

PLEASURE TO OFFER THIS IMMACULATE FAMILY HOME, ORIGINALLY BUILT AS A DISPLAY HOME. YOU HAVE THE UNDERSTANDING AS SOON AS YOU WALK THROUGH ITS FRONT DOOR, THAT THIS HOME IS THAT BIT SPECIAL. YOUR FIRST IMPRESSIONS ARE SPACE, QUALITY AND CLASS, PLUS HIGH CEILINGS AND BEAUTIFUL COLOUR CO-ORDINATION THROUGHOUT THE HOME. THE HOME CONSISTS OF 2 LARGE LIVING AREAS, FORMAL LOUNGE OR THEATER ROOM PLUS A LARGE OPEN KITCHEN MEALS FAMILY ROOM, COMPLEMENTED BY CLASSIC MODERN KITCHEN WITH DISHWASHER BREAKFAST BENCH AND HEAPS OF CUPBOARD SPACE. THE ENTIRE HOME IS KEPT THE RIGHT TEMPERATURE ALL YEAR ROUND WITH DUCT ED HEATING AND COOLING. 4 SPACIOUS BEDROOMS 3 WITH BUILT IN ROBES, WITH THE MAIN HAVING LARGE WIR AND EN-SUITE INCLUDING A DOUBLE SHOWER. ALL WET AREAS ARE BEAUTIFULLY TILED AND FINISHED. SLIDING DOOR FROM THE FAMILY ROOM LEADS TO A LARGE UNDERCOVER ENTERTAINING AREA AND BEAUTIFUL YARD, SECURE AND IDEAL KIDS AND PETS. DOUBLE GARAGE UNDER THE MAIN ROOF HAS REMOTE DOORS AND INSIDE ACCESS, PLUS A SEPARATE COLOUR BOND GARAGE, IDEAL AS A WORKSHOP OR MORE VEHICLE STORAGE. LIKE NEW THIS HOME EVERYTHING YOU COULD WANT IN A FAMILY. INSPECTION RECOMMENDED

4 BED | 2 BATH | 0 CAR

PRICE:
\$419,500

OPEN FOR INSPECTION:
N/A



Peter Dempsey
0418854393
peterdempsey@atrealty.com.au
peterdempseyatrealty.com
RLA: 269823

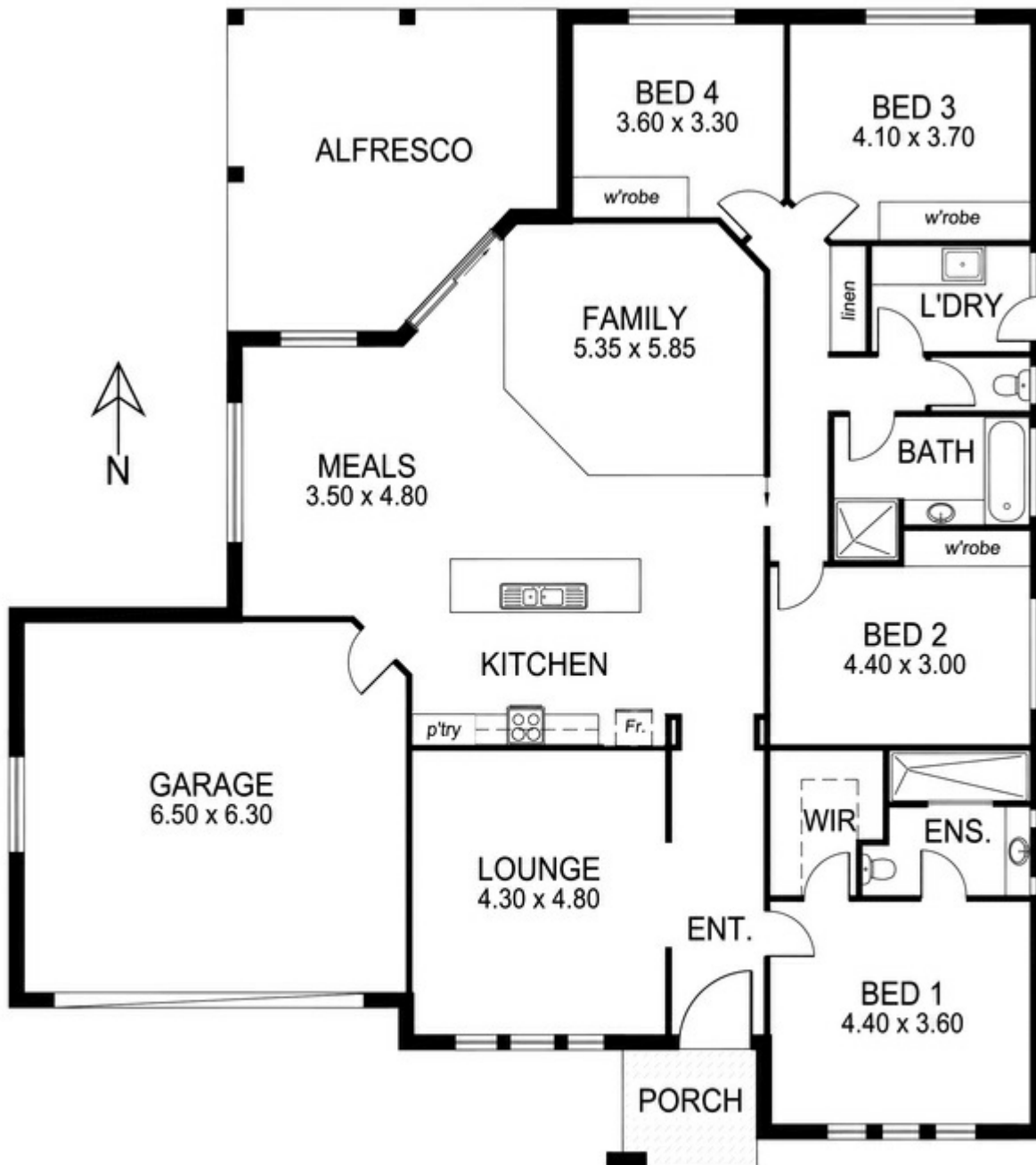

This drawing is for illustration purposes only.
 All measurements are approximate only and information
 intended to be relied upon should be independently verified.

Disclaimer: Please note this floor plan is for marketing purposes and is to be used as a guide only. All dimensions are estimates only and may not be exact measurements.