



FOR SALE

MAJOR DEVELOPMENT OPPORTUNITY

- * TOTAL LAND AREA - approximately 265,500m² or 26.55ha (64 acres)
 - * Consists of 4 Titles - 10.2ha - 10.5ha - 4.95ha - 9074m²
 - * IMPROVEMENTS:
 - * Implement Shed 37m x 10m
 - * Lock up GI Shed 12.5m x 8m with 2m x 2.4m cool room
 - * 2 Bores - 1 Electric - 1 Diesel driven
 - * GI Shed 9m x 6m and lean to 9m x 6m with c/c floors and spillage bunting
 - * Office and staff amenities (Basic)
 - * Single GI Shed 5m x 3m
 - * 5 Roomed stone home and out buildings
 - * Fire Water Tank - mounted
- BEING OFFERED AS A WHOLE OR PER TITLE - IF BY TITLE, BOUNDARY CHANGES MAY BE NEGOTIATED
- HUGE OPPORTUNITY TO PURCHASE AS A WHOLE AND SUBDIVIDE THIS RARE CITY GENERAL INDUSTRY LAND (Subject to normal Council and Statutory approvals)
- EXPRESSION OF INTEREST CLOSES TUESDAY 24th OCTOBER 2017 at 5pm
- CONTACT - Allen Smith 0419 869 854 email: allen.smith@atrealty.com.au
- In Conjunction with Herbert Real Estate

0 BED | 0 BATH | 0 CAR

PRICE:
\$3,850,000

OPEN FOR INSPECTION:
N/A



Allen Smith
0419869854
allen.smith@atrealty.com.au
www.atrealty.com.au
RLA: 269823

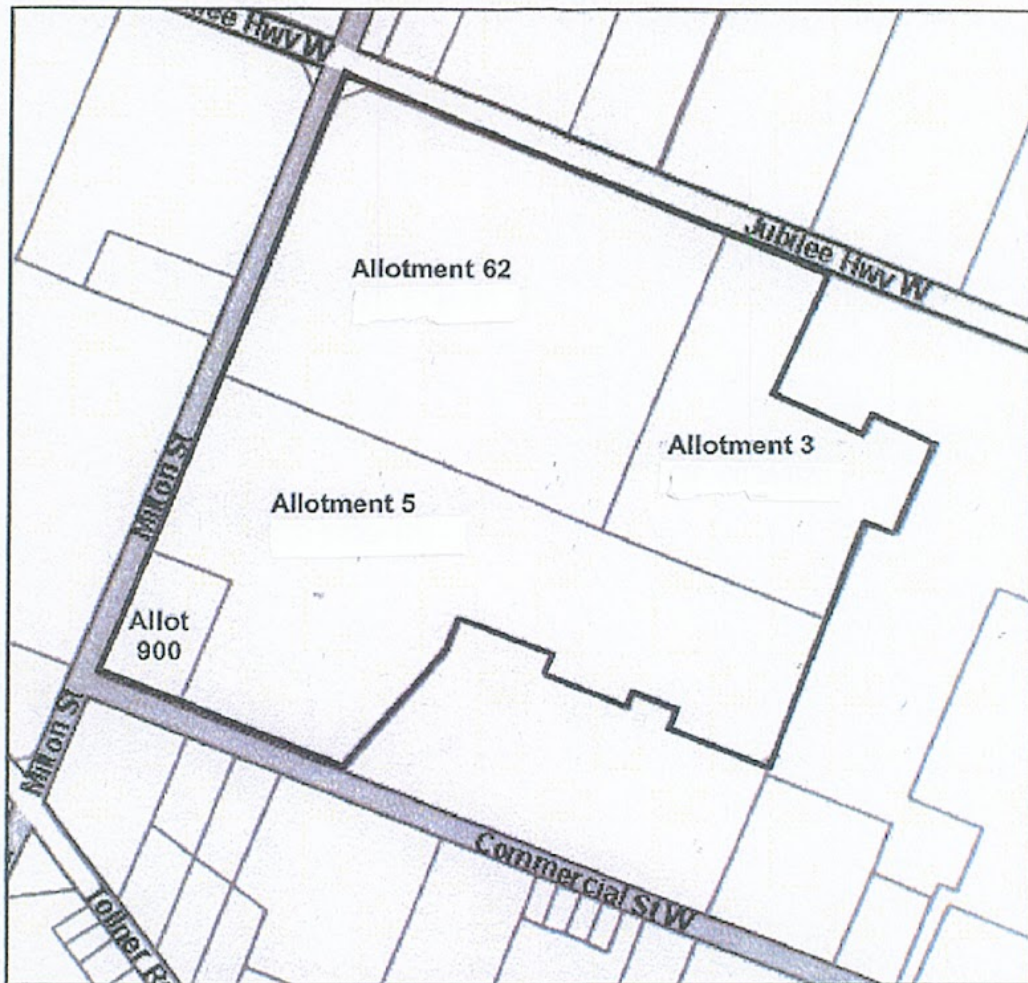

Disclaimer: Please note this floor plan is for marketing purposes and is to be used as a guide only. All dimensions are estimates only and may not be exact measurements.