

29-31 THOMAS STREET YANKALILLA

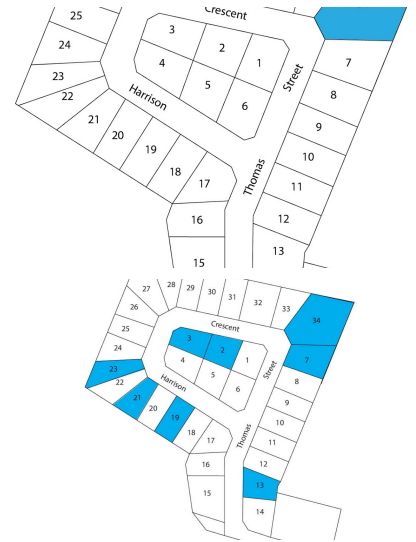

FOR SALE

NEW RESIDENTIAL DEVELOPMENT - ALL REASONABLE OFFERS CONSIDERED

Local @realty agent Shane Magor, proudly presents the Yankalilla Grove Development For Sale. Please contact agent on 0400 254 933 should you have an interest in this property.

Situated in the centre of the picturesque town of Yankalilla, this tree lined residential development is arguably the most affordable residential land release on the beautiful Fleurieu Peninsula with allotment size ranging from 560m² to 1574m².

Close to the beautiful Normanville and Carrickalinga beaches, Yankalilla offers all the attractions of a quiet country town with fabulous views across the valley with local shops, banks, hotel and sporting facilities at the Yankalilla Memorial Park only a short walk.

Whether you are looking for a lifestyle change, retreat from the hustle and bustle of the city, these affordable residential allotments all come with great potential at an affordable price.

0 BED | 0 BATH | 0 CAR

PRICE:
\$167,000

OPEN FOR INSPECTION:
N/A



Shane Magor
0400254933
shanemagor@atrealty.com.au
www.bluedoorproperty.com.au
RLA: 269823