



FOR SALE

ANOTHER SOLD BY GEOFF TUTT

This is a gorgeous architecturally designed home built in 2010 by Mark Wust on a 999 sqm block and located only a short boat ride to the deep waters of the Pumicestone Passage. A great feature of this property is the wide side access to the side of the home allowing for a caravan, boat or trailer to be housed.

The home features open plan living/dining/kitchen, media room, multi-function room, four good size bedrooms, two bathrooms and a three car garage. Plenty of room for friends and family to enjoy.

In the kitchen there are Caesar stone bench tops, a large butler's pantry complete with double sinks and lots of cupboard space. The master bedroom has a large en-suite with spa bath, double vanity and walk behind wardrobe and is situated at the rear of the home.

Leading out from the open plan living area you will find a huge undercover entertainment area overlooking landscaped gardens to the water. The gardens have been terraced with beautiful sandstone blocks and lovingly landscaped by the current owners. A great place for entertaining family and friends. Look at these additional features:

- Zoned and ducted air-conditioning and ceiling fans
- Heat pump
- Pontoon with electricity and water
- Side Access
- Lots of storage
- Water tank

This is a beautiful quality home and must be seen to appreciate all that it has to offer. Don't miss out, give Geoff (your local agent) a call on 0414 230 130 now to arrange your private inspection.

4 BED | 2 BATH | 3 CAR

PRICE:
SOLD BY GEOFF TUTT

OPEN FOR INSPECTION:
N/A



Geoff and Rose Tutt
0414230130
geoff@atrealty.com.au
www.atrealty.com.au

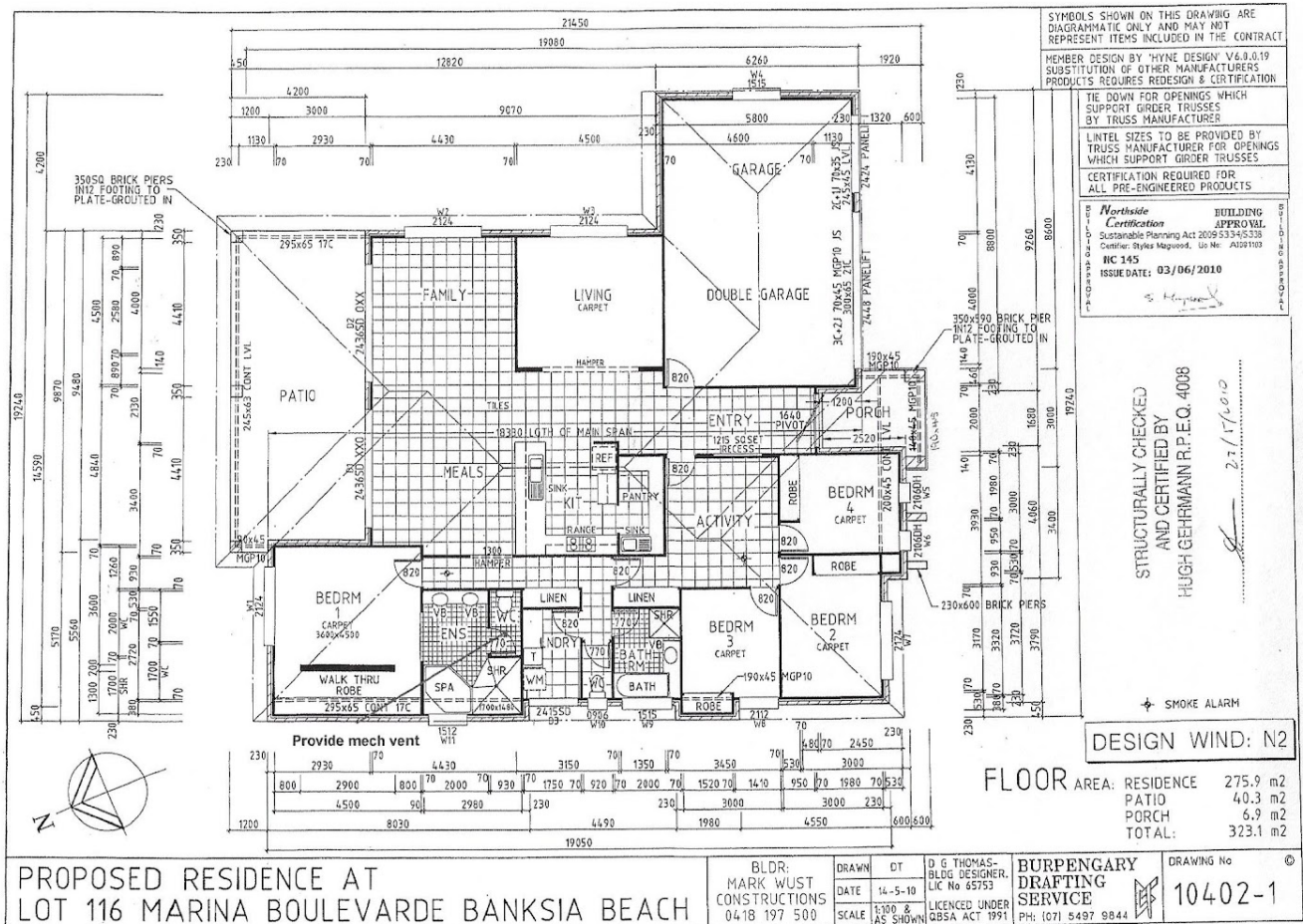

Disclaimer: Please note this floor plan is for marketing purposes and is to be used as a guide only. All dimensions are estimates only and may not be exact measurements.