



FOR SALE

BRAND SPARKLING NEW!!

Just completed is this Stunning new home on a easy care 455m2 allotment, ready to move in for very comfortable living! Positioned in a quiet area, park & playground across the road & surrounded by other new dwellings. Built by GJ Gardner homes, this home features high ceilings, spacious rooms and an expansive open living area.

The 2 front bedrooms offer built in robes, carpeting & window blinds. The master bedroom is located at the rear, distanced from the others, just perfect for quiet time away from the kids plus added privacy. This is a very spacious room featuring a large 'Hollywood Robe' great for both his & hers & more of hers! Follow through into a beautiful ensuite bathroom, stunning with grey stone tiling & large shower.

The main bathroom is in the same decor with a spacious 3 way design, great for larger families & plenty of room to move about. An abundance of built in cupboards allow for many storage solutions.

The kitchen & living area is excellent, plenty of room for families or entertaining. A clever study nook is built into the room behind bi-fold doors, great for the kids / home office & simply shut the doors to hide any mess.

The kitchen features an abundance of cupboards, bench space, underbench oven, dishwasher & provisions for a larger microwave & fridge/freezer.

Glass sliding doors lead into the outdoor living area, under the main roof & overlooking the rear yard - Which landscaping to both front & rear yards will be completed prior to settlement.

Year round comfort will be ensured with ducted heating & cooling throughout.

Secure vehicle storage for 2 cars with remote access to the double garage.

If you have been thinking of building, then this is a Must See! Ready to move in, plus as mentioned, landscaping is included.

If you are a 'First Home Buyer' then you may be eligible for a government grant of \$15,000.

To arrange your viewing, contact Violet Patty on 0468 388 390.

RLA: 249522

3 BED | 2 BATH | 2 CAR

PRICE:
SOLD

OPEN FOR INSPECTION:
N/A



Violet Patty
0468388390
violet.patty@atrealty.com.au
www.atrealty.com.au
RLA: 269823

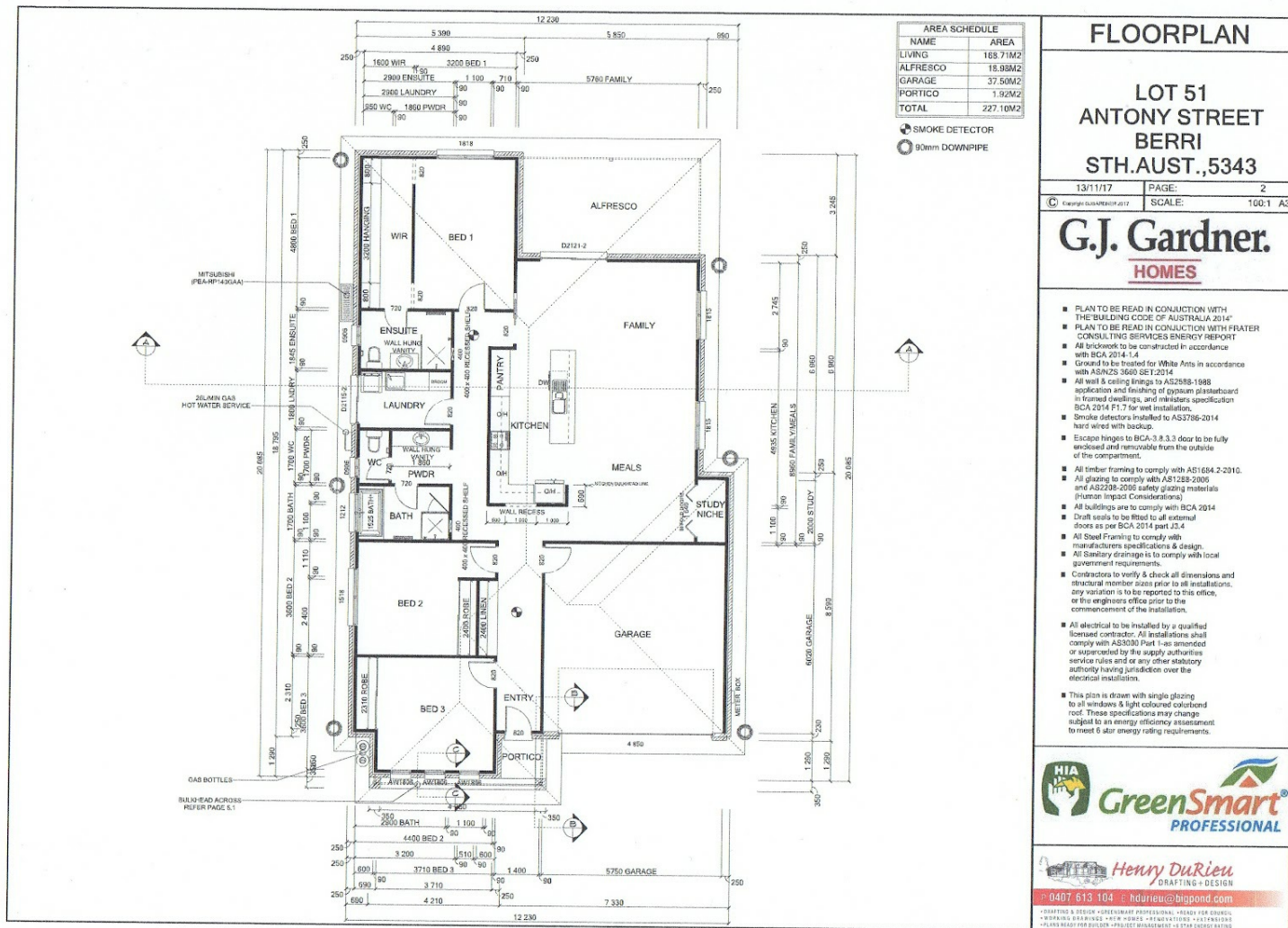

Disclaimer: Please note this floor plan is for marketing purposes and is to be used as a guide only. All dimensions are estimates only and may not be exact measurements.