

818-820 KINGSTON ROAD LOGANLEA

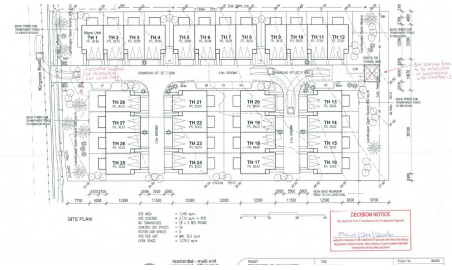

PRIME DEVELOPMENT SITE 818-820 KINGSTON ROAD

- 7064M² of land
- DA for townhouse development
- Also ideal for lot subdivision
- 2 Homes + swimming pool
- Good rental income



FOR SALE

FULL DEVELOPMENT OPPORTUNITY

Total land size - 7,064sqm

Ideal for small lot subdivision & build dual key homes

Great exposure on Kingston Road in Loganlea with easy commuting distances:

- Logan Hospital
- Griffith University
- TAFE College
- Logan Railway Station

Centrally located with easy access to Logan Motorway, Ipswich Motorway & Gateway Motorway

Also has DA approval for a 28 townhouse development

PRICE BY NEGOTIATION

For more information:

PLEASE CALL GODFREY 0401 887 386 OR NILUKA 0406 032 717 FOR DETAILS

Disclaimer: The information provided to the recipient is to assist the recipient and the professional advisors to decide whether to proceed to acquire an interest in the subject property. The discloser does not make or give an express or implied guarantee, representation or warranty regarding i) the accuracy or completeness of the information or ii) whether reasonable care has been or will be taken in compiling, preparing and furnishing the information

0 BED | 0 BATH | 0 CAR

PRICE:

Price by negotiation

OPEN FOR INSPECTION:

N/A



Godfrey & Niluka Warusevitane

0401887386

godfrey@atrealty.com.au

www.atrealty.com.au