

55 HARGREAVES STREET EDMONTON



FOR LEASE

IDEAL CORNER EXPOSURE

WARHOUSE AREA: 310sqm + 15sqm Office

Features

- 5 tonne Crane
- Three roller doors – two - 4.7m x 4.2m, one - 4.2m x 4.2m
- Securely fenced
- 2 car parks

Great exposure on Hargreaves St, a busy thoroughfare to White Rock & Edmonton, located in a thriving industrial area, with easy access off Bruce Hwy

LOCATION: Located in the sort after area of South Cairns Business Park, Edmonton.

0 BED | 0 BATH | 0 CAR

PRICE:

Contact Fiona Green 0428 875 804

OPEN FOR INSPECTION:

N/A



Fiona Green

0428875804

fionagreen@atrealty.com.au

www.atrealty.com.au

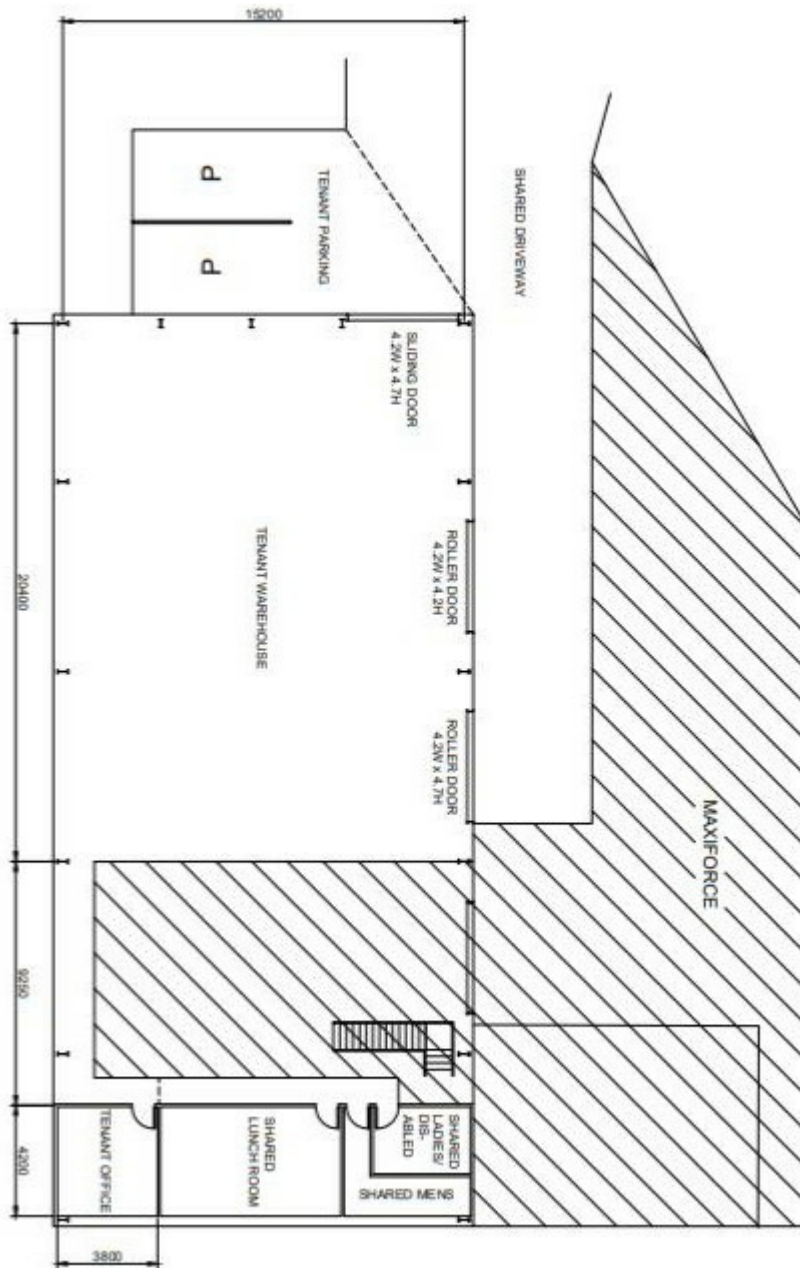

Disclaimer: Please note this floor plan is for marketing purposes and is to be used as a guide only. All dimensions are estimates only and may not be exact measurements.