

ADDRESS UPON REQUEST



**SOLD**

## QUALITY ALL THE WAY

Be inspired by this rare hilltop beauty. Take in the outstanding panoramic views over Gympie and south past Mt Cooran. Enjoy the rural feel of the neighbouring farms but you only have to care for this gently sloping 2.89 acre (1.17ha) piece of country. Situated in the most elevated position at the end of a quiet bitumen cul-de-sac approximately 10 minutes south-east of Gympie CBD.

The crowning glory is the impressive double brick home which has wrap around verandahs to take in those views. 3 queen sized bedrooms with built-ins and the main bedroom is air-conditioned and has double built-ins and ensuite. The modern kitchen has a dishwasher and servery to the dining room and outside covered entertaining area. The lounge room has a wood heater and there's a separate family room.

The man of the house will love the 9m x 7.5m Colorbond shed which has power and water, shelving and a workbench plus the adjoining 6m x 7.5m carport.

Half of the picturesque allotment is securely dog fenced and there are 2 dog kennels. This great family property may be just what you've been looking for.

**4 BED | 2 BATH | 4 CAR**

**PRICE:**  
\$461,250

**OPEN FOR INSPECTION:**  
N/A



**Wayne and Christine Fewtrell**  
**0408450856**  
christine@atrealty.com.au  
[www.fewtrellrealty.com](http://www.fewtrellrealty.com)

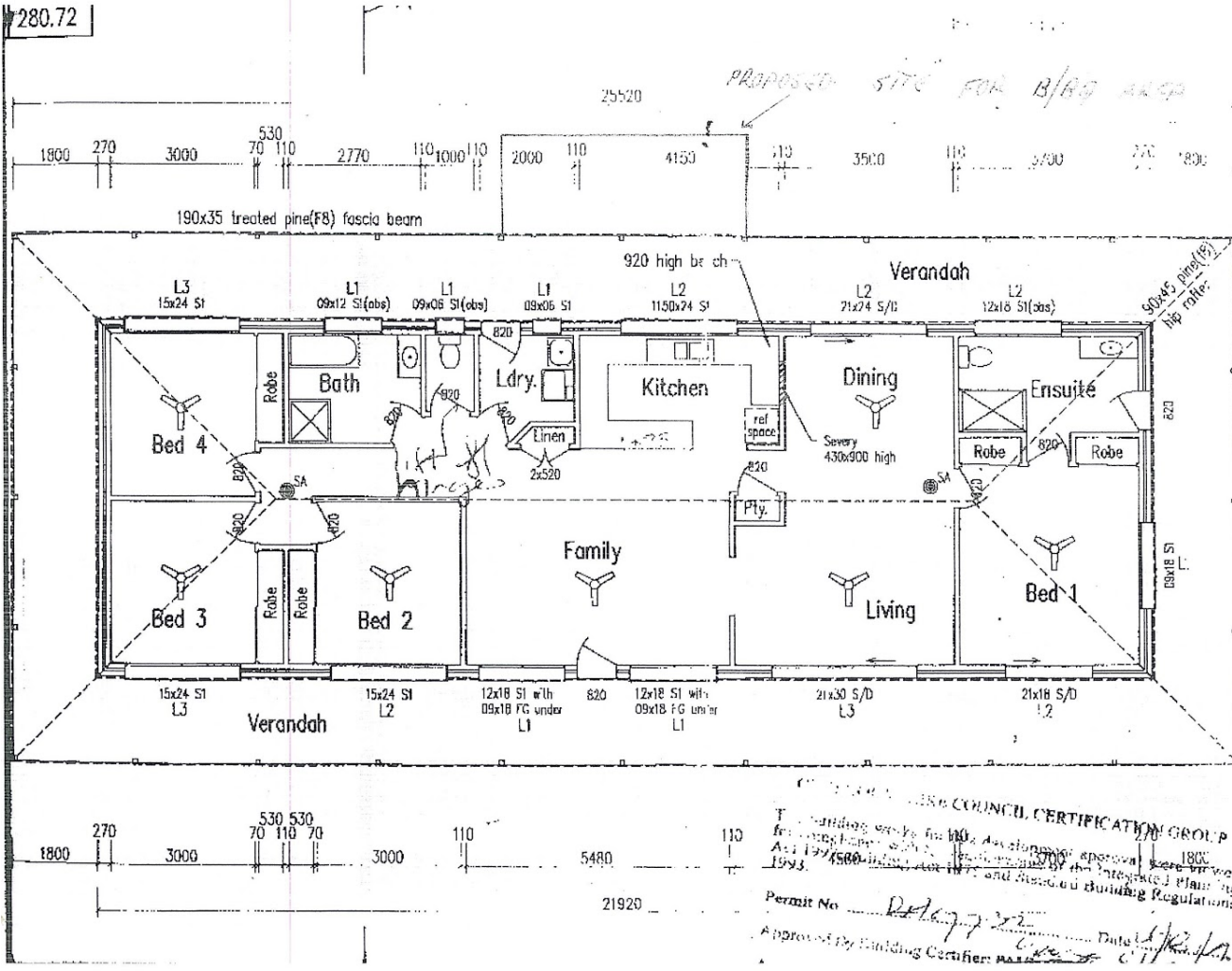

Disclaimer: Please note this floor plan is for marketing purposes and is to be used as a guide only. All dimensions are estimates only and may not be exact measurements.

Wayne and Christine Fewtrell  
 0408450856  
 christine@atrealty.com.au  
 www.fewtrellrealty.com

