



FOR SALE

ARE YOU READY TO FALL IN LOVE?

Be ready to have your breath taken away by this charming Queenslander set amongst $\frac{3}{4}$ of an acre of well-established gardens in a highly sought-after location on Tamborine Mountain. This 1904 relocated Queenslander has been lovingly preserved with many period features, including fretwork, original sash windows, tongue and groove internal linings, hardwood floors, stained glass windows, large eat-in country kitchen with pressed metal cabinets, and a porcelain clawfoot bath to relax in. French doors open onto a wide front verandah where you can sit, watch and listen to the wonderful bird life in the surrounding rainforest whilst taking in your amazing gardens.

This home features generous sized bedrooms as well as multiple large living areas that have a seamless flow giving you plenty of room to entertain or enjoy your own space by the fireplace. Downstairs boasts a large bedroom, sitting area and a second bathroom, ideal for guest accommodation, granny flat or a home business.

Enjoy the benefits of growing a variety of fruit trees, veggies & herbs to provide you with food throughout the year and collecting fresh eggs from your own hens. The property also features solar power, underfloor and ceiling insulation, and bore water access.

UPSTAIRS

- Several large open living spaces with ornate fretwork
- 2 large bedrooms upstairs, main with floor to ceiling wardrobe
- Country style kitchen with original features and a french door leading out to its own patio with water feature
- Tongue & Groove panelling throughout
- High ceilings
- Stained glass window features
- Polished hardwood floors with underfloor insulation
- Classic pedal basin & porcelain claw foot bath
- Ornate wood fire for those cosy nights
- Gas stove & gas heating portals in living areas
- Ceiling fans inside & out
- Water filtration system

DOWNSTAIRS

- 1 bedroom with cosy lounge/sitting area
- 1 bathroom

3 BED | 2 BATH | 2 CAR

PRICE:

OFFERS OVER \$700,000

OPEN FOR INSPECTION:

N/A



Karin Smith

0403012639

karinsmith@atrealty.com.au

www.atrealty.com.au



First Floor

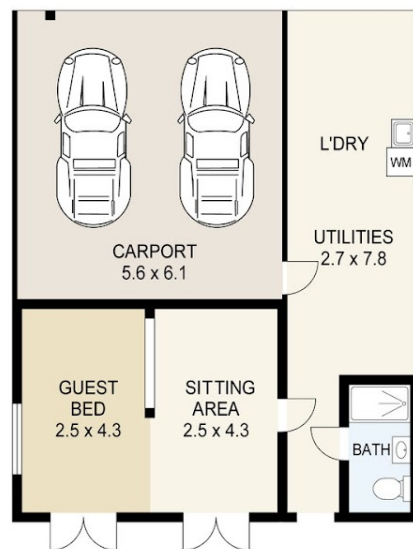

Ground Floor

150 ALPINE TERRACE, TAMBORINE MOUNTAIN



SCALE UNIT IS IN METRES

INTERNAL : 147m²
EXTERNAL : 86m²



All measurements are approximate and for illustration purposes only.
It should not be considered 100% accurate. Interested parties should
rely on their own enquiries.



Disclaimer: Please note this floor plan is for marketing purposes and is to be used as a guide only. All dimensions are estimates only and may not be exact measurements.