

## FOR SALE

### ENJOY A FANTASTIC LIFESTYLE ! JUST LOOK AT THE POSITION !

- \* Georgian Style Terrace Home in sought after location just meters from the heartbeat of North Adelaide.
- \* Generous accommodation with three bedrooms, or two bedrooms plus study, the main bedroom has a cathedral ceilings, french doors opening up to a balcony, ensuite & walk-in robe plus built-in robe to bedroom 2.
- \* Trendy new white kitchen with stone bench tops, stainless steel appliances and dishwasher
- \* Two generous living areas , formal lounge plus family/dine with lovely floor tiles.
- \* There is a lovely lush courtyard perfect for entertaining and family BBQ's.
- \* There are two bathrooms and three toilets in the home ,
- \* Extra features include reverse cycle ducted air conditioning, high ceilings throughout the home and double carport with auto roller door.
- \* This property comes with an enviable lifestyle ! Just meters to the vibrant O'Connell Street , The Village Shopping Centre, Gym, restaurants & cafes, excellent cinemas, Hotels, Parklands and an easy walk to the Adelaide Oval and City (or just get the free city connector bus which runs every half hour).
- \* Further Details call Terry Webster on 0419 993 357 ( Your Local Adelaide Agent for over 25 Years)

3 BED | 2 BATH | 2 CAR

**PRICE:**

\$679,000.00 - \$699,000.00

**OPEN FOR INSPECTION:**

N/A



**Terry Webster**

**0419993357**

[terrywebster@atrealty.com.au](mailto:terrywebster@atrealty.com.au)

[www.atrealty.com.au](http://www.atrealty.com.au)

RLA: 269823

# 157 Tynte Street NORTH ADELAIDE

Area	M <sup>2</sup>
Ground Floor	65.41
Upper Floor	66.91
Carpport	24.01
Balcony	1.98
<b>Total Approx</b>	<b>158.31</b>



**Upper Floor**

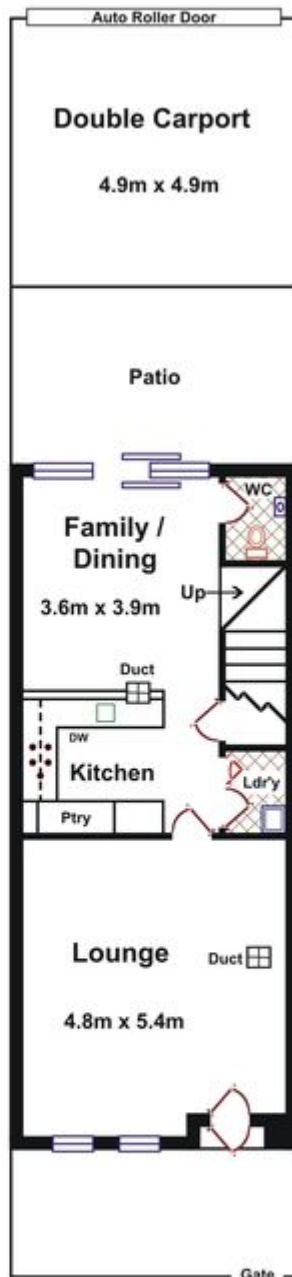

**Ground Floor**

**Please Note:** Every care has been taken to verify the correctness of the areas and details used in this leaflet. No warranty or representation is given or made as to the correctness of the information supplied and neither the owners, illustrator nor the Agent accept responsibility for errors or omissions. The sketch is for illustration purposes only and intending purchasers should satisfy themselves independently regarding sizes, layout and location of the property. Please check with local council that all structures are approved by council.

Disclaimer: Please note this floor plan is for marketing purposes and is to be used as a guide only. All dimensions are estimates only and may not be exact measurements.