



SOLD

BE IMPRESSED, QUALITY FAMILY HOME

ONLY A INSPECTION WILL REVEAL THE QUALITY, SIZE AND CLASS OF THIS STUNNING FAMILY HOME.
IDEAL FOR THE LARGE FAMILY THIS HOME HAS LARGE LIVING AREAS, INCLUDING 3 BATHROOMS, FORMAL LOUNGE, OPEN KITCHEN MEALS PLUS LIVING LARGE 5TH BEDROOM, HOME OFFICE OR 3RD LIVING AREA.
A STUNNING SOLID TIMBER KITCHEN IS THE FEATURE OF THE HOME, WITH HEAPS OF CUPBOARD SPACE, BREAKFAST BENCH, QUALITY APPLIANCES,AND STONE SPLASH BACKS.
4 LARGE BEDROOMS 3 WITH BUILT IN ROBE PLUS THE MASTER BEDROOM IS HUGE WITH WALK IN ROBE AND EN SUITE.
HIGH CEILINGS ORNATE CORNICE WORK, BEAUTIFUL FLOOR COVERINGS PLUS QUALITY LIGHT FITTINGS COMPLEMENT THE HOME.
THE BATHROOMS HAVE BEEN TASTEFULLY UPGRADED, AND THE COLOURS THROUGHOUT THE HOME ARE NEUTRAL TONES.
DUCT ED GAS HEATING AND SPLIT SYSTEM AIR-CONDITIONING KEEPS THE HOME THE PERFECT TEMPERATURE ALL YEAR ROUND.
ENCLOSED PATIO IDEAL FOR ENTERTAINING, LOOKS OVER A LARGE YARD, WITH COLOUR BOND GARAGE IDEAL FOR BOATS CARAVAN OR WORKSHOP.
DOUBLE GARAGE UNDER THE MAIN ROOF WITH INSIDE ACCESS PLUS EASY ACCESS TO THE REAR YARD, MAKES THIS PERFECT FOR MOST FAMILIES.
INSPECTION IS RECOMMENDED.

4 BED | 3 BATH | 3 CAR

PRICE:
\$428,500

OPEN FOR INSPECTION:
N/A



Peter Dempsey
0418854393
peterdempsey@atrealty.com.au
peterdempseyatrealty.com
RLA: 269823

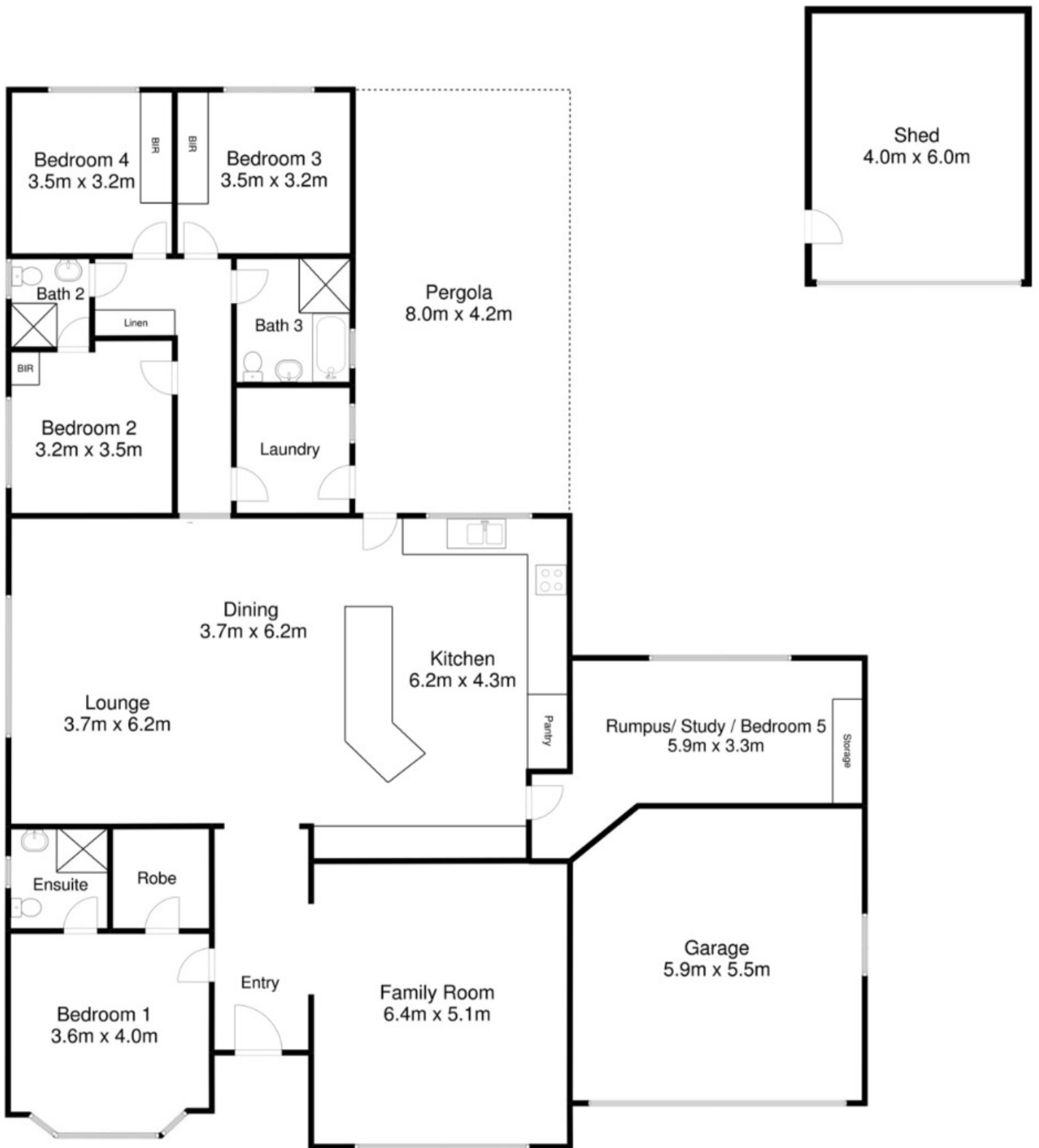

Disclaimer: Floor Plan measurements are approximate and are for illustrative purposes only. While we do not doubt the floor plans accuracy, we make no guarantee, warranty or representation as to the accuracy and completeness of the floor plan

Disclaimer: Please note this floor plan is for marketing purposes and is to be used as a guide only. All dimensions are estimates only and may not be exact measurements.