



FOR SALE

STUNNING ACREAGE PROPERTY... REDUCED \$50K

Welcome to your new home, 223-227 Rossmore Rd, Chambers Flat. This "low maintenance" family home presents endless opportunities awaiting its next owners. Every once in while a property with a true "Wow" factor comes along and this stunning acreage property still close to the city is it. This home is rock solid has an iron roof and was built to last when craftsmanship counted. Perfectly positioned on a tree studded North facing block this solid family home has been created with a true homestead feel.

This lovingly maintained home has too many features to list but includes:

- 4 large bedrooms, all with built in robes and security screens
- Ensuite to master bedroom
- Ceiling fans and security screens
- Attractive hardwearing floors throughout
- Huge kitchen with generous bench and cupboard space
- Large pantry and generous fridge space to fit modern fridges
- Beautiful neutral paint that lends itself to any decorating style
- Large shower over bath in the main bathroom
- Good sized separate laundry
- Full length verandah offering stunning views of the property and the dam in the front yard.
- 2 car lock up garage made of the same construction as the home lending itself to potential granny flat
- Additional 4 car lock up garage at the end of the beautiful gravel driveway
- 4 rainwater tanks
- 3kw solar power panels
- 10020 sqm or 2.5 acres
- Stunning street appeal with picturesque manicured gardens
- Garden shed

4 BED | 2 BATH | 0 CAR

PRICE:

Offers Over \$549,000

OPEN FOR INSPECTION:

N/A



Roz Abrahams

0413070707

roz@atrealty.com.au

www.atrealty.com.au

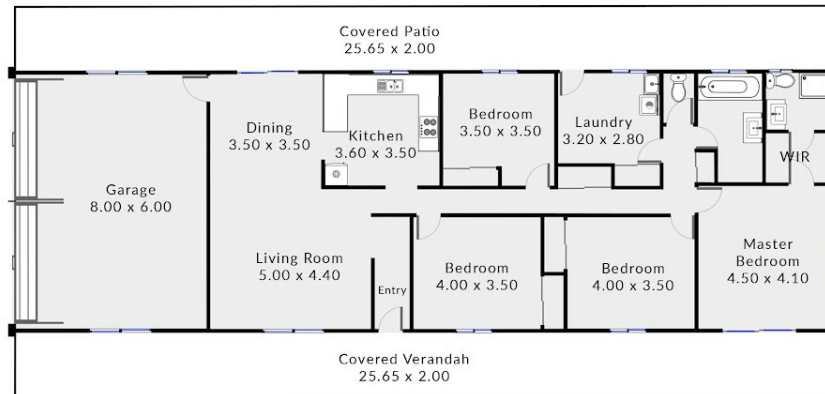

223 Rossmore Road, Logan Reserve, QLD

Whilst every attempt has been made to ensure accuracy of the floor plan contained here, measurements of doors, windows, rooms and any other items are approximate and no responsibility is taken for any error, omission, or mis statement. This plan is for illustrative purposes only and should be used as such by any prospective purchaser.

Disclaimer: Please note this floor plan is for marketing purposes and is to be used as a guide only. All dimensions are estimates only and may not be exact measurements.