



FOR SALE

LIVING CONVENIENCE NEXT TO SHOPS & NEAR SCHOOL!

A contemporary design and build, this four-bedroom, two-bathroom home enjoys a quiet corner position with no rear neighbours, where you can relax on the patio enjoying a peaceful sunset behind a tranquil mountain backdrop. This very well presented home offers a fantastic media area, open plan dining and chic kitchen complete with stainless steel Bosch appliances. Other features include air-conditioning, built in wardrobes, double remote lock up garage with extra storage, fibre optic, gas hot water system, recycled water, some energy efficient windows, LED kitchen lights and security screens. Fully fenced large back yard with heaps of space for the kids to play and for a swimming pool. This home is conveniently located within steps to quality shops, cafes, retail outlets, day-care and schools. Smithfield Village is a well-designed master planned community where you can enjoy a relaxing life surrounded by nature, parks, playgrounds, bike and walking paths, wetlands and BBQ areas. Rental appraisal \$450 per week approx. ROI 5.7% per annum approx.

Contact us today to arrange your viewing.

4 BED | 2 BATH | 2 CAR

PRICE:

Offers Over \$410,000

OPEN FOR INSPECTION:

N/A



Zoe Wicks
0477114778

zoewicks@atrealty.com.au
www.atrealty.com.au

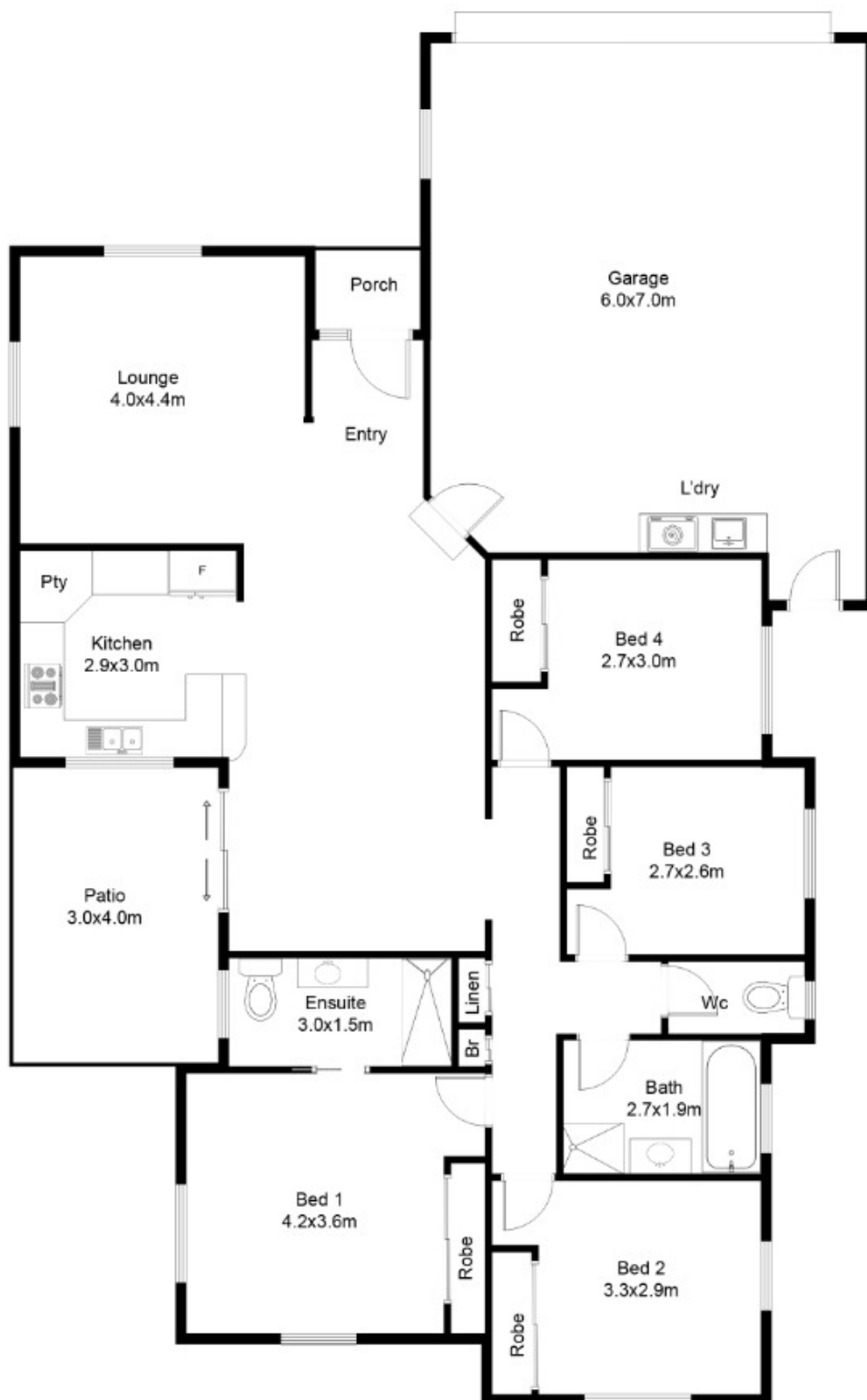

Disclaimer: Please note this floor plan is for marketing purposes and is to be used as a guide only. All dimensions are estimates only and may not be exact measurements.

Boxbrownie.com gives no guarantee, warranty or representation as to the accuracy and layout. All enquiries must be directed to the agent, vendor or party representing this floor plan.

35 Thooleer Vista, Trinity Park Qld 4879