



FOR SALE

NEAR NEW HOME IN THE PRESTIGIOUS MADISON RIDGE ESTATE!!

Its not often a home as stunning as this comes on the market especially in the sort after Madison Ridge Estate! Offered exclusively for the first time is this stunning 4 bedrooms family home with all the added extras from a large study to a stunning family media room! Conveniently located 10 minutes from the Bruce Highway and minutes to local shops and schools whilst still being surrounded by peaceful park lands and wildlife. Enjoy space and privacy and relax and unwind in the beautiful surrounds this property has to offer.

The modern and functional layout has been perfectly designed with family in mind from the massive kitchen with 6 burner gas cook top and stone bench tops to the butler pantry with loads of room for storage! An open plan kitchen, dining and living creates a space to relax with the family , however the home also boasts a functional media room with projector and activity room for those times you need some peace and quiet. There is plenty of room to move and grown in this stunning spacious new home!

Its not just the inside that will impress! Take a step outside and be blown away by the serenity and space of this 3/4 acre block. Relax and enjoy the built in fire place and patio area or head down to the MASSIVE shed to play with the toys . This home will have you in awe no matter where you are!

Features Include:

- Massive 3 bay Shed with power and extra bay and car port!
- Stunning custom made built in Fire Pit perfect for those winter nights or entertaining !
- Large open plan kitchen with stone bench and gas cooking
- Massive fridge cavity for Family sized double door fridge
- Massive butler's pantry with loads of storage room!
- Functional media room with projector screen in place!
- Kids separate activity area or chill out zone!
- 4 large bedrooms with built ins and ceiling fans
- Over sized Master bedroom with HUGE en suite with double vanity!
- Large double door study or 5th bedroom!

4 BED | 2 BATH | 4 CAR

PRICE:
\$722,000

OPEN FOR INSPECTION:
N/A



Mark Poole
0417731453

markpoolecommercial@atrealty.com.au
www.atrealty.com.au

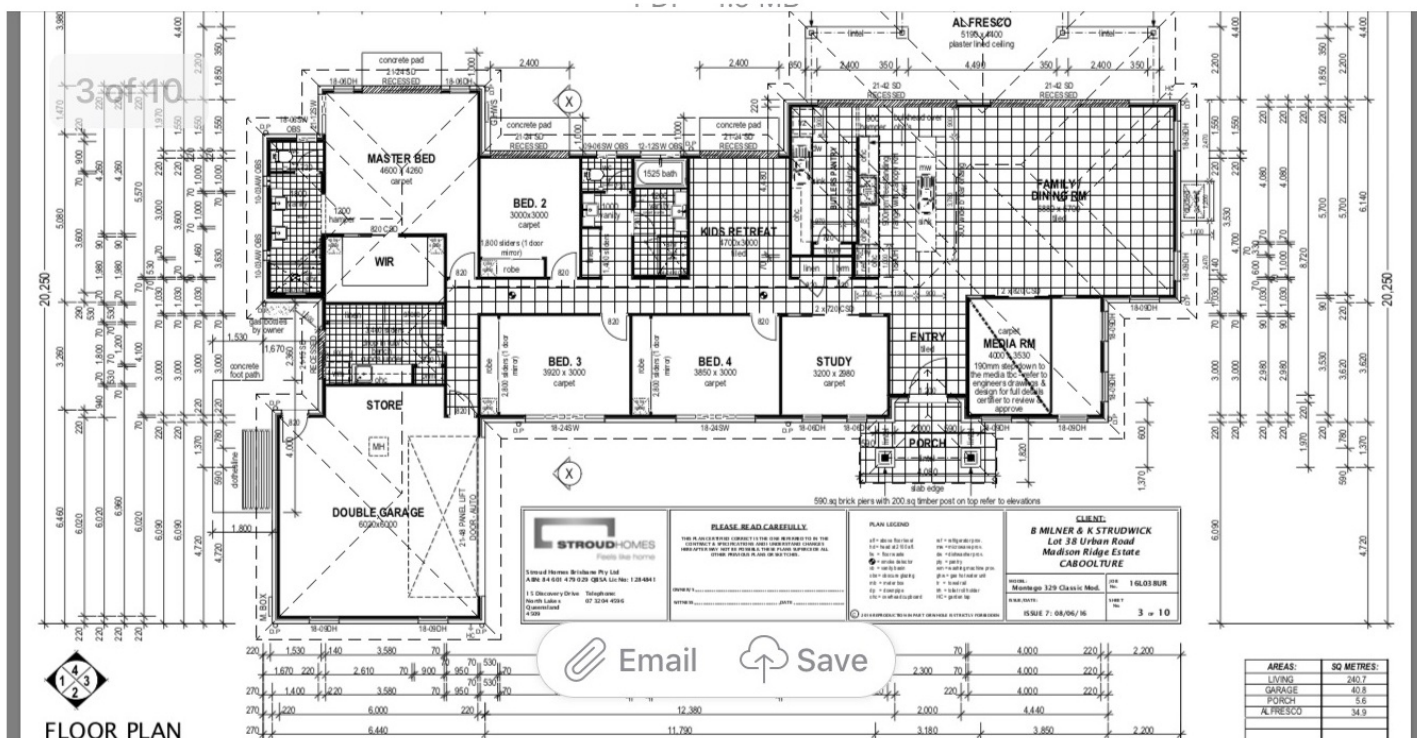

Disclaimer: Please note this floor plan is for marketing purposes and is to be used as a guide only. All dimensions are estimates only and may not be exact measurements.