



FOR SALE

OWNER SAYS SELL - GET IN QUICK!

Presenting to the market the best value money can buy in Bray Park, this three bedroom, two bathroom home has so much to offer. Nothing left to do, here you can reap the rewards of someone else's hard work.

Upstairs you will find new flooring, an air-conditioned open plan living and dining area with a combustion fireplace, renovated kitchen opening out to the entertaining deck, three good sized bedrooms with built in robes and stylish new ceiling fans. Did I mention the fully renovated bathroom... brand new to die for shower, imagine coming home from a hard day in the field or office and stepping into your very own THREE headed shower, that's right THREE shower roses and it gets better you can even sit down! Has to be seen to be believed.

Downstairs will not disappoint either, with polished concrete flooring throughout, two utility rooms (one with air-con and walk in robe), a fully renovated bathroom, multi-purpose area and full kitchen with stone bench tops.

Let's step outside... Manicured front gardens with side access to a Large Titan 6x6 Shed with power and water, an additional garden shed so the "real" shed can be utilised for "real" shed business! Fully fenced backyard so the kiddies and fur babies can run and enjoy, there's even room for a pool. Solar panels on the roof of 2.5kw and Solar hot water system too.

What are you waiting for? Don't delay, call Natalie today on 0419 689 309 to find out inspection times.

At a glance:
Fully renovated 3Bed, 2Bath
Additional 2 Utility Rooms
Separate access upstairs and downstairs
2.5kw Solar System
Solar Hot water
LED Downlights
Colourbond Fencing
Titan 6 x 6 Shed
Additional garden shed
Loads of storage

3 BED | 2 BATH | 2 CAR

PRICE:
Under Contract

OPEN FOR INSPECTION:
N/A



Natalie Johnston
0419689309
natalie@atrealty.com.au
[Natalieatrealty](#)

Whilst every attempt has been made to ensure the accuracy of the floor plan contained here, measurements of doors, windows rooms and any other items and structures are approximate and no responsibility is taken for any error, omission or mis-statement. Bathroom and kitchen fittings, cupboards and door types and laundry appliances and windows are tokens and approximate the actual fitting installed.

This plan is for illustrative purposes and should be used as such by any prospective buyer. Plan drawn by Eagle Eye Photography Service, www.eagleeyetq.com.au Copyright 2018. All rights reserved.

No reproduction without license, contact photographer for more information.

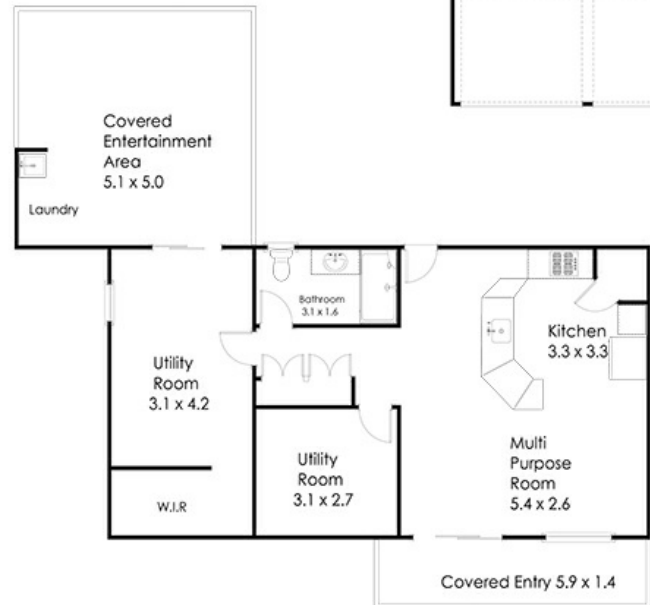
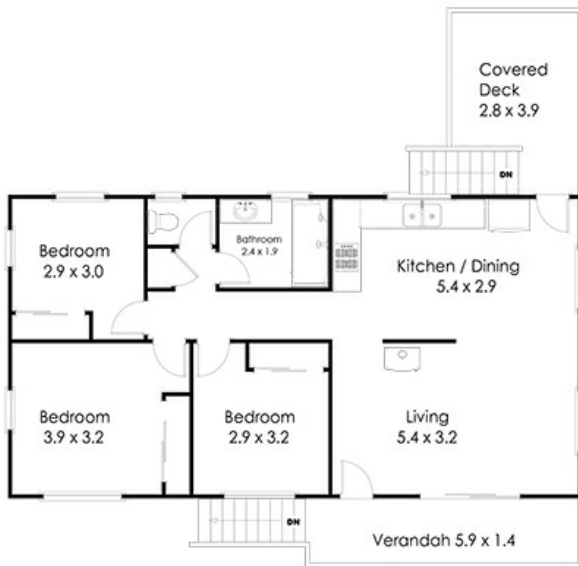

9 Tamarix Avenue Bray Park 4500

@realty

Disclaimer: Please note this floor plan is for marketing purposes and is to be used as a guide only. All dimensions are estimates only and may not be exact measurements.