



SOLD

ONE OF THE MOST USABLE, PRIVATE AND SECURE ACRE IN MUDGEERABA!!

The ultimate location, 1 acre, fully fenced corner block with manicured magical usable yard backing onto council parkland/ pony trail on 2 sides!! Potential to build dual living with it's own entrance with 2 street frontages (1 Tulloch Crescent and 28 Gunsynd Drive). Children's paradise with charming cubby house and sand pit and, there is even room for a pony!! Existing hobby farm set up with fenced chicken coop, fenced vegie patches, lots of fruit trees and so much space!

Tradies rejoice! Large shed + carport and plenty of space for trucks, trailers, boats and caravans.....Extend, renovate or just move in located within minutes to Somerset College, M1, Robina Shopping Centre Precinct.

- . 4 bedrooms + air conditioned study or home office with it's own entrance.
- . 2 new bathrooms
- . Spacious living + dining overlooking the pool
- . Town water + 25,000 lt water tank which can be switched to only run on tank water.
- . 5.9 kilowatts solar panels
- . Fully fenced and gated 4094 m2 corner block with 2 street frontages and backing onto Council park land/ pony trail on 2 sides
- . Insulated 12 x 7 shed (fit 3 vehicles) + 9 x 7 carport (fit 3 vehicles or boat caravan etc)
- . Established tropical yard with fire pit, fruit trees to include mangoes, bananas, lemons, mandarins, lychees, figs, peaches, chocolate puddings, custard apples, mulberries, paw paw, passion fruits and coconuts... and a fenced vegie patch!!
- . Chicken coop loaded with character & fully fenced.

This property can rent between \$795- \$830 per week.

Building & Pest has been done for this property and can be emailed. Please call or text Audrey for a private inspection anytime.

4 BED | 2 BATH | 6 CAR

PRICE:
\$880,000

OPEN FOR INSPECTION:
N/A



Audrey Goetz
0412148078
 audrey@atrealty.com.au
www.atrealty.com.au

1 Tulloch Crescent, Mudgeeraba

4 bedrooms 2 bathrooms 3 carports 4,090 m²

internal: 292 m² | external: 192 m² | total: 484 m²



Audrey Goetz 0412 148 078

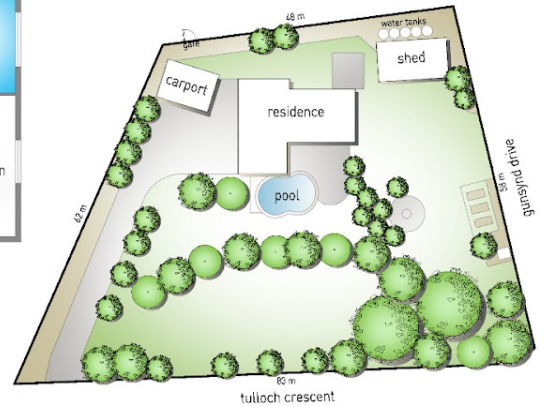
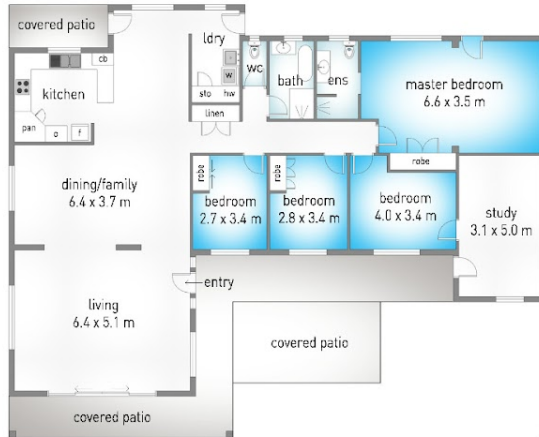
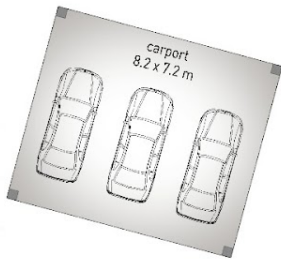

site plan

realimage media
PROPERTY PHOTOGRAPHY • DIGITAL MEDIA

Dimensions are approximate. All information contained herein is gathered from sources we believe to be reliable. However we cannot guarantee its accuracy and interested persons should rely on their own enquiries.



Disclaimer: Please note this floor plan is for marketing purposes and is to be used as a guide only. All dimensions are estimates only and may not be exact measurements.

Audrey Goetz
0412148078
audrey@atrealty.com.au
www.atrealty.com.au

