

FOR SALE

DECEASED ESTATE ON 696M2

This may be the first house on Mooculta Street built by the Sheath family about 1910-15 and never offered for sale since then. The property is considered to be in the best position on the street, and is close to schools, cafes, restaurants and public transport.

The house presently comprises downstairs large formal living room with some original coloured glass windows, separate dining room kitchen bathroom and bedroom with enclosed sunroom and outdoor verandah.

Upstairs there is the main bedroom with walk in wardrobe, bathroom and second bedroom.

Many possibilities await for the new owner to renovate or build something exciting. There is plenty of room that this wide block has to offer for any buyer or family looking to make it their own.

3 BED | 2 BATH | 0 CAR

PRICE:
Contact Agent

OPEN FOR INSPECTION:
N/A



Vincent Nastasi
0488808300
vincent@atrealty.com.au
www.atrealty.com.au

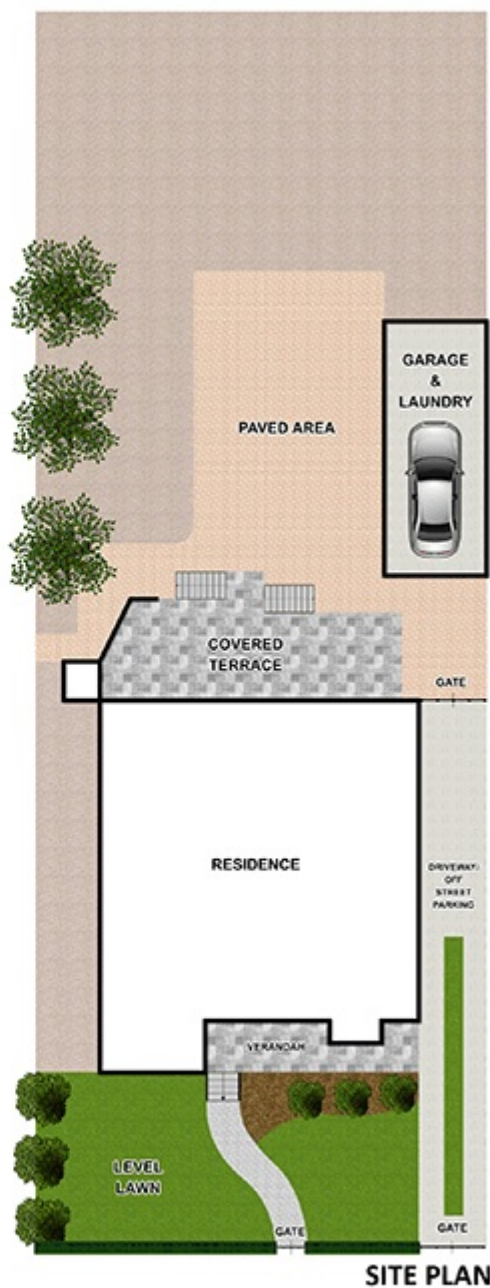

7 Mooculta Street
RUSSELL LEA

Measurements are approximate. Not to scale. Illustrative purposes only.

Disclaimer: Please note this floor plan is for marketing purposes and is to be used as a guide only. All dimensions are estimates only and may not be exact measurements.