



ANDREW SOLD IT

41/2 PANDANUS PL
UPPER COOMERA



SOLD

UNDER CONTRACT

Built circa 2016, this stylish 'AS NEW' town home is so competitively priced it smashes the competition and all local brand new townhouses by some \$50,000! With an air of sophistication, is not to be missed. If you are looking to simply move in and not worry about maintenance for many years to come this is a very smart option for you. The presentation is 'as new' your only problem being how to furnish the immaculate space.

- * 3 double bedrooms all with robes and ceiling fans
- * 2 Bathrooms en suite to master and ground floor powder room
- * Double auto garage with storage facilities
- * Split cycle air conditioning to living areas and master bedroom
- * Stone kitchen bench tops and glass splash backs with stainless steel appliances
- * Security Screens and fly screens
- * Patio Garden

Features include:

- * A striking modern rendered townhouse
- * Large master bedroom with en suite,
- * Additional two bedrooms both with built ins and ceiling fans
- * Family bathroom with both bath and shower
- * Spacious quality kitchen of ultra contemporary style with stone bench tops and gas cooking
- * Open plan living space with plenty of room for the family
- * Downstairs private courtyard with zero maintenance gardens
- * Reverse cycle air conditioning
- * Ceiling fans in all bedrooms
- * Excellent storage
- * Double auto lock up garage
- * Rental appraisal at \$430 per week (UNIT 3 RECENTLY RENTED AT \$430)
- * 5 minutes to Coles, Library, Community Centre, cafes, fast food restaurants
- * Walk to the doctors, physiotherapist, pharmacist and vets
- * 2 minutes to the M1 Motorway easy links
- * 5 minutes to the new Westfield Coomera Shopping centre
- * Upper Coomera is 40 minutes from Coolangatta international airport and 45 minutes to Brisbane
- * Low body corp at \$41 per week

3 BED | 2 BATH | 2 CAR



PRICE:
\$348,000

OPEN FOR INSPECTION:
N/A

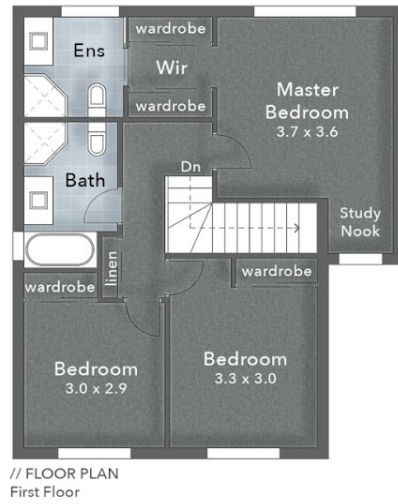

Andrew Colley
0488217803
andrewcolley@atrealty.com.au
andrewcolley.com.au

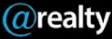

| | | | |
|--|--|--|--|
| RESERVE COURT 41/2 Pandanus Place UPPER COOMERA | FLOOR AREA SIZES Internal 152m ² Patio & Porch 14m ² Total 166m ² or 17 Squares | PROPERTY DETAILS - 3 Bed - 2 Bath + Powder - 2 Car |  ANDREW COLLEY PROPERTIES  0488 217 803 |
|   <p>The overall presentation style, layout, imagery, fonts, background, colours and terminology are subject to strict copyright of Pure Design Concepts. No ownership is taken for building design. All measurements are approximate & individuals should rely on their own information. Find out more at puredesignconcepts.com.au</p> | | | |

Disclaimer: Please note this floor plan is for marketing purposes and is to be used as a guide only. All dimensions are estimates only and may not be exact measurements.

Andrew Colley
 0488217803
 andrewcolley@atrealty.com.au
andrewcolley.com.au

