



FOR SALE

WALTON STREET WINNER – QUALITY AND LIFESTYLE

Situated on popular Walton Street - famous for it's median strip of shady Moreton Bay Fig trees - this quality duplex embraces the vibrant Southport lifestyle. Handy to schools and public transport and only a short 5 minute walk to the fabulous cafes and restaurants of Chirn Park, and a 10 minute stroll to Southport and the Broadwater.

Occupying the entire first floor, this 3 x bedroom, 2 x bathroom property enjoys the low maintenance benefits of unit dwelling – whilst having it's feet firmly on the ground with a fully fenced grassed backyard and undercover alfresco outdoor area.

The open plan living area delivers a light filled living space that interacts seamlessly with the generous full width balcony, enjoying views over Walton Street through a large bank of stacker sliding doors.

The kitchen is the heart of any home and this one doesn't disappoint. Stone counter-tops, soft close doors and Bosch appliances cover the functional aspects, whilst the aqua green glass splashbacks add an injection of soft colour to the classic neutral tones.

Generously proportioned and well appointed, the master suite boasts a fully fitted walk-in-robe, and luxurious ensuite bathroom with quality fixtures. This bedroom also offers direct access to the private courtyard area.

All three bedrooms have built in robes, ceiling fans and air-conditioning. There is secure parking for two cars, plus additional storage space in the large tandem garage.

Property Features include:

3 Bedrooms, 2 bathrooms.

Situated on popular Walton Street, close to Chirn Park shops, cafes and restaurants, and a close walk to Southport and the Broadwater.

Air-conditioning and fans to living and bedrooms.

Quality kitchen with Bosch appliances, stone counter-tops, and loads of bench space.

Large living area flowing to balcony through stacker sliding doors.

Laundry with storage, and direct access to lawn and clothes line.

3 BED | 2 BATH | 2 CAR

PRICE:
UNDER CONTRACT

OPEN FOR INSPECTION:
N/A



Scott Euler
0431174010

scott.nicola@atrealty.com.au



// FLOOR PLAN
First Floor - 2.5m Ceiling

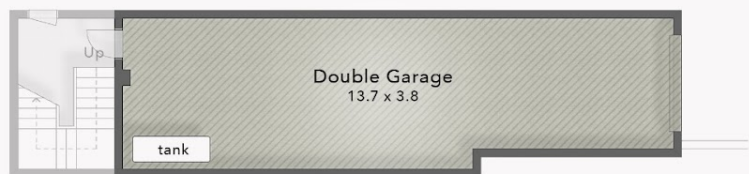

// FLOOR PLAN
Ground Floor

1/8 Walton Street
SOUTHPORT

FLOOR AREA SIZES

Internal 166m² | Garage 55m² | Covered Terraces 32m²
Total 253m² or 27 Squares
Exclusive Use Courtyard 40m²

PROPERTY DETAILS

- 3 Bed
- 2 Bath
- 2 Car

SCOTT EULER & NICOLA BUCHANAN **@realty**

0407 750 620 | 0431 174 010

puredesign
CONCEPTS PLANS FOR PURPOSE

The overall presentation style, layout, imagery, fonts, background, colours and terminology are subject to strict copyright of Pure Design Concepts. No ownership is taken for building design. All measurements are approximate & individuals should rely on their own information. Find out more at puredesignconcepts.com.au

Disclaimer: Please note this floor plan is for marketing purposes and is to be used as a guide only. All dimensions are estimates only and may not be exact measurements.

Scott Euler
0431174010
scott.nicola@atrealty.com.au

@realty