



FOR SALE

SUPERB START OR SERENE DOWNSIZE

Delivering a lifestyle of serenity for the first home buyer, downsizer or investor, this peacefully placed single level unit entices easy-living with its spacious layout, low-maintenance surrounds and premier position moments from schools, shops and transport. Nestled in the bowl of a quiet court in a well-maintained block of 4, the residence opens to reveal polished floorboards that shimmer underfoot and grace the light-filled lounge room with adjacent dining zone. Perfect for those who love to cook, the kitchen boasts quality appliances (including dishwasher), a corner pantry plus a breakfast bench, while sliding doors lead out to the easy-care courtyard. Split into two wings, the three bedrooms include a master bedroom with walk-in-robe and en-suite, while the two children's bedrooms rests along the hallway; each equipped with built-in-robies and serviced by a family bathroom and separate toilet. Further enhanced by a laundry, ducted heating, ceiling fans, alarm plus a garage that rests conveniently beside a visitor parking space. Nestled in an outstanding location, close to St Joseph's College, St John the Baptist Primary, Mountain Gate Primary, Mountain Gate Shopping Centre, parkland, Ferny Creek Nature Trail, buses and trains.

Photo ID required at all open for inspections.

3 BED | 2 BATH | 2 CAR

PRICE:
\$595,000

OPEN FOR INSPECTION:
N/A



Adrian Chalmers
0431402112
adrian.chalmers@atrealty.com.au
www.atrealty.com.au



0 1 2 3 4



approx. scale (m)

This plan is a sketch, and all data shown is general only

NB: All stated dimensions are approximate only & should not be taken as definite.

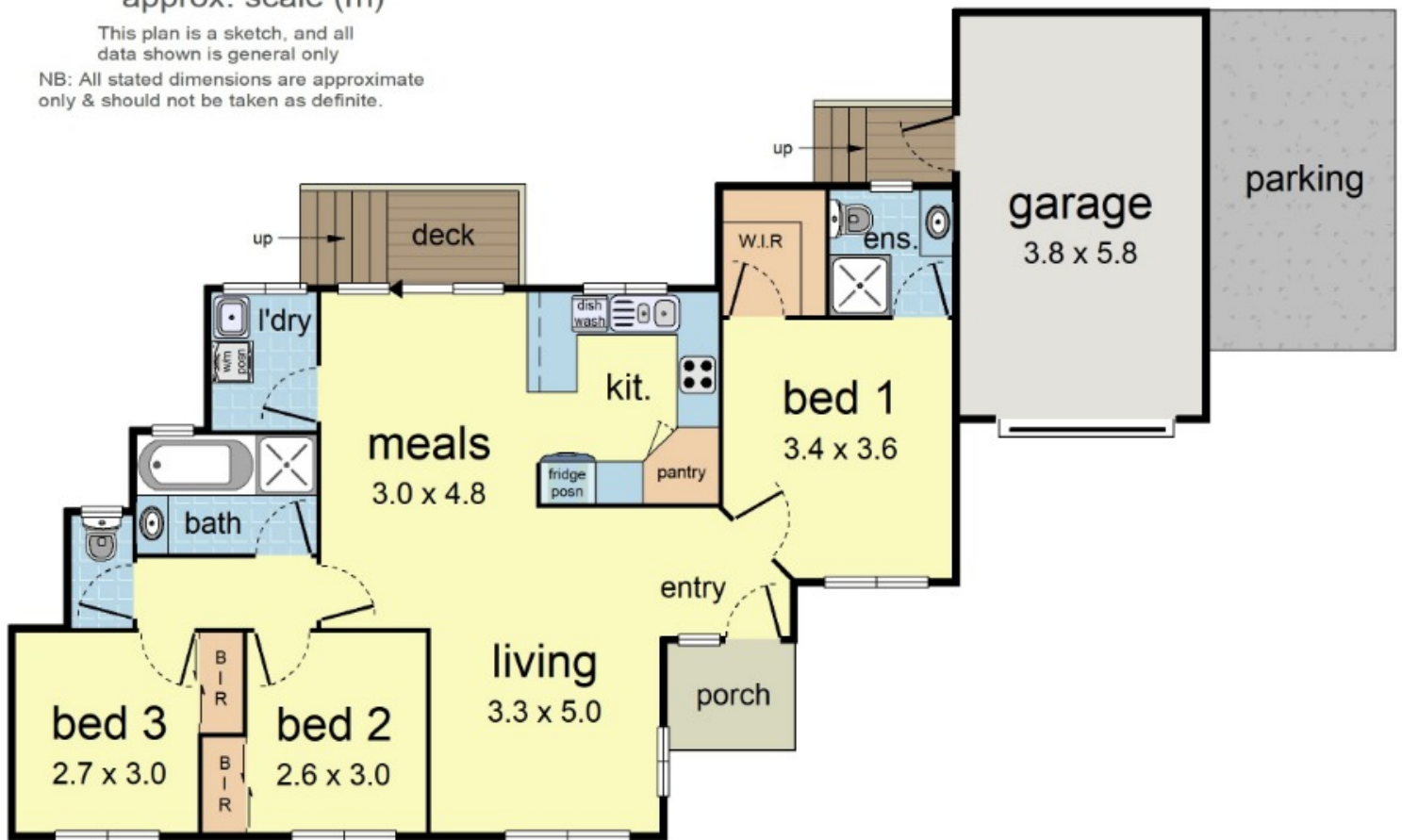

4/7 Aringa Court, Ferntree Gully

Disclaimer: Please note this floor plan is for marketing purposes and is to be used as a guide only. All dimensions are estimates only and may not be exact measurements.