

## FOR SALE

### OPPORTUNITY TO SPREAD OUT

This well-maintained home is set on a large 15,17 square meter block with rear lane access. Well suited to first home buyers investors tradies or retirees alike great workshop space and loads of room for a caravan or boat The large shed would suit a teenagers retreat. This home consists of 3 bedrooms 1 bathroom with 2nd toilet, Features include, Polished hardwood floors throughout ., recently renovated bathroom, light and spacious kitchen with ample cupboard space, reverse cycle air conditioning fenced back yard, a large covered entertaining area perfect for all conditions. Set in a great location this is a neat and tidy property your inspection is encouraged to appreciate all that is to offer.

3 BED | 1 BATH | 2 CAR

PRICE:  
\$295,000

OPEN FOR INSPECTION:  
N/A



**Peta Thompson**  
**0403123115**  
petathompson@atrealty.com.au  
[www.atrealty.com.au](http://www.atrealty.com.au)

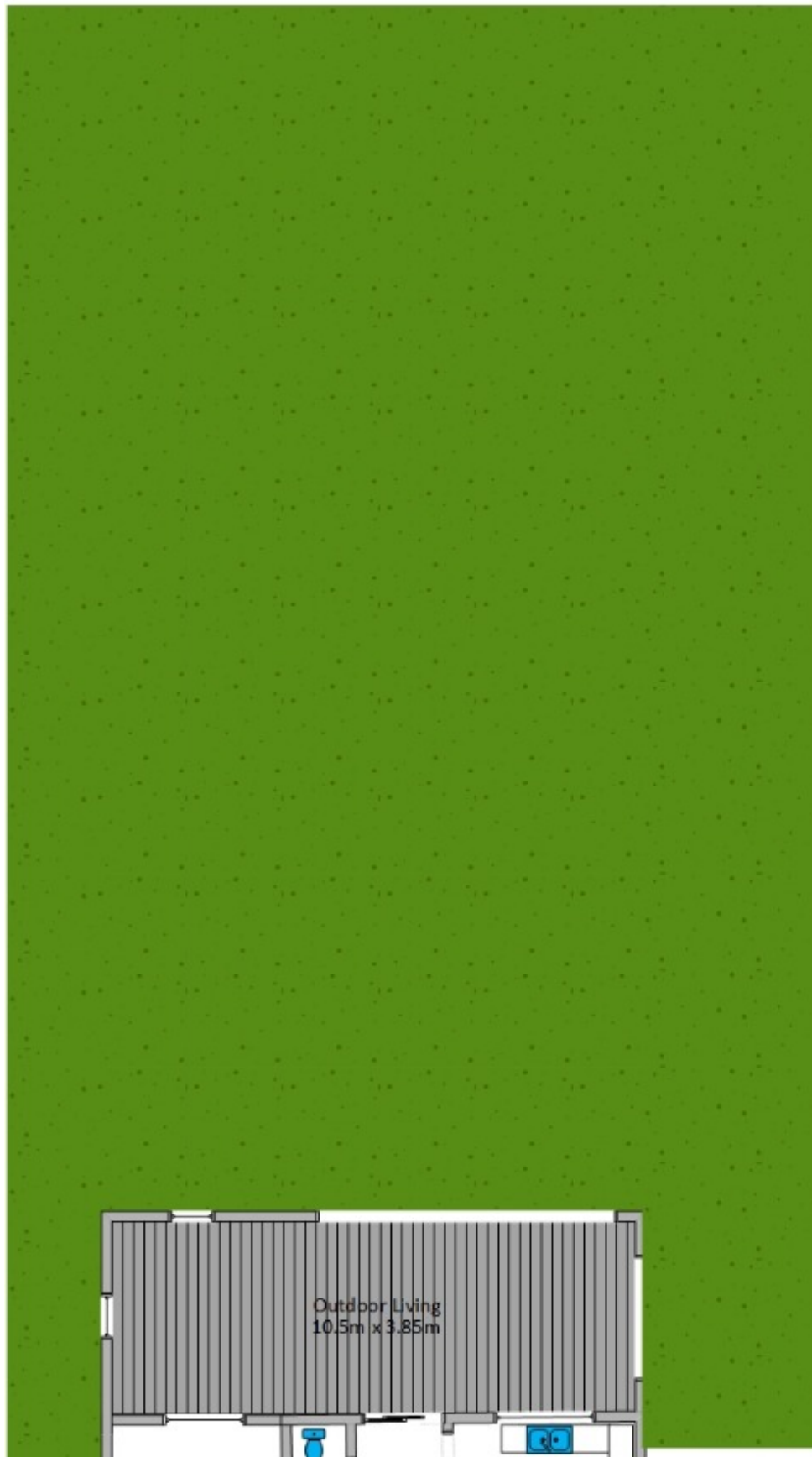

Disclaimer: Please note this floor plan is for marketing purposes and is to be used as a guide only. All dimensions are estimates only and may not be exact measurements.



130m<sup>2</sup> TOTAL

@realty

WE ACCEPT NO LIABILITY FOR  
AUTHORSHIP OF THE ABOVE DESIGN.  
DRAWINGS ARE INTERPRETATION ONLY  
FOR THE BENEFIT OF MARKETING  
PURPOSES. ALL MEASUREMENTS ARE  
APPROXIMATE. INDIVIDUALS SHOULD RELY

Peta Thompson  
0403123115  
petathompson@atrealty.com.au  
[www.atrealty.com.au](http://www.atrealty.com.au)

Bedroom  
3.62m x 3.76m

ON THEIR OWN INFORMATION.