

SOLD

ARCHITECTURALLY DESIGNED PERFECTION IN MINNIPPI ESTATE

Brand new offering from the esteemed Aesthetic Constructions. This property has an abundance of style and elegance. Impressive four bedroom home is everything you have been searching for. With not a single thing left to be done, this property has been designed to absolute specifications and occupies a fantastic position in the new Minnippi Golf course Estate high on the hill.

Set across two levels, this home will be instantly appealing to all families, as well as those who appreciate the joys of entertaining. Across the ground level is an expansive living and dining area adorned with beautiful timber floors and high ceilings.

A stunning kitchen forms the heart of the home, designed to the highest specifications. It boasts high quality appliances including dual ovens, stone bench tops, stylish cabinetry and a huge butler's pantry.

Large sliders bring the lush greenery outside into the home, and allows for a smooth transition to alfresco dining and entertaining by the pool. The pool house is covered and complete with integrated barbeque and preparation space, ready for hosting friends and family year round.

- Outstanding home provides plenty of options for the whole family
- Opulent master with peaceful views, custom walk-in robe
- Luxury master ensuite with twin basins, natural stone, and custom timber cabinetry
- Remaining 3 bedrooms equipped with built-in robes, ceiling fans
- Upstairs rumpus ideal as a teen retreat
- Main bathroom featuring twin vanities and full size bath
- Sparkling swimming pool perfect to relax with friends and family
- Ducted air-conditioning, security system, large laundry
- 648m² parcel of land allowing for many options
- Travertine stone lined paths and featured throughout
- Privileged blue ribbon position in Cannon Hill
- Minutes to the Carindale shopping and entertainment precinct

4 BED | 3 BATH | 2 CAR

PRICE:
\$1,425,000

OPEN FOR INSPECTION:
N/A



Dane McInerney
0400596662
dane@atrealty.com.au
www.atrealty.com.au

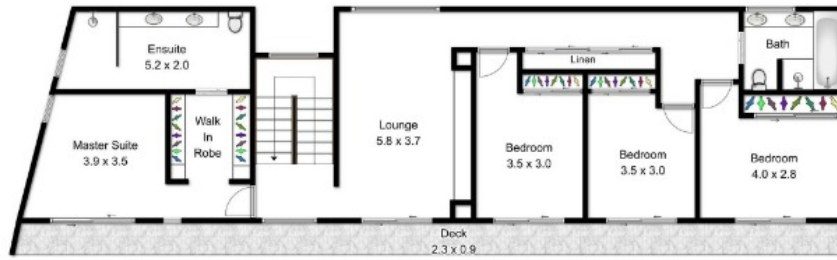

5 Mckie Crescent, Cannon Hill

Internal : 261 sqm
 External : 64 sqm
 Garage : 53 sqm
 Total Area : 378 sqm

Whilst every attempt has been made to ensure the accuracy of the floor plan contained here, measurements of doors, windows, rooms and any other items are approximate and no responsibility is taken for any error, omission, or mis-statement. This plan is for illustrative purposes only and should be used as such by any prospective purchaser. The services, systems and appliances shown have not been tested and no guarantee as to their operability or efficiency can be given. Floor plan created by FosfOCUS.com.au

Disclaimer: Please note this floor plan is for marketing purposes and is to be used as a guide only. All dimensions are estimates only and may not be exact measurements.