

## FOR SALE

### DELIGHTFUL HOME ! GREAT LOCATION ! MODERN UPGRADES !

- \* Attractive eco friendly solid brick family home in popular quiet location close to schools, parks and shopping centres
- \* Home comprises formal L- shape lounge/dine with fireplace and beautiful floating floors.
- \* Modern updated kitchen/meals area with stainless steel appliances and walk-in pantry.
- \* Three good sized bedrooms with new carpet to bedroom 3.
- \* Family /office with sliding doors to atrium and also sliding doors leading out to large entertaining area.
- \* Lovely updated bathroom and updated separate toilet.
- \* Huge updated laundry / sewing room with lots of bench space and large linen press.
- \* Outside we have a huge rear verandah area with tiled floors & trendy blinds ideal for entertaining all year round.
- \* There is plenty of car accommodation with a carport under the main roof and space at the side for extra vehicle, boat or trailer and a large double garage.
- \* The gardens are are easy maintenance and have established fruit trees.
- \* Extra features include 3 KW, 12 solar panel system, solar hot water, trendy blinds to front verandah, beautiful new floating floors and reverse cycle ducted air conditioning throughout the home.

3 BED | 1 BATH | 3 CAR

#### PRICE:

\$440000 - \$470,000

#### OPEN FOR INSPECTION:

N/A



**Terry Webster**

**0419993357**

[terrywebster@atrealty.com.au](mailto:terrywebster@atrealty.com.au)

[www.atrealty.com.au](http://www.atrealty.com.au)

RLA: 269823

12 Knightsbridge Road  
VALLEY VIEW

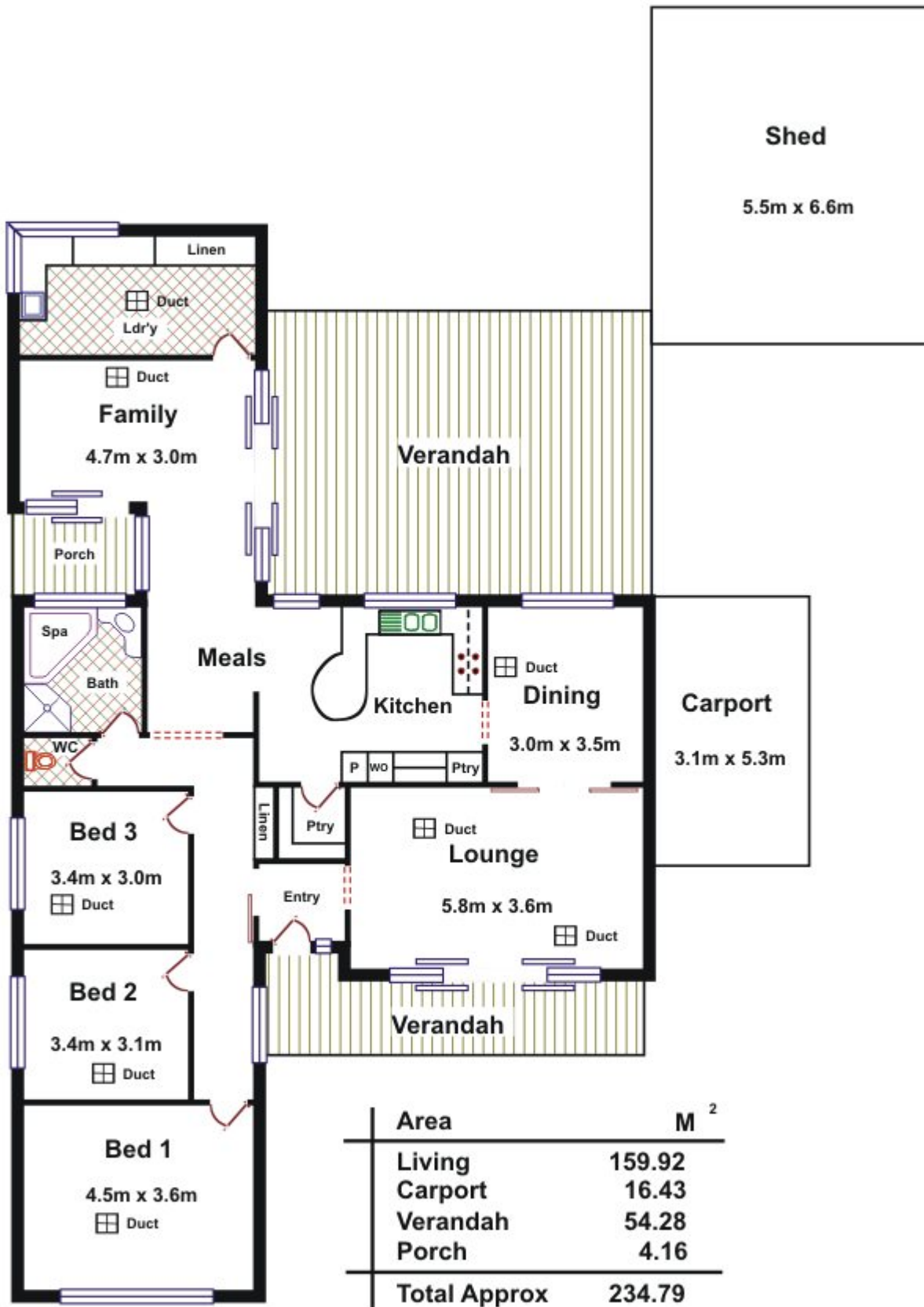

Area	M <sup>2</sup>
Living	159.92
Carport	16.43
Verandah	54.28
Porch	4.16
<b>Total Approx</b>	<b>234.79</b>

Disclaimer: Please note this floor plan is for marketing purposes and is to be used as a guide only. All dimensions are estimates only and may not be exact measurements.

layout and location of the property. Please check with local council that all structures are approved by council.