

**SOLD**

## FANTASTIC DEVELOPMENT SITE OR INVESTMENT !

- \* Large approx 778 sqm allotment with approx 19.5 metre frontage and potential to sub-divide STCC .
- \* Home comprises, three bedrooms, gas heating & ducted air conditioning.
- \* Outside there is a verandah, two large garages plus two large sheds.
- \* Close to all facilities and only approx 20 minutes drive to city.

**3 BED | 1 BATH | 1 CAR**

**PRICE:**  
\$365,000

**OPEN FOR INSPECTION:**  
N/A



**Terry Webster**  
**0419993357**  
terrywebster@atrealty.com.au  
[www.atrealty.com.au](http://www.atrealty.com.au)  
RLA: 269823

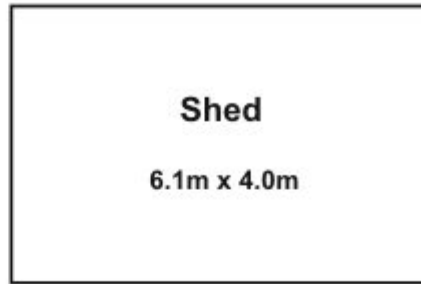
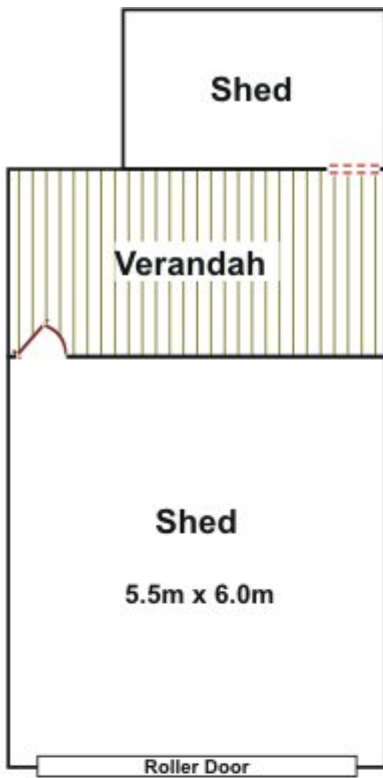

Area	M <sup>2</sup>
Living	105.00
Verandah	64.23
<b>Total Approx</b>	<b>169.23</b>

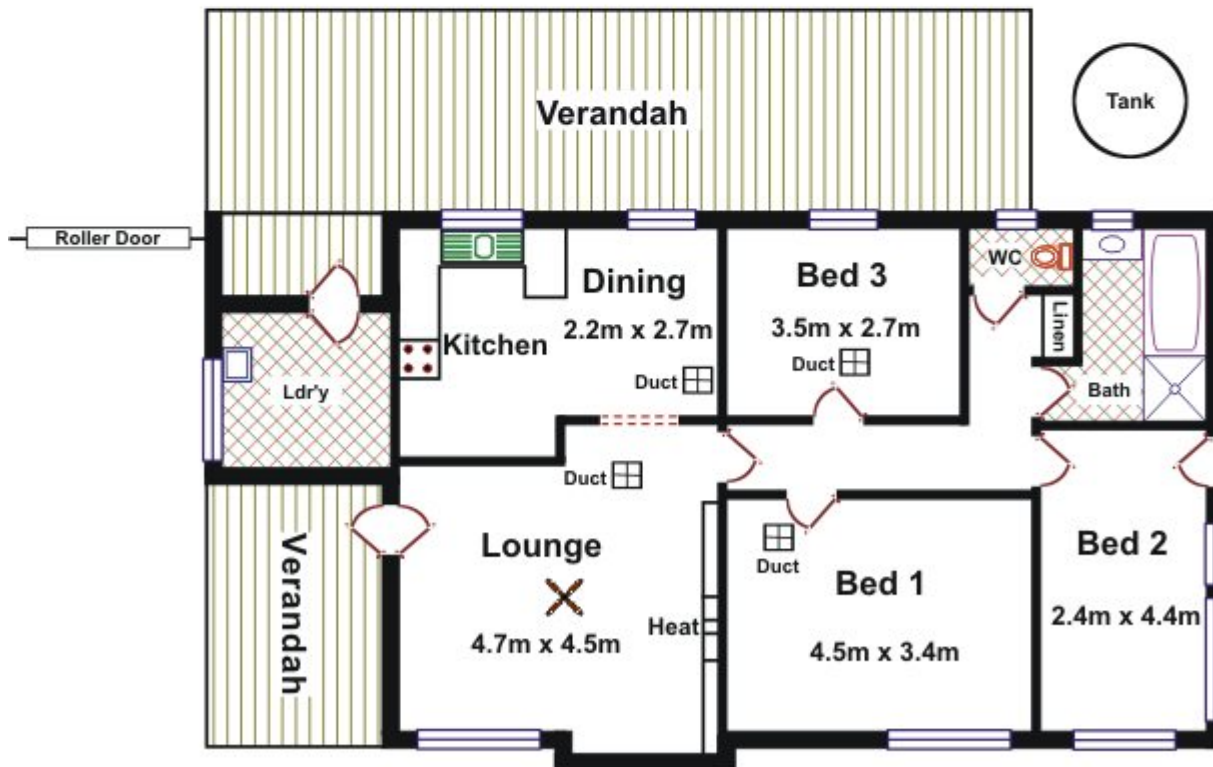

Disclaimer: Please note this floor plan is for marketing purposes and is to be used as a guide only. All dimensions are estimates only and may not be exact measurements.

illustration purposes only and intending purchasers should satisfy themselves independently regarding sizes, layout and location of the property. Please check with local council that all structures are approved by council.