



SOLD

OCEAN FRONT BLISS, YOUR NEW HOME!

Are you ready to live the life you deserve?

Hear the waves in the cove and enjoy the fresh sea breeze as you watch the dolphins dance from your stunning hardwood deck.
Totally purpose built, and constructed from solid Silver Top Ash.

Fancy a swim in the crystal clear water, or a relaxing walk to Mermaid Pools on Berrara's beautiful white sandy beach?
Your access is less than a minute walk across the road. When your done and feel its time to rinse the sand off, feel revived again with your own fresh water shower out the back.

Could it get any better?
Yes.

When the sun sets and the stars and moon emerge over the ocean, you'll have the best seat in the house to relax and take in the view that some only ever get to dream of.

No expense has been spared in lovingly creating this perfect family ocean escape!
If it's your place of residence or your holiday home for the moment, what a surreal experience!

Just too many incredible features to list.
Quality fixtures and fittings adorn this home, it is truly magnificent in design and wonderful in it's proportions.

Such a rare offering, with an absolutely perfect location this diamond on the coast must be experienced to be truly appreciated!
With 4 generous bedrooms, 3 bathrooms and plenty of living options this family home really does have it all!
Property has ample parking for 6 vehicles, two in the double garage and four in the two driveways.

The best part.... Enjoy your ocean views, never be built out!

Fortunate we are to have this property available to the market, in such an exclusive enclave surrounded by pristine coastline and national park, yet just a 3 minute drive to great boat ramps

4 BED | 3 BATH | 2 CAR

PRICE:
\$1,627,000

OPEN FOR INSPECTION:
N/A



Jessica Bruns
0430117048
pearlpropertyagents@atrealty.com.au
www.atrealty.com.au

5 Silver Sands Drive, Berrara

Jessica Bruns 0430 117 048

pearlpropertyagents@atrealty.com.au

PEARL PROPERTY AGENTS

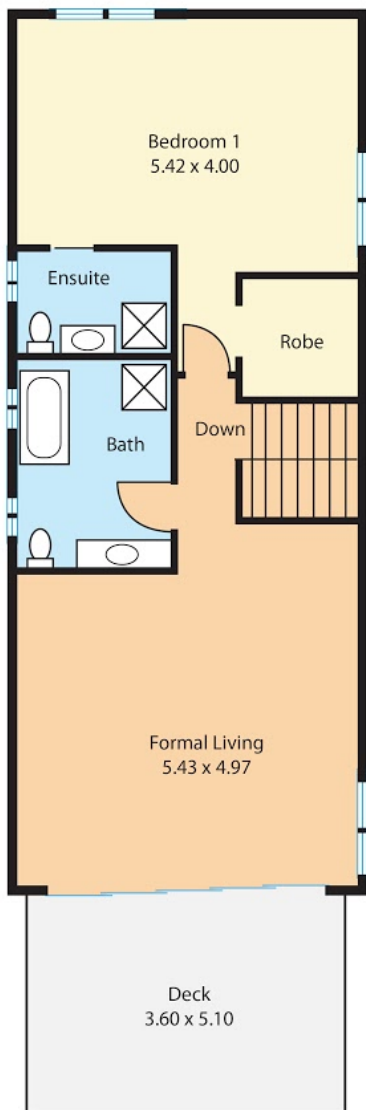

Upper Floor



Ground Floor

Disclaimer: Please note this floor plan is for marketing purposes and is to be used as a guide only. All dimensions are estimates only and may not be exact measurements.

Approximate Gross Internal Area = 239sq m (inc. Garage)

Please note: All dimensions give are approximate and for illustrative purposes only.

Jessica Bruns
0430117048

pearlpropertyagents@atrealty.com.au

www.atrealty.com.au

www.odigdesigns.com.au - LOGOS • FLOORPLAN/SITEPLAN REDRAWS • IMAGE ENHANCEMENTS

