



FOR SALE

ONE OF A KIND PROPERTY IN STUNNING LOCATION

This beautiful home is simply stunning and is presented in immaculate condition by the current owners. It is set on a generous 733sqm block in this tightly held pocket of Secret Harbour and offers spacious accommodation for all the family, including triple garage, gorgeous swimming pool and fantastic outdoor entertaining areas.

Accommodation briefly comprises;

- *Double doors into welcoming entrance hall
- *Large master bedroom with fantastic WIR & additional BIR, spacious en-suite and access to gorgeous private patio area
- *3 further guest bedrooms serviced by the recently renovated family bathroom
- *Practical laundry room with walk in linen cupboard
- *Gorgeous resort style casual living area, comprising family and sunken meals area with direct access to alfresco entertaining area
- *Stunning renovated kitchen with glass splash backs, solid timber bench tops, heaps of storage and stainless steel appliances
- *Separate large lounge room with access through bi-fold doors to decked alfresco area overlooking the extremely private backyard

The property also benefits from:

- *Ducted air conditioning throughout and a wood burning stove to the main living area
- *High ceilings in main living area, with a recently installed sky-light in family room
- *Rheem gas hot water system
- *Solar panels, 1.4kw, to help keep those utility bills down
- *Fantastic solar heated Magna swimming pool with glass pool fencing
- *Private back yard backing onto reserve
- *Under main roof alfresco area with built in BBQ
- *Additional patio areas perfect for relaxing and entertaining
- *Garden shed and triple garage with access to rear of property
- *Quiet cul de sac with beach footpath only meters away

This home will not last long and a viewing is an absolute must. Contact LISA DRYLIE for all enquiries.

4 BED | 2 BATH | 3 CAR

PRICE:
\$539,000

OPEN FOR INSPECTION:
N/A



Lisa Drylie
0433048512

lisadrylie@atrealty.com.au

www.lisadrylierealestate.com

22 Pulsano Mews SECRET HARBOUR



Block Size 733m² | 4 Bedrooms | 2 Bathrooms | 3 Car

Lisa Drylie | 0433 048 512

Internal 207.1m² | Garage/Alfresco 74.91m² | Total 282.07m²

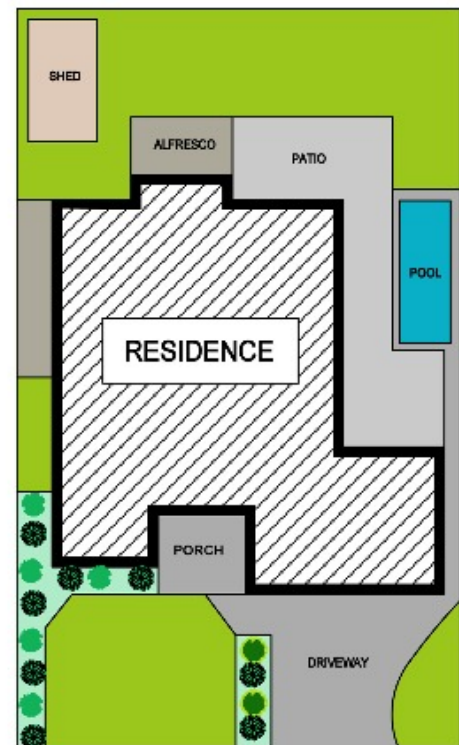

Disclaimer: Please note this floor plan is for marketing purposes and is to be used as a guide only. All dimensions are estimates only and may not be exact measurements.



REAL ESTATE FLOOR PLANS | houseguru.com.au | © 2017 House Guru Real Estate Photography™

Whilst every attempt has been made to ensure the accuracy of the floor plan contained here, measurements of doors, windows, rooms and any other items are approximate and no responsibility is taken for error, omission or mis-statement. This plan is for illustrative purposes only and should only be used as such by any prospective purchaser. The services systems and appliances shown have not been tested and no guarantee as to their operability or efficiency can be given.

Lisa Drylie
0433048512
lisadrylie@atrealty.com.au
www.lisadrylierealestate.com

