



SOLD

STYLISH HOME WITH BUSHLAND BACKDROP

Presenting to the market this sophisticated Five Bedroom lowset home in the prestigious estate of Eatons Rise situated on a generous 1000m2 fully fenced block backing onto the native reserve for that extra slice of privacy. This home really is a must see with extras including but not limited to Saltwater Inground Swimming Pool, Solar Panels – 5KW, Water Tank, Air-conditioning, Modern Kitchen with Caesar Stone Benchtops, Crimsafe Screens and Swann Security Camera System.

As you enter through the impressive double door entry you will feel the ambience this home has to offer, high ceilings adding to the homely feel and a corridor leading you to either side of the home and living areas. With three living spaces to choose from every member of the family will be catered for. A movie in the media room? Quiet reading time in the lounge? Teenagers playing on the Xbox or younger children enjoying the toyroom which is separate from the main hub of the home.

You will love the position of the galley style gourmet kitchen with convenience of the breakfast bar and meals area creating the hub of the home, somewhere the family will come together at the end of the day and catch up on the days happenings, homework etc. The chef of the family will enjoy cooking up a storm in this modern kitchen with quality stainless steel appliances, walk in pantry and Caesar Stone bench tops.

The oversized air-conditioned Master Suite is situated with the outlook over the pool to the tranquil bushland, imagine waking up to the sounds of the native birds in the morning. Offering a spacious ensuite with a relaxing corner Spa, double shower and his and hers vanity with stone benchtops, and a walk-in robe to die for! Bedrooms two, three and four all spacious in size offer built in robes, ceiling fans and air-conditioning. Bedroom five offers the opportunity of that spare bedroom or perfect home office also being oversized, built in wardrobe and fan.

With location, style and class this home will not last. Don't delay call Natalie today on 0419 689 309.

At a Glance:
1,000m2 Fully Fenced Block
Solar Panels – 5kw
Saltwater Swimming Pool

5 BED | 2 BATH | 2 CAR

PRICE:
\$806,000

OPEN FOR INSPECTION:
N/A



Natalie Johnston
0419689309
natalie@atrealty.com.au
[Natalieatrealty](#)

Whilst every attempt has been made to ensure the accuracy of the floor plan contained here, measurements of doors, windows rooms and any other items and structures are approximate and no responsibility is taken for any error, omission or mis-statement. Bathroom and kitchen fittings, cupboards and door types and laundry appliances and windows are tokens and approximate the actual fitting installed.
This plan is for illustrative purposes and should be used as such by any prospective buyer.
Plan drawn by Eagle Eye Photography Service, www.eagleeyeHQ.com.au Copyright 2019.
All rights reserved.
No reproduction without license, contact photographer for more information.

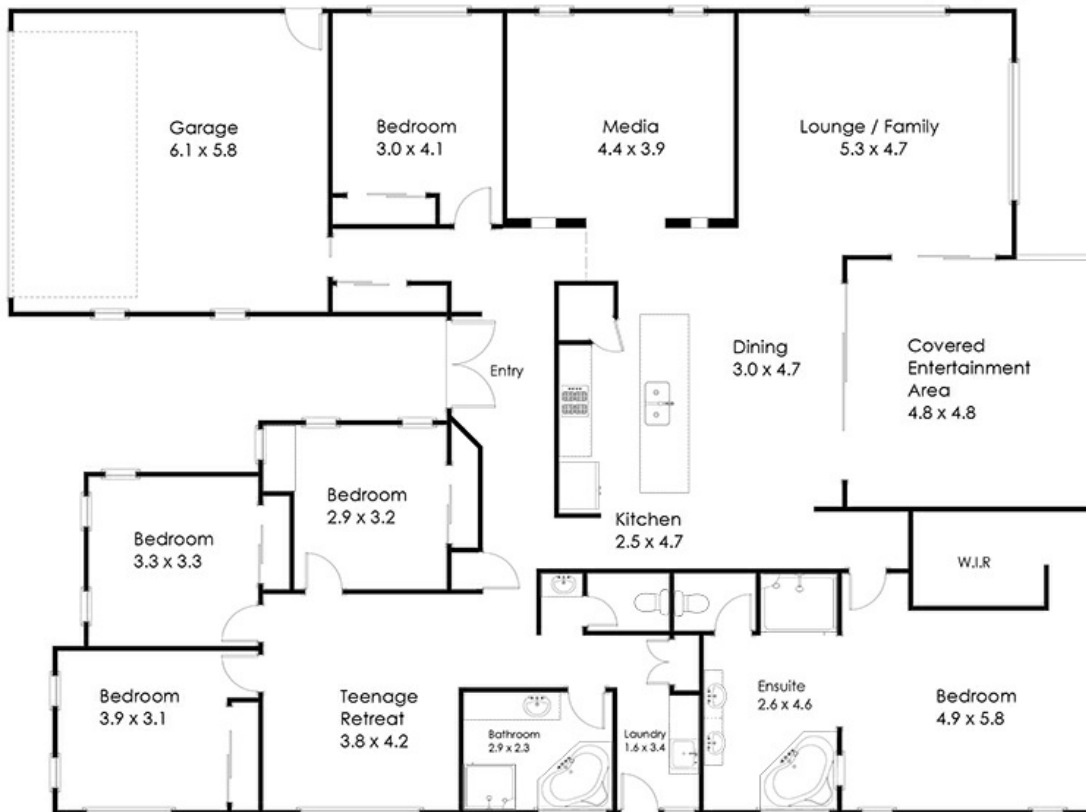

38 Riversleigh Crescent, Eatons Hill 4037

@realty

Disclaimer: Please note this floor plan is for marketing purposes and is to be used as a guide only. All dimensions are estimates only and may not be exact measurements.

Natalie Johnston
0419689309
natalie@atrealty.com.au
Natalieatrealty

@realty