

SOLD

STUNNING EXECUTIVE HOME ! TOTALLY IMPRESSIVE !

- * If you are in the market for a quality residence situated in a highly desirable location amongst other quality homes with lovely views to the city, then look no further !.
- * This is truly the ultimate family entertainer you can entertain in style with a sparkling fully fenced in-ground pool and fantastic huge gabled entertaining area with heaters and new quality weather proof blinds.
- * The home has a beautiful modern updated kitchen with stainless steel appliances, dishwasher, huge pantry and tons of cupboards (Mum will Love it !)
- * Spacious formal lounge/dine with fireplace.
- * Four roomy bedrooms all with built-in robes, the main bedroom has a trendy new ensuite and huge mirrored robe.
- * There is plenty of heating and cooling with ducted air conditioning throughout the home plus r/c split system air conditioners in both the lounge and main bedroom.
- * The family/meals area is spacious and has sliding doors leading out to the entertaining area.
- * The main bathroom is trendy, updated and has spa, the laundry is well appointed with tons of bench space, built-in cupboards and linen press.
- * There is plenty of undercover parking with a generous sized double garage on the lower level of the home with cellar/storeroom and two auto roller doors. There is also a 2--3 car carport with auto roller door and single garage at the side of the home ideal for boats, trailers or extra vehicles.
- * This is definitely a home for the discerning buyer who is looking for a quality built well finished immaculate property.
- * Call Terry Webster for further details or a private inspection on 0419 993 357

4 BED | 2 BATH | 4 CAR

PRICE:
\$596,000

OPEN FOR INSPECTION:
N/A



Terry Webster
0419993357
terrywebster@atrealty.com.au
www.atrealty.com.au
RLA: 269823

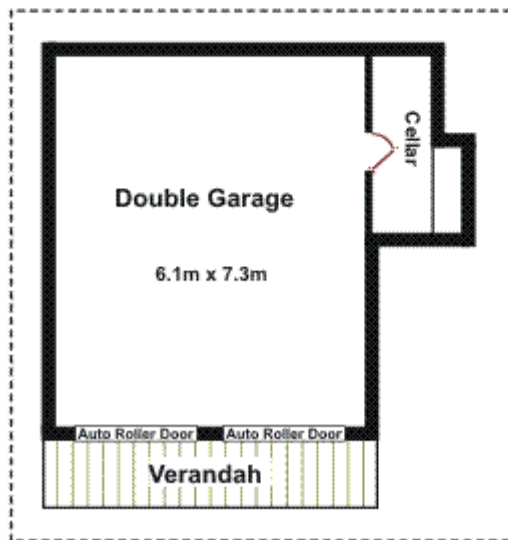

Garage Under Lounge

Area	M ²
Living	178.15
Garage Level	57.86
Carport	34.24
Verandah	55.02
Balcony	27.86
Total Approx	353.13

Disclaimer: Please note this floor plan is for marketing purposes and is to be used as a guide only. All dimensions are estimates only and may not be exact measurements.

The owners, instructor nor the Agents accept responsibility for errors or omissions. This sketch is for illustration purposes only and intending purchasers should satisfy themselves independently regarding sizes, layout and location of the property. Please check with local council that all structures are approved by council.