



SOLD

SPACIOUSLY PERFECT FOR YOUR FAMILY

VENDOR SAYS SELL SELL SELL!

Contact me for private inspection: 0468 482 443

The moment you step inside this wonderful home you will be impressed by its large welcoming open hallway, modern facade & functional floor plan, this feature-packed home is one that will surely tick all the boxes who inspect it.

This home's light & bright interior comprises 4 large bedrooms, plus study, master with walk-in robe and a ensuite his/hers basin with double shower & others with generous wardrobe space and private central main bathroom, spacious living zones including an expansive open-plan family/dining complemented by well appointed Kitchen hosting 900mm stainless steel appliance, caesarstone grand island benchtop with breakfast table, walkin pantry, adjoining meals area leading to a sensational covered alfresco & low Maintenance backyard with space to play with kids.

Extras Include:

- Ducted heating
- 5KW solar panels
- 900mm Five burner Cooktop
- 900mm Oven
- Upgraded Day/Night Blinds
- Dishwasher
- Front and back landscaping
- Remote control double garage
- High Ceilings
- Downlights to hallway, kitchen, meals and living
- Elegant floating boards to hallway, kitchen, meals and living
- Quality Carpets to Bedrooms

This home is well located bordering Berwick next to Minta Farm (Berwick) and Crica & Berwick Waters (Clyde North),

Walking distance to the following schools:
- Hillcrest and Rivercrest Christian schools

5 BED | 2 BATH | 2 CAR

PRICE:
\$562,500

OPEN FOR INSPECTION:
N/A



Fahim Safi
0468482443
fahimsafi@atrealty.com.au
www.atrealty.com.au

42 Belcam Cct, Clyde North

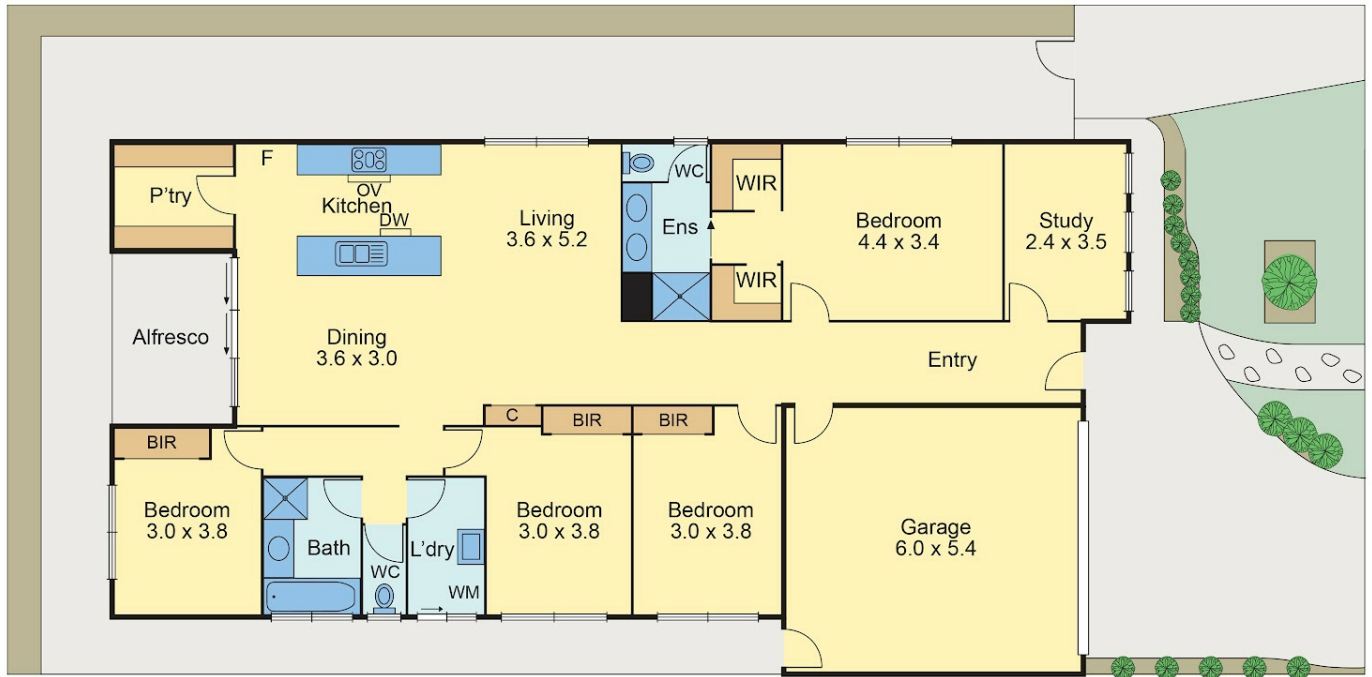

All measurements are in metres. This plan is not to scale and provided as marketing material. All measurements are approximate and for illustrative purposes only. We make no guarantee of the accuracy of the plan, and you should independently determine the suitability of the property for your requirements.

Disclaimer: Please note this floor plan is for marketing purposes and is to be used as a guide only. All dimensions are estimates only and may not be exact measurements.