



FOR SALE

NEAT AND SWEET

Contact your local agent Tricia 0457314206

Options are aplenty, if you're starting out, downsizing or looking for that perfect investment, this could tick your boxes.

A large lounge with picture window and polished floor boards leading to 3 good sized bedrooms. The master bedroom has built in robes and is conveniently located close to the bathroom and separate laundry.

An updated kitchen with plenty of cupboard and bench space overlooks the dining area with direct access to the private backyard with plenty of room for children and the family pets. The undercover pergola is a great place for a family get together. A lock up garage, garden shed, heating and cooling are just some of the many extras on offer. Located in a beach side suburb and with the esplanade within reach. Close to Seaford Shopping Center, Seaford Meadows railway station, schools and child care centres.

You could be the lucky one.

Block size 759m2 app

3 BED | 1 BATH | 1 CAR

PRICE:

332,000-352,000

OPEN FOR INSPECTION:

N/A



Tricia Kernahan

0457314206

tricia@atrealty.com.au

tfkrealestate.com.au

RLA: 269823

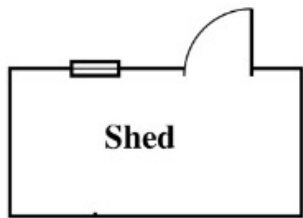

13 Koonya Road, Seaford

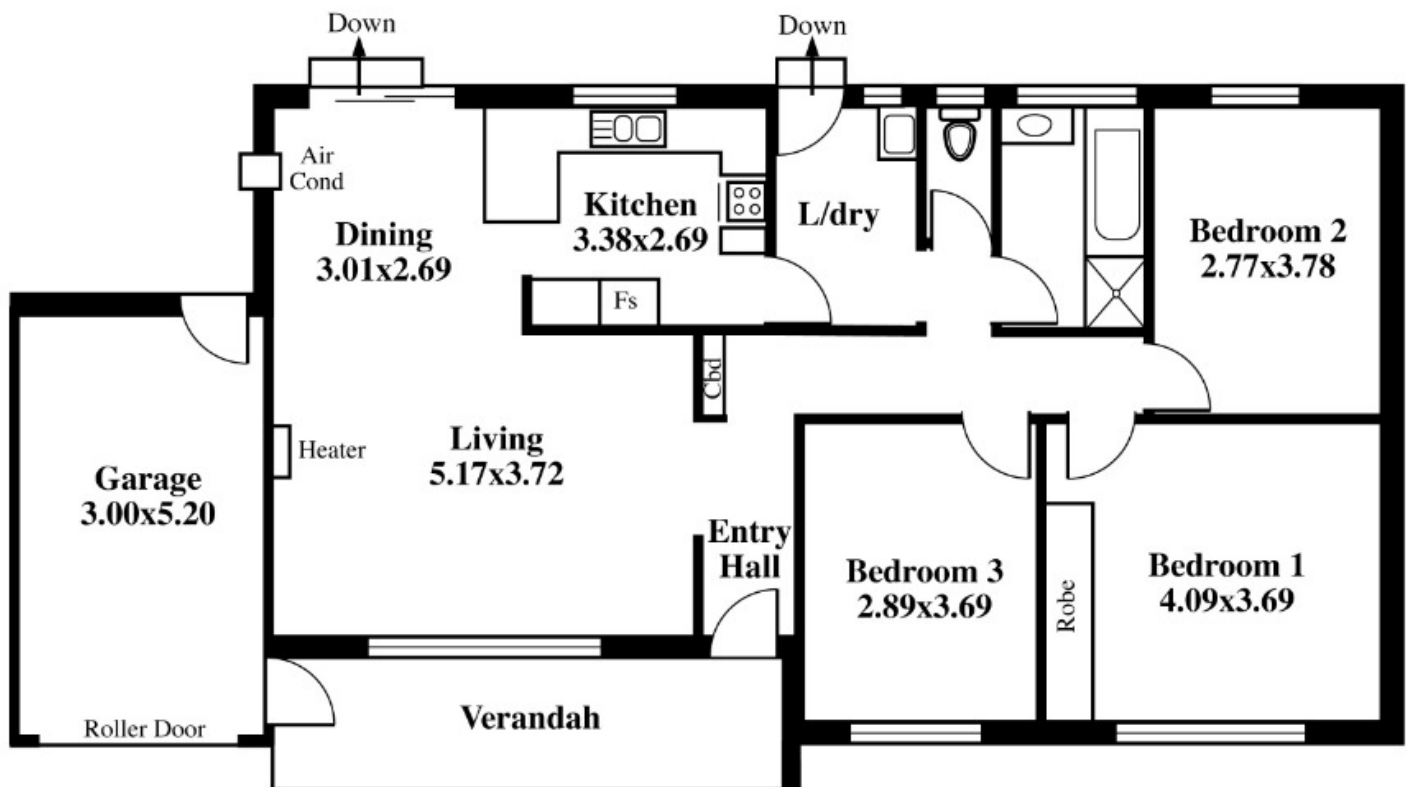
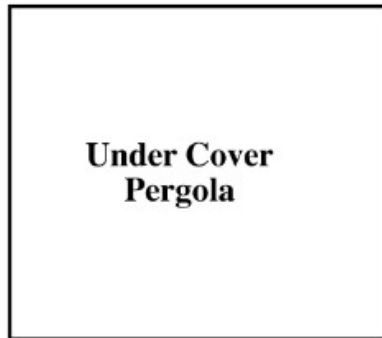

Desk Top Image - (Y0519-27)

TOTAL AREA: (Estimate Only)	122.40 m squ / 13.15 sqs Living Area Only
--------------------------------	--

Disclaimer: Please note this floor plan is for marketing purposes and is to be used as a guide only. All dimensions are estimates only and may not be exact measurements.

All measurements are approximate and details intended to be relied upon should be independently verified.