

7/60 WHITBY STREET **SOUTHPORT**



FOR SALE

SPACIOUS TOWNHOUSE, IDEALLY LOCATED!

Ideally located in the well maintained Southport Palms complex, this pet friendly Townhouse offers lots of space and privacy. Backing onto Owen Park with sports club around the corner, St Hilda School, Southport State and tram line all within minutes walk... this property truly has LOCATION!! Great rental returns, absolutely must view, make an offer.

- . 2 large Bedrooms, both with built-in robes and floorboards.
- . Pet friendly complex
- . Air conditioned open Plan Kitchen, Dining and Lounge.
- . Spacious bathroom with spa bath and 2 seperate toilets.
- . Seperate laundry, Single Carport.
- . Private courtyard backing onto ...
- . Cabling for Foxtel, Internet (NBN or ADLS2+)
- . Beautifully maintained complex security gated with with tropical gardens , large pool, spa and Gazebo Area.

This property could rent in the range of \$390-\$400 per week

Inspect by appointment, email, call or text Audrey on 0412 148 078. Property currently tenanted. Tenants will be vacating soon.

2 BED | 1 BATH | 1 CAR

PRICE:

Offers over \$280,000

OPEN FOR INSPECTION:

N/A



Audrey Goetz

0412148078

audrey@atrealty.com.au

www.atrealty.com.au

7/60 Whitby Street, Southport

2 1 1

lower: 48m² | upper: 48m² | courtyard: 27m² | total: 123m²



Audrey Goetz 0412 148 078

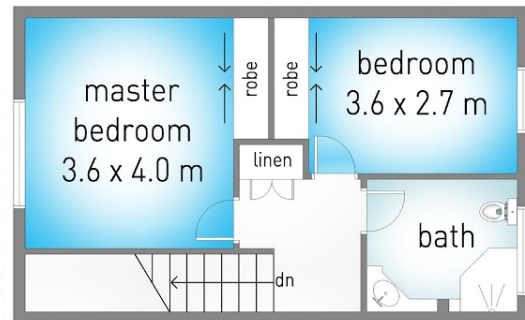
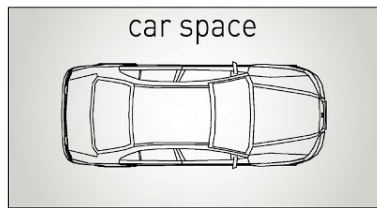

upper level

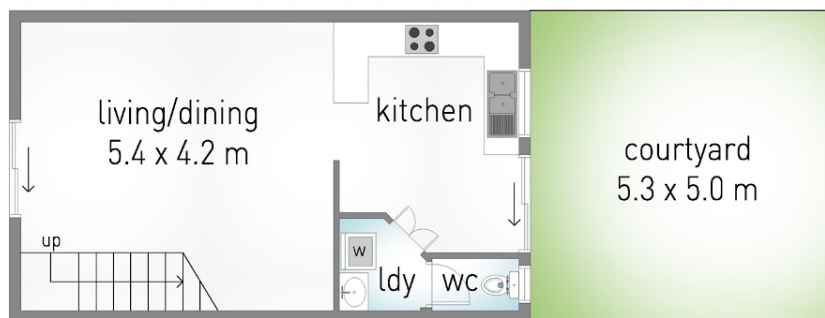

lower level

realimage media
PROPERTY PHOTOGRAPHY + DIGITAL MEDIA

Dimensions are approximate. All information contained herein is gathered from sources we believe to be reliable. However we cannot guarantee its accuracy and interested persons should rely on their own enquiries.

Disclaimer: Please note this floor plan is for marketing purposes and is to be used as a guide only. All dimensions are estimates only and may not be exact measurements.