



# SOLD

## SOUGHT AFTER OPEN FLOOR PLAN ! PRICED TO SELL !

Enjoy Broadwater living at its best in this 6th floor contemporary apartment, offering spectacular 180-degree panoramic Hinterland views. Silvershore is situated opposite the sandy Broadwater foreshore and with the current owners superb upgrades this modern apartment has it all.

This great apartment is flooded with natural light. The modern entertainer's kitchen has mirrored + subway tile splashbacks, stainless steel appliances, gas cook top. Plus the current owner has installed a large island bench with stone waterfall bench-tops, wine rack plus space for a wine fridge.

The spacious open plan living/dining area leads out to an extremely large private balcony that is ideal for entertaining or to simply sit back, relax with a glass of wine and enjoy the sunset views from the spacious balcony.

The master bedroom leads directly out to the spacious balcony by floor to ceiling patio doors and has walk through wardrobes through to the en-suite bathroom and ceiling fan. Bedroom 2 has a full wall of mirror-fronted wardrobes for maximum storage.

This modern apartment is positioned on Marine Parade with direct access to the Broadwater, walkways and parks and is only a stroll to restaurants and cafes, amenities and shops, Easy access to Griffith University, Gold Coast University Hospital, and Runaway Bay Shopping Centre and Harbour Town for outlet shopping.

Apartment Features include-

- Spacious open plan lounge/dining flowing to huge undercover entertainers balcony with 180 degree views to the Hinterland
- Modern gourmet kitchen, with s/s appliances, gas stove, stone bench-tops and large island bench with wine rack and space for a wine fridge. Mirrored and subway tile splash-backs.
- 2 way en-suite bathroom
- Bedroom 2 with full width mirror wardrobes
- European laundry
- Built in walk through robes
- Ducted air- conditioning and ceiling fans throughout

2 BED | 1 BATH | 1 CAR

PRICE:  
\$330,000

OPEN FOR INSPECTION:  
N/A



**Francine Setchell**  
**0408143464**  
francine@atrealty.com.au  
[www.atrealty.com.au](http://www.atrealty.com.au)

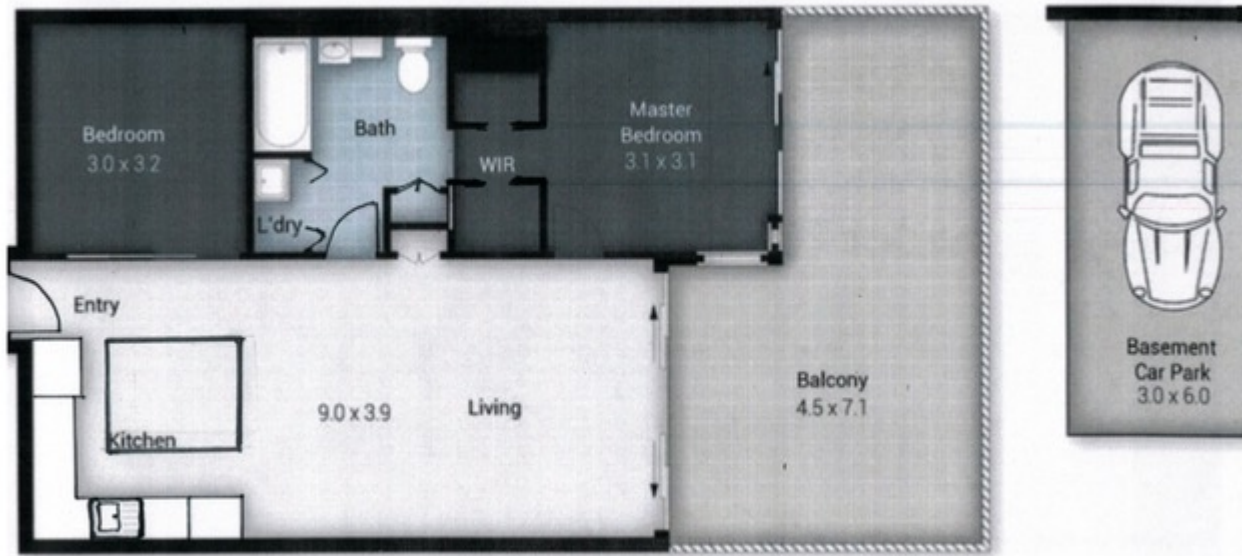

Disclaimer: Please note this floor plan is for marketing purposes and is to be used as a guide only. All dimensions are estimates only and may not be exact measurements.