



**SOLD**

## WHY BUILD? AS NEW 4 BEDROOM FAMILY HOME READY TO GO AWAITING A NEW FAMILY!

This as new 4 bedroom, 2 bathroom home has the lot, built-ins in all bedrooms, master bedroom with walk in robe and ensuite, bright and sunny dining and lounge rooms all on a very flat 734m2 allotment amongst new homes in popular Brighton Estate.

Located 30 minutes to Hobart, 25 minutes to Glenorchy and 2 minutes to all the amenities of Brighton – Medical centre, Pharmacy, Shops, Bakery, Butcher and Hotel.

Completed in 2018 by Tassie Homes this as new property features a 6+ star energy rating, double glazed windows throughout, insulated floors, walls and ceilings, Fujitsu Heat pump, led lighting, low maintenance brick walls & colourbond roof with driveway access to the rear of the property. The fully fenced backyard is a blank canvass ready for a shed, cubby house or outdoor entertainment area.

Ready to go near new homes are a rare find, let alone a 4 bedroom home in a new homes estate offering so much for the family. Please contact Ben Palmer for an inspection.

**4 BED | 2 BATH | 0 CAR**

**PRICE:**  
\$419,000

**OPEN FOR INSPECTION:**  
N/A



**Ben Palmer**  
**0417556731**  
benpalmer@atrealty.com.au  
[hobarthomes.com.au](http://hobarthomes.com.au)

Please note: measurements are approximate and are for reference only.

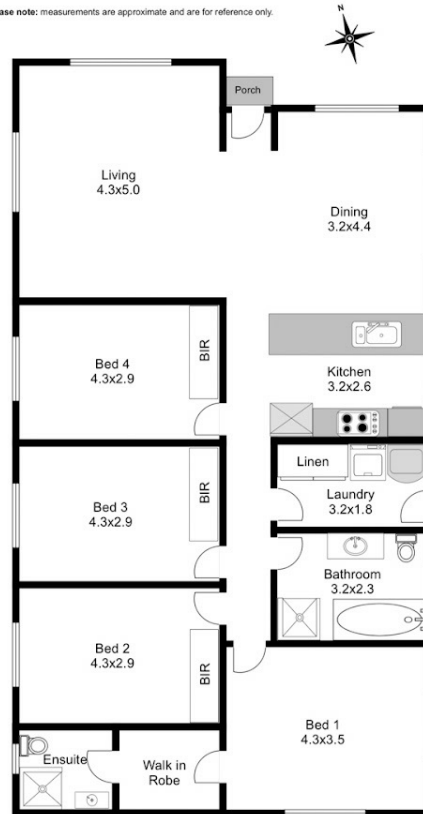

Disclaimer: Please note this floor plan is for marketing purposes and is to be used as a guide only. All dimensions are estimates only and may not be exact measurements.