



SOLD

STUNNING THREE BEDROOM PLUS STUDY WITH OCEAN VIEWS

This luxurious apartment features three bedrooms plus a study/multi media room and comes with the highest quality finishes including stone & marble bench-tops, Miele appliances, gas cook-top, ducted air-conditioning, large shuttered balcony, parking for two cars and separate basement storage.

Light bright and airy with a modern open plan living area featuring windows that frame this perfect coastal outlook and doors that open out onto a large balcony fitted with plantation shutters adding an informal living space to an already generous-sized apartment. Perfect for relaxing and entertaining.

"Ultra" is a 30 story luxury apartment high-rise located close to the patrolled beach and a leisurely stroll to Pacific Fair shopping centre as well as central Broadbeach restaurants and shops.

Features:

- Three large bedrooms plus study/multi-purpose room
- Light, bright & airy with beautiful ocean views
- Modern spacious open plan living with quality inclusions
- Large alfresco balcony with shutters for all weather comfort
- Gourmet kitchen with Miele appliances & gas cooktop
- Generous master with luxurious ensuite, built-ins & balcony access
- 2 side by side car spaces plus separate storage
- Pet friendly building
- Walk to the beach, shops & cafes

The facilities included will allow owners to live a lifestyle that will be envied by others.

These facilities include:

- Extensive water features throughout the grounds
- 25 metre heated lap pool, kids wade pool
- Tennis Court
- Teppanyaki BBQ Bar

3 BED | 2 BATH | 2 CAR

PRICE:
\$940,000

OPEN FOR INSPECTION:
N/A



Janet Harris
0404482240
janetharris@atrealty.com.au
www.atrealty.com.au

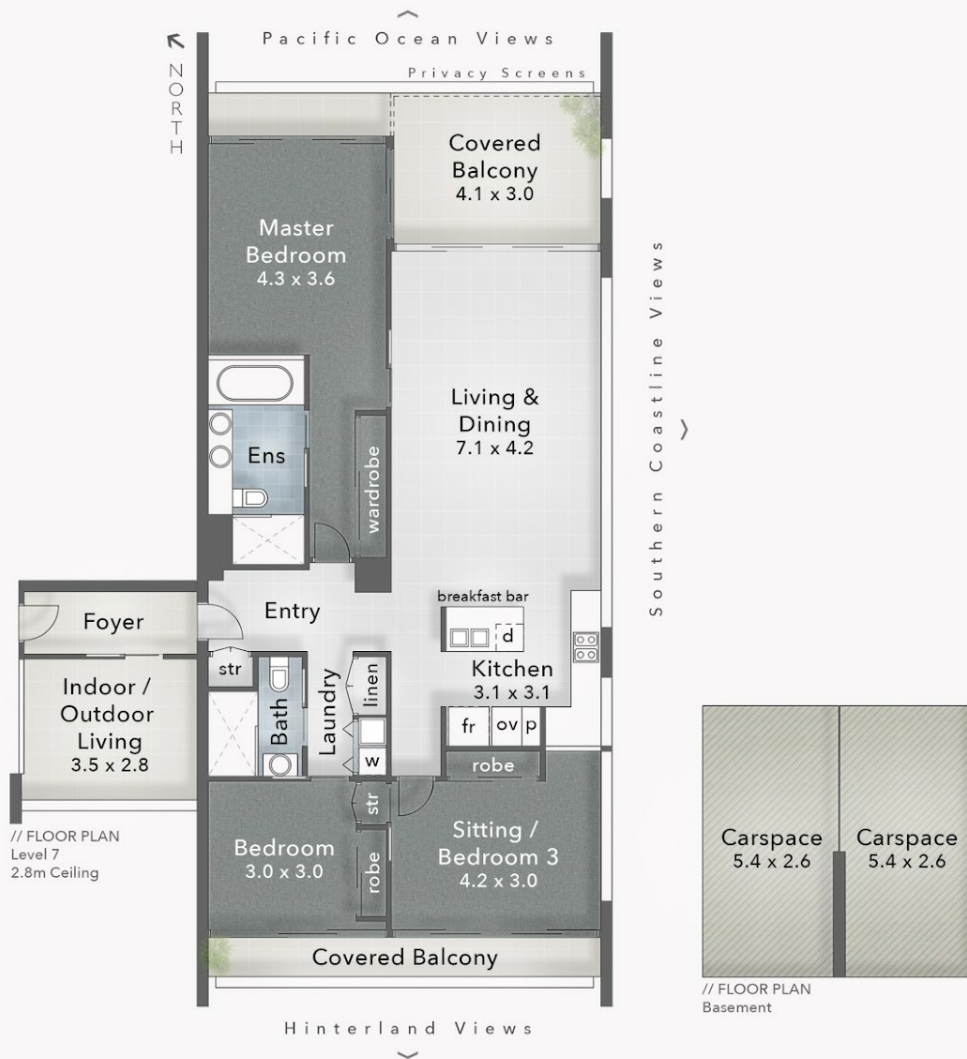

ULTRA BROADBEACH
705/14 George Avenue
BROADBEACH

- 3 Bed
- 2 Bath
- 2 Car + Storage Cage

FLOOR AREA SIZES

Internal 120m²
Balconies & Foyer 40m²
Total 160m² or 17 Squares
Carspaces 28m²

The overall presentation style, layout, imagery, fonts, background, colours and terminology are subject to strict copyright of Pure Design Concepts. No ownership is taken for building design. All measurements are approximate & individuals should rely on their own information. Find out more at: puredesignconcepts.com.au

puredesign CONCEPTS **PLANS FOR PURPOSE**

Disclaimer: Please note this floor plan is for marketing purposes and is to be used as a guide only. All dimensions are estimates only and may not be exact measurements.