

108/3 HEATHERBRAE AVENUE EAST RINGWOOD



FOR LEASE

BRAND NEW BEAUTY ON RINGWOOD EDGE!

Are you are looking for a brand new, sophisticated & convenient apartment living, in the heart of the Ringwood? Then, stop wasting your time. Come for our next open inspection and make this beauty yours :-)

Location is the key here. No more parking hassle in the morning at Ringwood station if you take the train to the CBD. Just walk from here. Walk to Costco and enjoy the savings while shopping. Eastland shopping centre, Ringwood square with a large variety of choices for you at walking distance too. This apartment is in the Ringwood secondary school zone if that matters to you. The east link can be accessed in 2 mins.

Featuring:

- Open plan living
- Split-system heating and cooling
- Lift access to all the floors
- Private secure storage unit with your secure underground parking slot
- stone benchtop & dishwasher
- Stainless steel cooking appliances
- Mirrored built-in robes in both bedrooms
- Ensuite
- European laundry
- Architecturally designed a beautiful building

A generous sized European laundry is neatly hidden. To complete the picture, you have your own private, large balcony with room for outdoor seating and a BBQ for your enjoyment. You wouldn't want to live anywhere else.

An inspection is a must, Be Quick! Call Nandana on 0452 611 234.

Please Note: Photo I.D. is required at all inspections.

** Inspection times and availability dates are subject to change or cancellation without notice. Please call Nandana on 0452 611 234 prior to the inspection to confirm availability. **

*Please Note: Images are from staged display apartments G01 & 205 only

2 BED | 1 BATH | 1 CAR

PRICE:

\$420 per week

OPEN FOR INSPECTION:

N/A



Nandana Peiris

0452611234

nandana@atrealty.com.au

Real Alliance

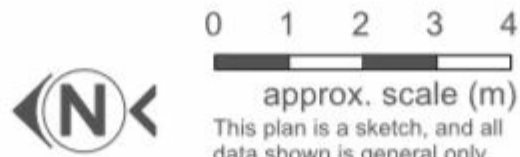

NB: All stated dimensions are approximate only & should not be taken as definite.

secure
basement
parking

(actual position not
shown to scale)

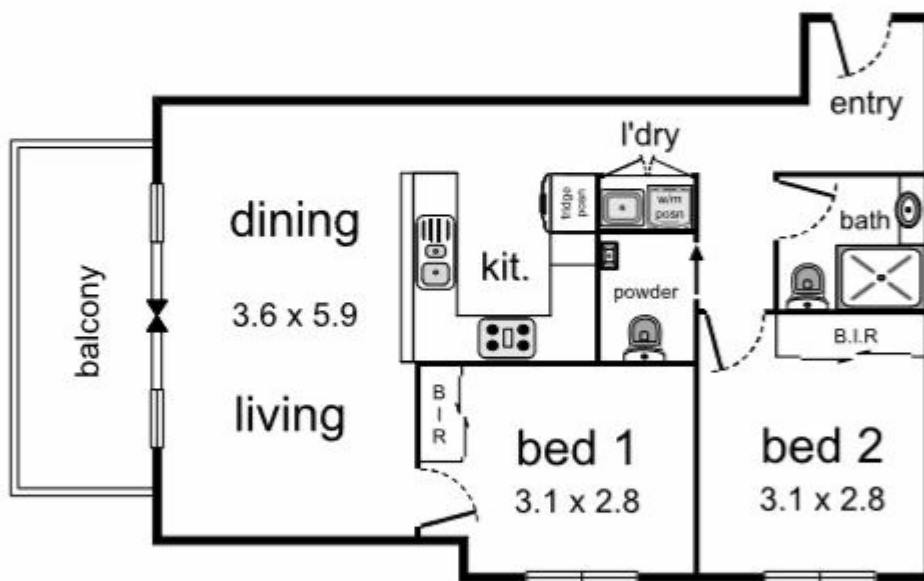

108 / 3 Heatherbrae Avenue Ringwood

Disclaimer: Please note this floor plan is for marketing purposes and is to be used as a guide only. All dimensions are estimates only and may not be exact measurements.