



SOLD

LIFESTYLE FAMILY LIVING

THIS IS JUST THE PERFECT HOME FOR THE GROWING FAMILY, WHO ARE LOOKING FOR THAT COUNTRY LIFESTYLE AND ROOM TO MOVE. SET ON A PARK LIKE ALLOTMENT, MEASURING 7,100 SQ/M AND LOCATED ON MOUNT GAMBIER'S CITY LIMITS, AND IS ONLY A STONES THROW FROM BLUE LAKES SPORTS PARK. THIS ARCHITECT DESIGNED HOME HAS FEATURES SUCH AS CATHEDRAL CEILINGS AND NORTH FACING WINDOWS CAPTURING THE NORTH WINTER SUN. OPEN LIVING KITCHEN MEALS FAMILY AREA, PLUS COMPUTER NOOK WITH STUNNING VIEWS OVER THE COUNTRYSIDE. THERE IS A LOUNGE ROOM/ PARENTS RETREAT, PLUS A CELLAR FOR YOUR WINES AND A ATTIC WHICH WOULD MAKE A GREAT HOME OFFICE. FOUR BEDROOMS WITH THE MAIN HAVING LARGE EN-SUITE WITH DEEP SPA BATH AND PRIVATE BALCONY. SPLIT SYSTEM AIR-CONDITIONING PLUS SLOW COMBUSTION KEEPS THE HOME THE RIGHT TEMPERATURE ALL YEAR ROUND. OUTSIDE THERE IS A DOUBLE CARPORT PLUS EXTRA STORAGE AND GARAGING. ALSO AWAY FROM THE MAIN HOUSE IS A GAMES ROOM IDEAL AS A MAN CAVE OR A PLACE FOR THE TEENAGERS. BORE WATER KEEPS THE GROUNDS GREEN ALL YEAR ROUND AND RAIN WATER SUPPLIES THE HOUSE. INSPECTION WILL IMPRESS

4 BED | 2 BATH | 3 CAR

PRICE:
\$445,000

OPEN FOR INSPECTION:
N/A



Peter Dempsey
0418854393
peterdempsey@atrealty.com.au
peterdempseyatrealty.com
RLA: 269823

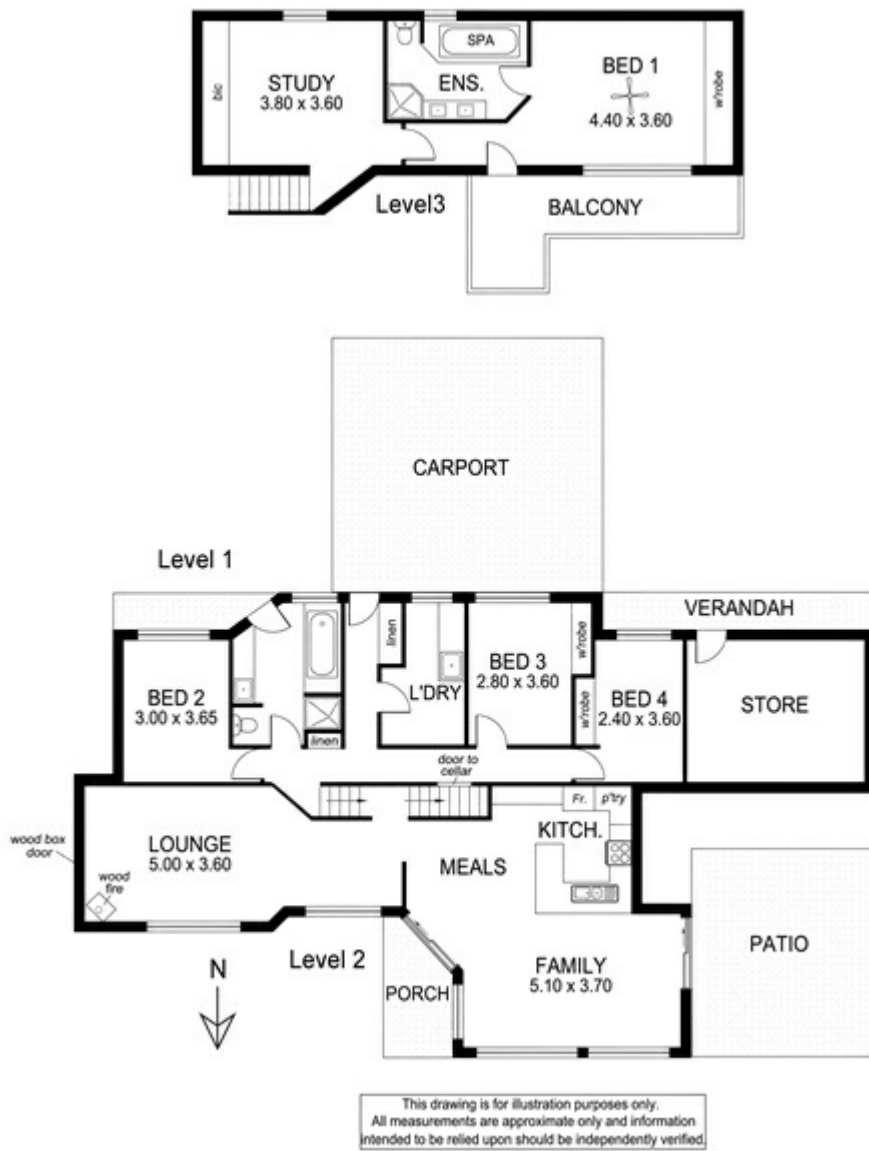

Disclaimer: Please note this floor plan is for marketing purposes and is to be used as a guide only. All dimensions are estimates only and may not be exact measurements.