



# SOLD

## THE ECO-FRIENDLY, EASY CARE LIFESTYLE PROPERTY.

This generously sized freestanding eco-friendly home is infused with space, light and family-friendly comfort. This residence simply exudes peace and harmony. If you've been searching for a place to call home with a big block and multiple spacious living areas, you can't go past this great value for money opportunity. This home is perfect for entertaining with easy access to the outdoor entertaining areas

The 4th bedroom area with one of the living areas would make a fantastic area for an elderly family member to move into to be cared for by you, teenager/adult living at home living space or an Air BnB space.

Enjoy the practicality of a brand-new kitchen & double glazed windows throughout. The home features 3/4 bedrooms with carpet and built-in wardrobes and 2 bathrooms. A covered entertaining area is a great addition to the fully secured backyard with space for the kids to play and pets to roam. The manageable-sized block of land provides plenty of room for a boat, caravan and has the ultimate man cave.

A picturesque rural view is just one of the many things this home has to offer

Insulated Brick home with Colourbond roof

Captivating garden views are a feature from many rooms within the home.

Extensive use of the large double-glazed windows brings natural light and a soothing bushland outlook into the home.

Air-conditioning and heating to living and bedrooms

New kitchen with brand name appliances

Ceiling fans throughout for summer comfort

Landscaped established gardens, including a vegetable patch, berries and fruit trees

Ducted air-conditioning & heating, solar panels, double glazed windows and insulated throughout

Lock up garage with workshop and storage

4 BED | 2 BATH | 8 CAR

PRICE:  
\$470,000

OPEN FOR INSPECTION:  
N/A



**Judy Allen**  
**0475224403**  
jallen@atrealty.com.au  
[www.atrealty.com.au](http://www.atrealty.com.au)

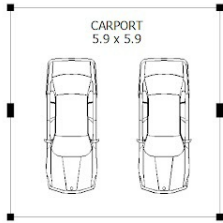

(NOT IN POSITION)

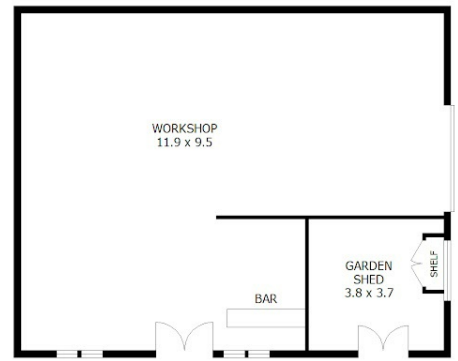

(NOT IN POSITION)



|              |                            |
|--------------|----------------------------|
| Residence    | - 181 m <sup>2</sup>       |
| Carport      | - 74 m <sup>2</sup>        |
| Porch        | - 24 m <sup>2</sup>        |
| Alfresco     | - 24 m <sup>2</sup>        |
| Entertaining | - 36 m <sup>2</sup>        |
| Workshop     | - 113 m <sup>2</sup>       |
| <b>Total</b> | <b>- 452 m<sup>2</sup></b> |



Scale in metres. Indicative only. Dimensions are approximate. All information contained herein is gathered from sources we believe to be reliable. However we cannot guarantee its accuracy and interested parties should rely on their own enquiries.

# 215 Sailors Gully Road, Sailors Gully

Disclaimer: Please note this floor plan is for marketing purposes and is to be used as a guide only. All dimensions are estimates only and may not be exact measurements.