



SOLD

INTERSTATE INVESTOR MUST SELL

This good sized unit is the perfect foot in the door for investors or homeowners looking for an easy to maintain property that is convenient to everything, without being on a main road.

Great rental return and low body corporate contribution.

Located on the top floor of a small block of 7 units, with its own car space.

Features:

- 'Blank canvas' ready for you to personalise
- Kitchen with stainless steel appliances and dishwasher
- Air conditioned living area
- Balcony off living area
- Bedrooms have built-ins

Key Distances:

- Train Station = 1.7km
- Westfield Chermside = 3km
- Brisbane CBD = 6km
- Entertainment Centre = 8.8km
- Brisbane Airport = 9.5km

Hesitation will lead to disappointment. Call today.

3 BED | 1 BATH | 1 CAR

PRICE:
\$301,000

OPEN FOR INSPECTION:
N/A



Peter Kramer
0431384289
peter@atrealty.com.au
www.atrealty.com.au

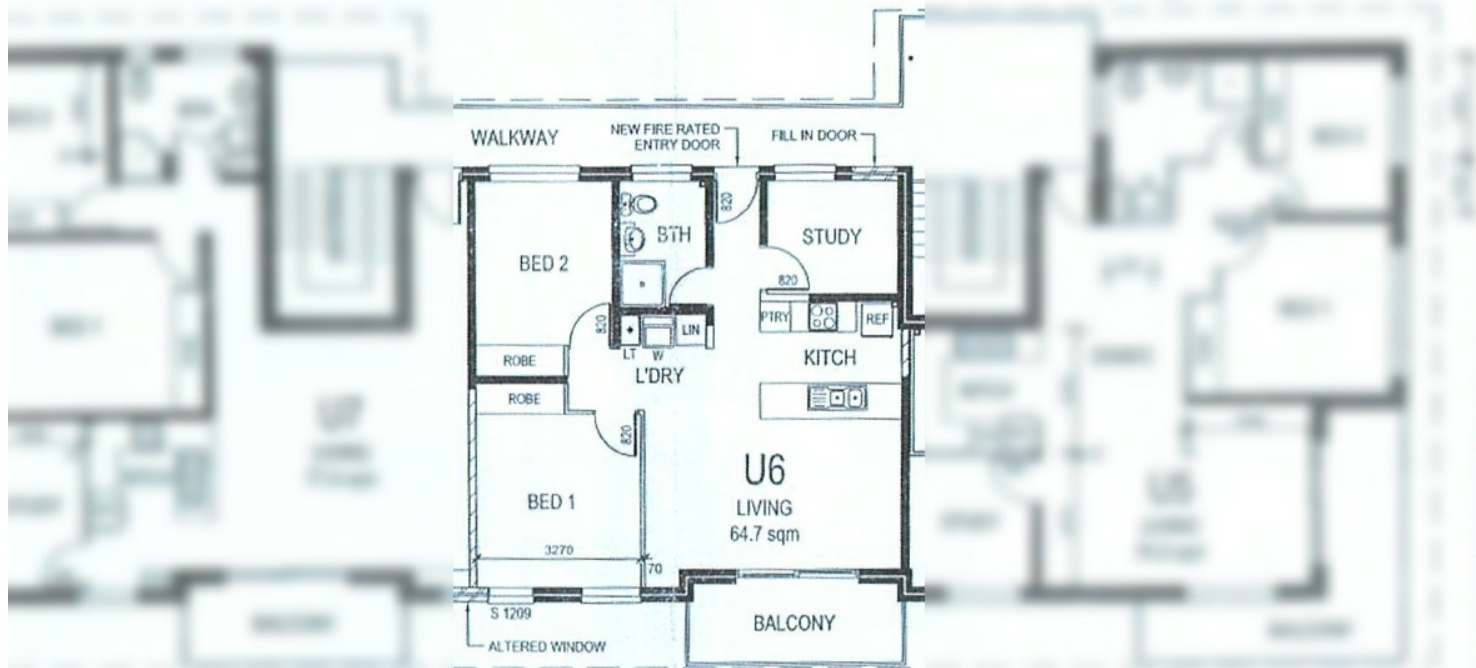

Disclaimer: Please note this floor plan is for marketing purposes and is to be used as a guide only. All dimensions are estimates only and may not be exact measurements.