



SOLD

IDEAL INVESTMENT ,1ST HOME OR RETIREMENT RETREAT !

- * Neat & tidy unit only a short drive to city.
- * Walk or ride your bike along the lovely Linear Park and River Torrens.
- * Close to schools and transport and the Marden Shopping Centre with all facilities.
- * Two roomy bedrooms with built-in robe to main bedroom.
- * Spacious formal lounge.
- * Kitchen/dine with pantry.
- * Rear yard with verandah.
- * Beautiful floating floors.
- * Car park & large shared lawn area for the kids to play.
- * Currently tenanted until 21st October 2019

2 BED | 1 BATH | 0 CAR

PRICE:
\$190,000

OPEN FOR INSPECTION:
N/A



Terry Webster
0419993357
terrywebster@atrealty.com.au
www.atrealty.com.au
RLA: 269823

| Area | M ² |
|---------------------|----------------|
| Living | 71.49 |
| Verandah | 21.08 |
| Total Approx | 92.57 |

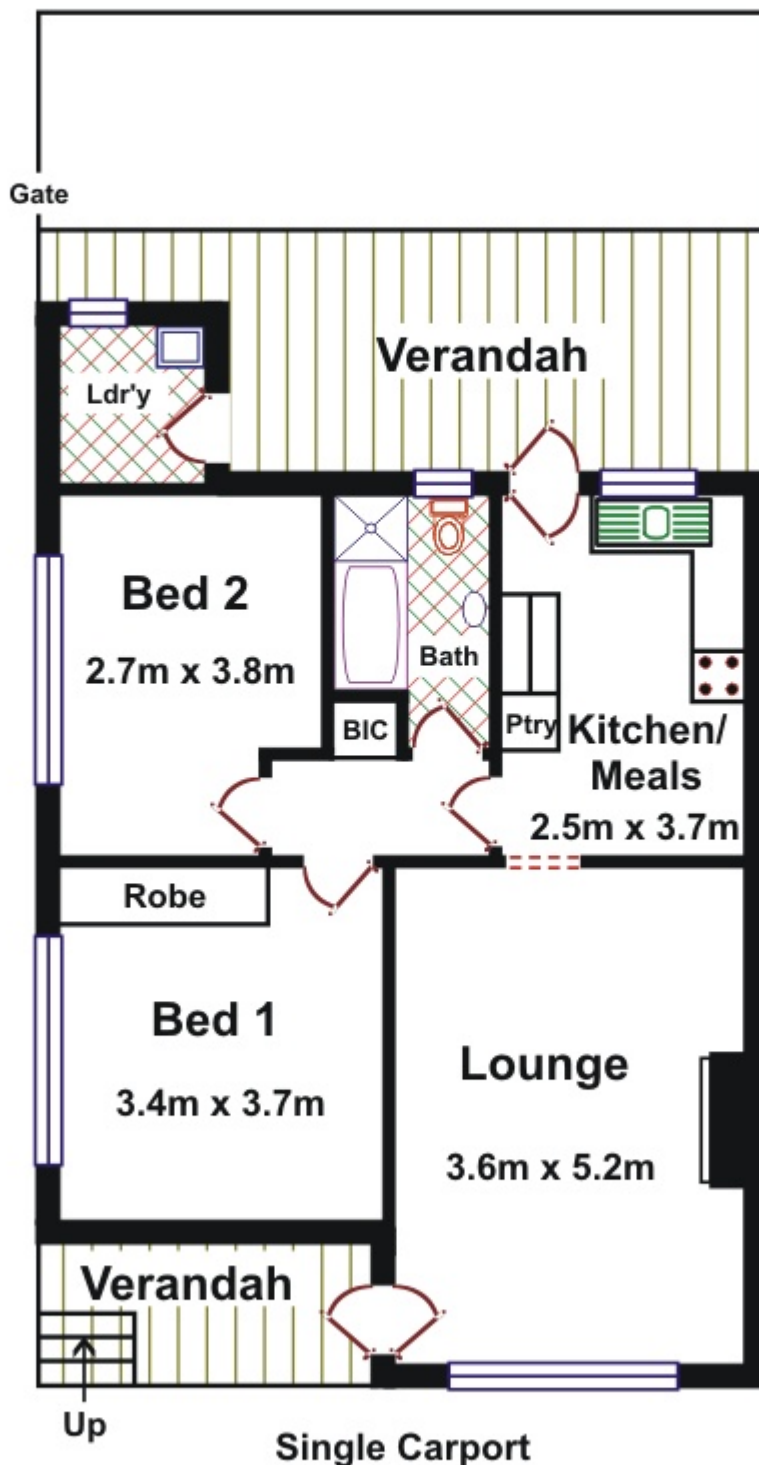

Please Note: Every care has been taken to verify the correctness of the areas and details used in this leaflet

Disclaimer: Please note this floor plan is for marketing purposes and is to be used as a guide only. All dimensions are estimates only and may not be exact measurements.

illustration purposes only and intending purchasers should satisfy themselves independently regarding sizes, layout and location of the property. Please check with local council that all structures are approved by council.