

# FOR SALE

## ONE ACRE OF AMAZING PRIVACY

Ian & Janelle Pye are your local Gympie Agents.

This magnificent 1-acre property provides a most private and idyllic location for an unbelievable lifestyle just a few minutes' drive to the heart of Gympie.

The home has been designed to exist harmoniously with Mother Nature and makes the most of leisure living by bringing in as much of the outdoors as possible including stunning views of the surrounding bushland. These sorts of designs are hard to come by - but look no further if you're hunting for a solution to really enjoy acreage living with all the added bonuses of being in suburbia.

The open plan design of the home provides everything and more for the family that loves to entertain with big social gatherings or simply wants room to spread out and move around. Even in the private areas of the home, the space continues, with a large walk behind robe in the master bedroom; built-ins for each of the other bedrooms.

This is a home for a lifetime, dedicating its heart to a relaxed lifestyle. The kitchen is very well-appointed with quality appliances including dishwasher.

With the natural beauty of the landscape, it's changing light and rich colours, why hang a picture when the windows allow images of nature like this? All the main rooms in this home feature a window or a clear line of sight to the outdoors, giving you a backdrop of lush trees, snippets of sunset and lengths of lovely light flooding into your home. Relaxing on either of the large covered decks provides a view of nature that you immerse yourself within.

Take the time to inspect this excellent property either at the open homes or by private appointment. You need to inspect to really appreciate the ambience the property exudes including the local birdlife.

Features: 10 Vanessa Court

- \* Master bedroom with Ensuite and Walk-in Robe
- \* Bedroom with Built-in-Robe
- \* Kitchen inc Dishwasher
- \* Split System Air-Conditioning
- \* Ceiling Fans
- \* Large Living Area
- \* Solar Electricity System
- \* Solar Hot Water
- \* Garden Shed
- \* Carport
- \* NBN Internet Connection

3 BED | 2 BATH | 2 CAR

PRICE:

\$335,000 Exceptional

OPEN FOR INSPECTION:

N/A



**Ian and Janelle Pye**

**0437778111**

ianpye@atrealty.com.au

[www.atrealty.com.au](http://www.atrealty.com.au)

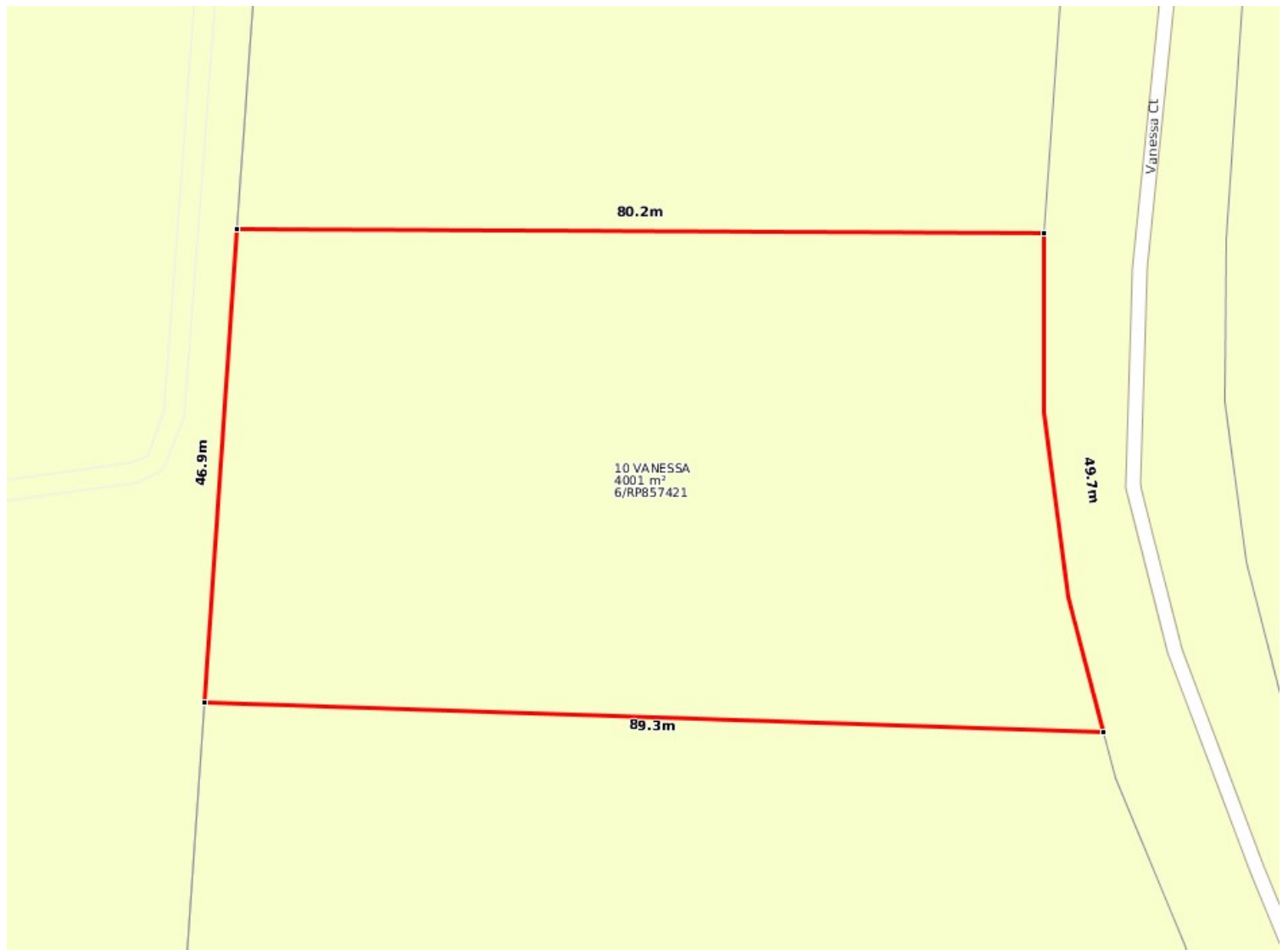

Disclaimer: Please note this floor plan is for marketing purposes and is to be used as a guide only. All dimensions are estimates only and may not be exact measurements.