

SOLD

SERENE LIVING WITH A BUSHLAND ASPECT

Presenting to the market this Contemporary four bedroom home situated on a generous 1250m2 with side access in the highly sought after Greenwoods Estate boasting a fabulous northern aspect overlooking the native reserve.

As you enter this architecturally designed, split level home you will fall in love with the cathedral ceilings and polished timber flooring throughout the open plan living area. The galley style kitchen invites those discussions around the hub of the home and makes entertaining a breeze with the gorgeous stackers doors flowing seamlessly out to the outdoor alfresco entertaining deck which is comfortable all day long whether it's a cup of tea in the morning or a glass of champagne in the afternoon, the view will never get old, you may even be lucky enough to spot a koala!

You will appreciate the four double sized bedrooms all with built in robes, new carpet and new split system air-conditioning. The spacious Master bedroom features a fully fitted out walk in robe, ensuite and takes in the bushland views.

The backyard is not to be overlooked, offering a ceramic fibreglass inground saltwater pool with infloor cleaning and a great level space for the kids or fur babies to play and run around. With two areas to relax around the pool you are spoilt for choice, the poolside gazebo would be my choice!

Underneath the house has been built in to form an amazing workshop/mancave space with power and a fabulous pool room/pool toy storage area.

There's a fabulous surprise feature which I won't mention here, ask me about it when you inspect! This home won't last long so don't delay call Natalie today on 0419 689 309 to arrange an inspection.

At a glance:
Fully Fenced 1250m2 Block
Quiet Cul-de-sac
Alfresco Deck overlooking the Reserve
Inground Saltwater Pool with Infloor Cleaning
Pool Gazebo

4 BED | 2 BATH | 2 CAR

PRICE:
\$792,000

OPEN FOR INSPECTION:
N/A



Natalie Johnston
0419689309
natalie@atrealty.com.au
[Natalieatrealty](#)

Whilst every attempt has been made to ensure the accuracy of the floor plan contained here, measurements of doors, windows rooms and any other items and structures are approximate and no responsibility is taken for any error, omission or mis-statement. Bathroom and kitchen fittings, cupboards and door types and laundry appliances and windows are tokens and approximate the actual fitting installed.
 This plan is for illustrative purposes and should be used as such by any prospective buyer.
 Plan drawn by Eagle Eye Photography Service, www.eagleeyeHQ.com.au Copyright 2019.
 All rights reserved.
 No reproduction without license, contact photographer for more information.

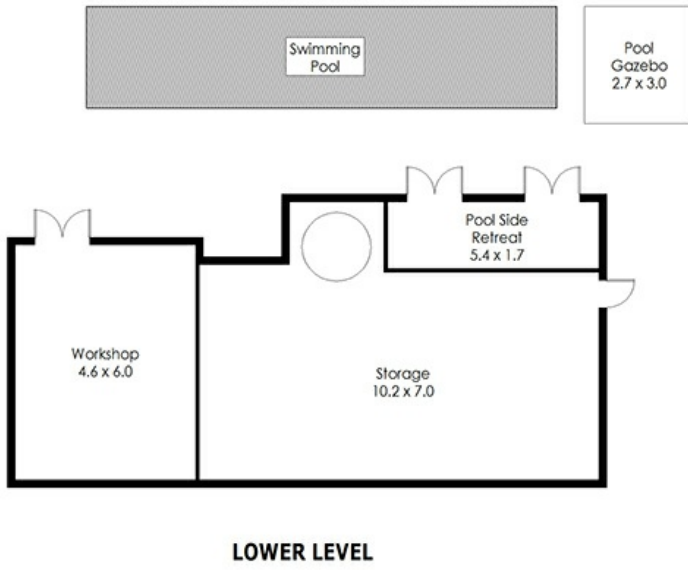

14 Grandis Court Cashmere 4500



Disclaimer: Please note this floor plan is for marketing purposes and is to be used as a guide only. All dimensions are estimates only and may not be exact measurements.

Natalie Johnston
 0419689309
 natalie@atrealty.com.au
[Natalieatrealty](https://www.atrealty.com.au)

